

13 12 11 10 9 8 7 6 5 4 3 2 1

NOTES:

1. MATERIAL:
CDA 510 PHOS. BRONZE .0080±.0004/(0.203±0.010) THICK.
2. FINISH:
 - *2 = SELECTIVE GOLD PLATE .000030/(0.00076) MIN., AND SELECTIVE MATTE TIN .000100/(0.00254) OVER .000050/(0.00127) MIN. NICKEL OVERALL.
 - *3 = SELECTIVE GOLD PLATE .000015/(0.00038) MIN., AND SELECTIVE MATTE TIN .000080/(0.00203) OVER .000050/(0.00127) MIN. NICKEL OVERALL.
 - *4 = SELECTIVE GOLD PLATE .000050/(0.00127) MIN., AND SELECTIVE MATTE TIN .000100/(0.00254) OVER .000050/(0.00127) MIN. NICKEL OVERALL.
- *THE PRIMARY SHIPPING CARTON WILL BE LABELED 'COMPLIANT TO RoHS DIRECTIVE 2002/95/EC AND ELV ANNEX II OF DIRECTIVE 2000/53/EC.' CARTONS WITHOUT THIS LABEL MAY CONTAIN PRODUCT WITH TIN-LEAD PLATING.
3. PRODUCT SPECIFICATION: SEE PSX-44485-0001.
4. PACKAGING SPECIFICATION: PK-44485-001 FOR CHAIN TERMINALS
PK-5556-003 FOR LOOSE TERMINALS
5. MATES WITH 5558, 5566 AND 5569 SERIES CONNECTORS.
6. TERMINAL FOR USE WITH 5557 SERIES HOUSINGS.

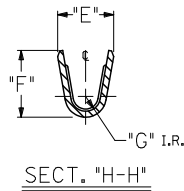
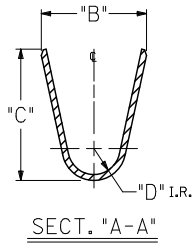
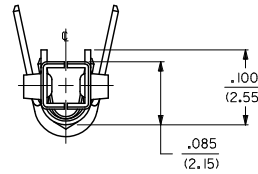
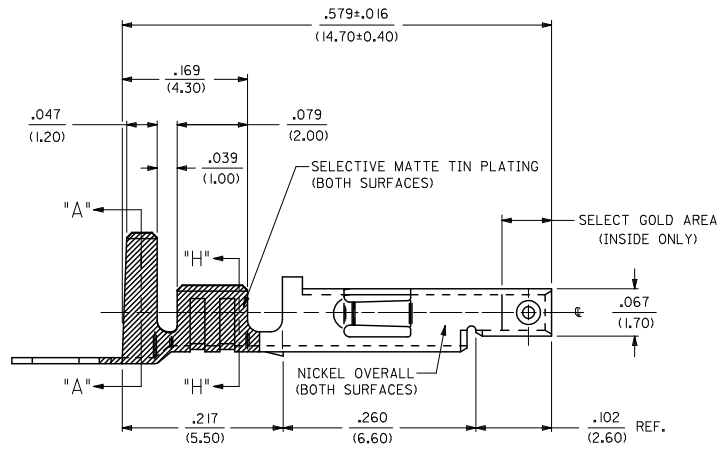
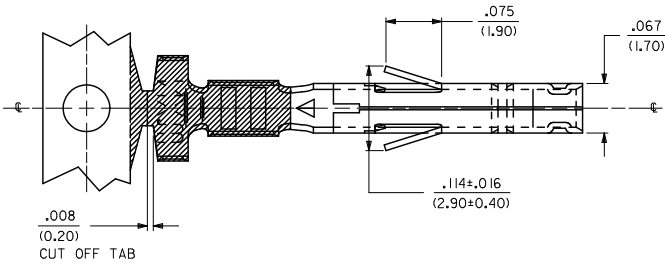

ADDED PKG. NOTE. EC NO: UCP200-0471 DRAWN: JAGUILAR 2009/12/23 CHKD: BELL 2009/12/23 APPR: SMITH 2009/12/28	QUALITY SYMBOLS ▽=0 ▽=0	GENERAL TOLERANCES (UNLESS SPECIFIED)		DIMENSION STYLE IN/MM		SCALE 10:1	DESIGN UNITS METRIC	THIRD ANGLE PROJECTION		
		4 PLACES ±.010 ±.010	3 PLACES ±.010 ±.010	2 PLACES ±.025 ±.014	1 PLACE ±.036 ±.014	ANGULAR ±1/2°	DRAWN BY GEP DATE 08/08/94	CHECKED BY RJF DATE 08/08/94	APPROVED BY RJF DATE 08/08/94	TITLE HIGH CYCL'G TERM FEM CRIMP, MINI-FIT JR. BLANK-PLATE-FORM
		DRAFT WHERE APPLICABLE MUST REMAIN WITHIN DIMENSIONS			SEE CHART		MATERIAL NO. SD-44485-***		DOCUMENT NO. SD-44485-***	
		SHEET NO. 1 OF 2		MOLEX INCORPORATED						

ITEM NO.	WIRE GAGE	DIM. "B"	DIM. "C"	DIM. "D"	DIM. "E"	DIM. "F"	DIM. "G"
44485-1211	18-24 GA.	.142±.012	.177±.016	.035	.075±.012	.091±.016	.020
44485-1212		(3.60±0.30)	(4.50±0.40)	(0.90)	(1.90±0.30)	(2.30±0.40)	(0.50)
44485-2211	22-28 GA.	.091±.012	.091±.016	.024	.071±.012	.065±.016	.016
44485-2212		(2.30±0.30)	(2.30±0.40)	(0.60)	(1.80±0.30)	(1.65±0.40)	(0.40)
44485-3211	16 GA.	.142±.012	.177±.016	.035	.091±.012	.106±.016	.024
44485-3212		(3.60±0.30)	(4.50±0.40)	(0.90)	(2.30±0.30)	(2.70±0.40)	(0.60)
44485-5211	28-30 GA.	.091±.012	.091±.016	.024	.050±.010	.044±.010	.010
44485-5212		(2.30±0.30)	(2.30±0.40)	(.60)	(1.27±0.25)	(1.12±0.25)	(0.25)
44485-1311	18-24 GA.	.142±.012	.177±.016	.035	.075±.012	.091±.016	.020
44485-1312		(3.60±0.30)	(4.50±0.40)	(0.90)	(1.90±0.30)	(2.30±0.40)	(0.50)
44485-2311	22-28 GA.	.091±.012	.091±.016	.024	.071±.012	.065±.016	.016
44485-2312		(2.30±0.30)	(2.30±0.40)	(0.60)	(1.80±0.30)	(1.65±0.40)	(0.40)
44485-3311	16 GA.	.142±.012	.177±.016	.035	.091±.012	.106±.016	.024
44485-3312		(3.60±0.30)	(4.50±0.40)	(0.90)	(2.30±0.30)	(2.70±0.40)	(0.60)
44485-5311	28-30 GA.	.091±.012	.091±.016	.024	.050±.010	.044±.010	.010
44485-5312		(2.30±0.30)	(2.30±0.40)	(.60)	(1.27±0.25)	(1.12±0.25)	(0.25)
44485-1411	18-24 GA.	.142±.012	.177±.016	.035	.075±.012	.091±.016	.020
44485-1412		(3.60±0.30)	(4.50±0.40)	(0.90)	(1.90±0.30)	(2.30±0.40)	(0.50)
44485-2411	22-28 GA.	.091±.012	.091±.016	.024	.071±.012	.065±.016	.016
44485-2412		(2.30±0.30)	(2.30±0.40)	(0.60)	(1.80±0.30)	(1.65±0.40)	(0.40)
44485-3411	16 GA.	.142±.012	.177±.016	.035	.091±.012	.106±.016	.024
44485-3412		(3.60±0.30)	(4.50±0.40)	(0.90)	(2.30±0.30)	(2.70±0.40)	(0.60)
44485-5411	28-30 GA.	.091±.012	.091±.016	.024	.050±.010	.044±.010	.010
44485-5412		(2.30±0.30)	(2.30±0.40)	(.60)	(1.27±0.25)	(1.12±0.25)	(0.25)

LEGEND:

44485 - * * * | *

BASE NO. _____

CRIMP SIZE _____

'1' = 18-24

'2' = 22-28

'3' = 16

'5' = 28-30

PLATING (SEE NOTE #2)

'2' .000030/0.00076 GOLD

'3' .000015/0.00038 GOLD

'4' .000050/0.00127 GOLD

CHAIN OR LOOSE _____

'1' = CHAIN

'2' = LOOSE

SEE SHEET ONE EC NO: UCP2010-0471 DRAWN: JAGUILAR 2009/12/23 CHKD: BELL 2009/12/23 APPR: SMITH 2009/12/28	QUALITY SYMBOLS	GENERAL TOLERANCES (UNLESS SPECIFIED)		DIMENSION STYLE IN/MM		SCALE ---	DESIGN UNITS INCH	THIRD ANGLE PROJECTION
	▽=0	4 PLACES	mm	INCH	DRAWN BY GEP	DATE 08/08/94	TITLE HIGH CYCL'G TERM FEM CRIMP, MINI-FIT JR. BLANK-PLATE-FORM	
	▽=0	3 PLACES			CHECKED BY RJF	DATE 08/08/94	MOLEX INCORPORATED	
		1 PLACE	ANGULAR ±1/2°		APPROVED BY RJF	DATE 08/08/94	MATERIAL NO. SD-44485-****	DOCUMENT NO.
DRAFT WHERE APPLICABLE MUST REMAIN WITHIN DIMENSIONS			SEE CHART			THIS DRAWING CONTAINS INFORMATION THAT IS PROPRIETARY TO MOLEX INCORPORATED AND SHOULD NOT BE USED WITHOUT WRITTEN PERMISSION		

13	12	11	10	9	8	7	6	5	4	3	2	1
----	----	----	----	---	---	---	---	---	---	---	---	---

tb_frame_C.P.M.E.T
Rev. D. 2004/04/02