

Series image - Reference only

EU RoHS ELV and RoHS Compliant	China RoHS
-----------------------------------	------------

Search Parts in this Series

19215 Series

Application Tooling

Global

Description	Product #
Crimp Head for the AT-200™ Pneumatic Hand Tool	<u>0640074400</u>
Putt Pump Dieless Head System	<u>0192860065</u>
Manual Putt Pump Hydraulic System with Dies	<u>0192860117</u>
Die Set (large) for the HHLS Hydraulic Crimper	<u>0192900001</u>
Hand Crimp Tool	<u>0640013900</u>

Part Number: 0192150037

Status: Active

Description: Step Down Butt Splice for 8-12 AWG Wire

Documents:

- [Drawing \(PDF\)](#)
- [Related Catalog Page \(PDF\)](#)

Order Products:

[Check Distributor Inventory](#)

Part Detail: (show all)○ **General**○ **Physical**○ **Electrical**○ **Material Info**○ **Reference - Drawing Numbers****General**

Product Family	Splices
Series	19215
Comments	Step down: 8 to 10/12 AWG
Mil-Spec	N/A
Product Name	Butt - Step Down

Physical

Barrel Type	Closed
Insulation	None
Packaging Type	Box
Temperature Range - Operating	149°C
Wire Insulation Diameter	N/A
Wire Size AWG	10
Wire Size AWG	2
Wire Size AWG	8
Wire Size mm ²	N/A

Electrical

CSA	LR18689
UL	E32244

Material Info

Old Part Number	DC-354
-----------------	--------

Reference - Drawing Numbers

Sales Drawing	SD-19215-004
---------------	--------------

MATERIAL NUMBER	ENG. NUMBER	CODE STRIPE COLOR	"A"		"B"		"C" MAX.	"L" MAX.	CMA RANGE	
			AWG.	MIN. DIA.	AWG.	MIN. DIA.			LARGE I.D. TO	SMALL I.D.
I92 I500 I3	BA-33 I	RED	22-18	.073(1.85)	16-14	.090(2.29)	.160/4.06	.675/17.15	2050-5180 TO 509-2600	
I92 I50023	CB-346	BLUE	16-14	.099(2.51)	12-10	.216(5.49)	.223/5.66	.827/21.0	5180-13,100 TO 2050-5180	
I92 I50037	DC-354	YELLOW	12-10	.141(3.58)	#8	.174(4.42)	.291/7.39	.854/21.69	13,100-20,800 TO 5180-13,100	
I92 I50042	ED-362	RED	#8	.184(4.67)	#6	.239(6.07)	.375/9.53	1.045/26.54	20,800-33,100 TO 13,100-20800	
I92 I50209	HC-372	N/A	#2	.366(9.30)	1/0	.448(11.38)	.530/13.46	1.370/34.80	106,000 TO 66,400	

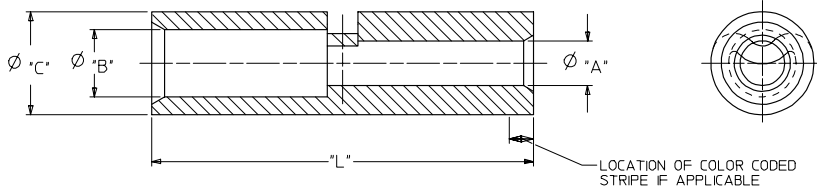

LOCATION OF COLOR CODED STRIPE IF APPLICABLE

SALES DRAWING

- NOTES:
- MATERIAL: COPPER
FINISH: ELECTRO-TIN
 - DOES NOT HAVE COLOR CODED STRIPE.
 - PART IS ROHS COMPLIANT.

ADDED ROHS NOTE EC NO: ETC2007-0261 DRAWN BY: DRW:HEHLE 2007/02/19 CHKD: JMCNEIL 2007/02/19 APPR: JMCNEIL 2007/02/19	QUALITY SYMBOLS $\nabla=0$ $\sphericalangle=0$	GENERAL TOLERANCES (UNLESS SPECIFIED)		DIMENSION STYLE	SCALE	DESIGN UNITS	THIRD ANGLE PROJECTION	
				IN/MM	5:1	INCH		
				mm	INCH	DRAWN BY	DATE	TITLE
				4 PLACES ± --- ± ---	3 PLACES ± --- ± ---	RMARSHALL	91/10/28	STEP DOWN BUTT CONNECTOR VERSAKRIMP
		2 PLACES ± --- ± ---	1 PLACE ± --- ± ---	CHECKED BY	DATE			
		ANGULAR ±1/2°		RDROSS	91/10/28	MOLEX INCORPORATED		
		DRAFT WHERE APPLICABLE MUST REMAIN WITHIN DIMENSIONS		APPROVED BY	DATE			
				RDROSS	91/10/28			
				MATERIAL NO.	DOCUMENT NO.			
				SEE CHART	SD-19215-004			
				SIZE B	THIS DRAWING CONTAINS INFORMATION THAT IS PROPRIETARY TO MOLEX INCORPORATED AND SHOULD NOT BE USED WITHOUT WRITTEN PERMISSION			