



Copyright FCI



FCIconnect.com

1 | 2

3 |

4

PRODUCT NUMBER
20020618-MXXXXXXLF

20020618-□ □ □ □ △ ○ □ L F

PITCH
M: 7.62 mm

POLES
02: 2 POLES
03: 3 POLES
04: 4 POLES

16: 16 POLES

LF : DENOTED RoHS COMPATIBLE

1 : STANDARD PRODUCT
W/ BOX PACKING

HOUSING CODE

CODE	COLOR	AVAILABILITY
1	GREEN(RAL 6018/T)	STANDARD
2	BLACK	ON REQUEST ONLY
3	GREY(RAL 7004/P)	ON REQUEST ONLY
4	BLUE(RAL 5015/A)	ON REQUEST ONLY

PROPERTY TABLE	
FCI SERIES NAME	07-762
PITCH (mm)	7.62
VOLTAGE RATING (VAC)	300
CURRENT RATING (A)	32
WITHSTANDING VOLTAGE (kV)	1.6
OPERATING TEMP. (°C)	-40~+115
SOLDERING TEMP. (°C)	250±10 (5 sec.)
POLES AVAILABLE	02~16
SAFETY CERTIFICATE	

NOTES:

MATERIALS

- 1-1 HOUSING: THERMALPLASTIC RESIN, UL 94V-0 RATED.
- 1-2 TERMINAL: COPPER ALLOY, TIN PLATED.
- 2. PRODUCTION SPECIFICATION REFER TO FCI GS-12-625.
- 3. BOXED PACKAGING.
- DETAILED PRODUCT PACKING SPECIFICATION REFER TO FCI GS-14-1394.
- 4. FCI, SAFETY CERTIFICATE LOGO AND SERIES NAME TO BE SHOWN ON PRODUCT SURFACE.
- 5. THE PRODUCTS WHERE THE PART NUMBER END IN "LF" MEET THE EUROPEAN UNION DIRECTIVE AND OTHER COUNTRY REGULATIONS AS DESCRIBED IN GS-22-008.
- 6. RECOMMENDED SOLDERING PROCESS BY WAVE SOLDER.

mat'l. code	surface ASME Y14.5	tolerance ASME Y14.5	projection	product family	
ltr	ecn no	dr	date	TERMINAL BLOCK	
A	0609-0203	BF	062509	title	
B	T09-1148	BF	111709	TERMINAL BLOCK	
C	T10-0042	WL	030310	PLUGGABLE SOCKET, RIGHT ANGLE	
D	T10-0159	WL	100410	dr	
E	T10-0187	WL	121410	engr	
		chr	GARY HSIEH	062509	
		appd	JOSEPH HSIA	062509	
sheet index	revision sheet	E	E	1	2

form: A4mmXLc

1 |

2 |

PDM: Rev:E 3 | STATUS:Released Printed: Dec 22, 2010 4

Copyright FCI

FCI
FCIconnect.com

1 | 2

3

4

PRODUCT NUMBER	SERIES NAME	PITCH
20020618-MXXXXXXLF	07-762	7.62 mm

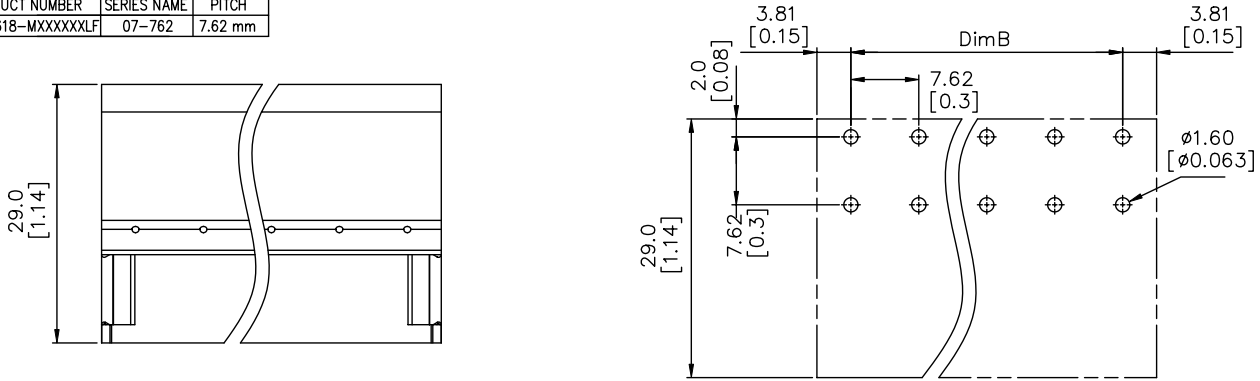

P.C.B LAYOUT

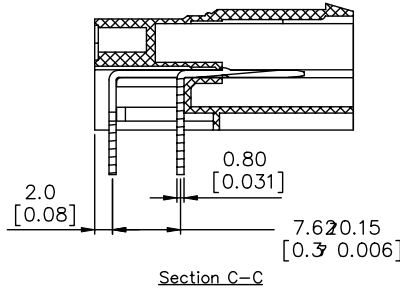
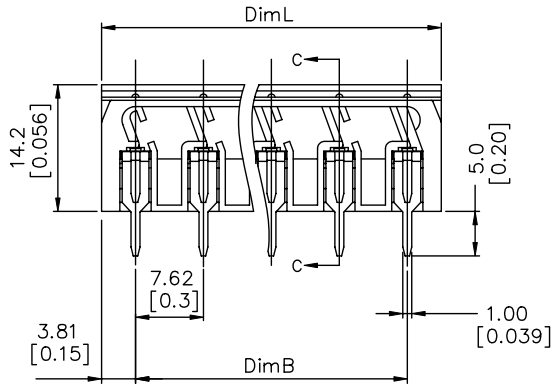

Section C-C

N = Number of poles
 Dim L = $N \times 7.62 [0.300]$
 Dim B = $(N-1) \times 7.62 [0.300]$

TOL.	Dim L	Dim B
2-5p	$\pm 0.20 [0.008]$	
6-10p	$\pm 0.30 [0.012]$	
11-13p	$\pm 0.35 [0.014]$	
14-16p	$\pm 0.40 [0.016]$	

mat'l. code	surface ASME Y14.5	tolerance ASME Y14.5	projection	product family
ltr	ecn	no	dr	date
E				
tolerances unless otherwise specified				title
angles	MM	[INCH]	scale	TERMINAL BLOCK
X \pm 1°	X. \pm 0.5	X.X \pm 0.3	X.XX \pm 0.1	TERMINAL BLOCK PLUGGABLE SOCKET, RIGHT ANGLE
dr	BEER FU	062509	FCI	dwg no
enr	BEER FU	062509		sheet 2 of 2
chr	GARY HSIEH	062509		20020618
appd	JOSEPH HSIA	062509		A4
sheet index	revision sheet			type
				CUSTOMER Drawing

form: A4mmXLc

1

2

PDM: Rev: E 3 | STATUS: Released | Printed: Dec 22, 2010 4