

THIS DRAWING IS UNPUBLISHED. RELEASED FOR PUBLICATION
 COPYRIGHT ALL RIGHTS RESERVED.

LOC	DIST	REVISIONS			
P	LTR	DESCRIPTION	DATE	DWN	APVD
		AB6 REVISED PER ECO-11-005140	01APR11	RK	HMR

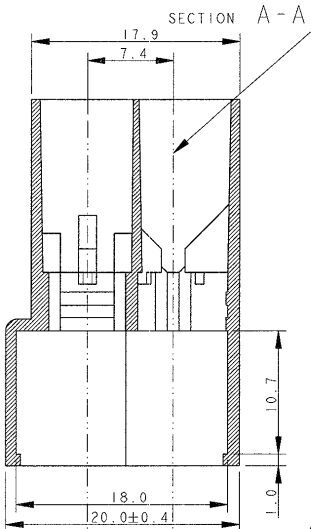

TYPICAL CAVITY FOR FASTIN-FASTON CONN. .250" SR. TAB CTC

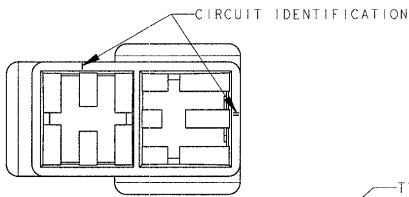
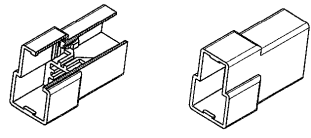
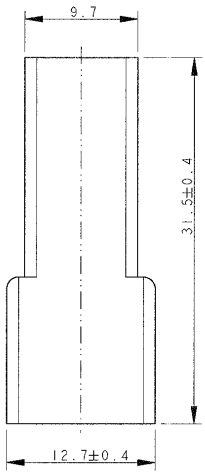

SCALE 1:1

2 OBSOLETE PARTS: OBSOLETE CIS STREAMLINING PER D.RENAUD/D.SINISI

2 OBSOLETE

OBSOLETE

NOTES	COLOUR	MATERIAL	PART NUMBER	REV
	BLACK	POLYAMIDE 6.6	0-180908-5	AB
	YELLOW		0-180908-4	AB
	BLUE		0-180908-3	AB
	GREEN		0-180908-2	AB
	RED		0-180908-1	AB
	NATURAL	NYLON 606 ZYTEL 101L	1-180908-0	AB
	BLACK		1-180908-5	O
UL APPROVED	YELLOW		1-180908-4	AB
	GREEN		1-180908-2	AB
	NATURAL		1-180908-0	AB

1 ALTERNATIVE SHAPE :
ACCEPTED ONE RETENTION RIB FOR THE TOTAL LENGTH OF THE HSG.

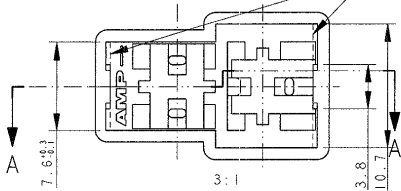

DIMENSIONS: mm		DWN H. YAALI 08JUL2002		TE Connectivity	
TOLERANCES UNLESS OTHERWISE SPECIFIED:		CHK C. TARTARI			
0 PLC ± 1 PLC ±0.3 2 PLC ± 3 PLC ± 4 PLC ± ANGLES ±°		PRODUCT SPEC 108-20020 APPLICATION SPEC WEIGHT 2.3 g		FASTIN-FASTON* Connector, .250" sr. TAB HOUSING 2 WAY	
MATERIAL SEE TAB. E		FINISH SEE TAB. E		SIZE A3	CAGE CODE 00779
CUSTOMER DRAWING				DRAWING NO. 180908	RESTRICTED TO -
				SCALE 3:1	SHEET 1 OF 1 REV AB6