

| PRODUCT NUMBER | POS. | DIM A | DIM B | EQUIVALENT HIGH-TEMP P/N |
|----------------|------|-------------|-------------|--------------------------|
| 69307-004LF | 4 | 2.01/.079 | 4.39/.173 | 10087008-004LF |
| 69307-006LF | 6 | 3.99/.157 | 6.40/.252 | 10087008-006LF |
| 69307-008LF | 8 | 5.99/.236 | 8.41/.331 | 10087008-008LF |
| 69307-010LF | 10 | 8.00/.315 | 10.39/.409 | 10087008-010LF |
| 69307-012LF | 12 | 10.00/.394 | 12.40/.488 | 10087008-012LF |
| 69307-014LF | 14 | 11.99/.472 | 14.40/.567 | 10087008-014LF |
| 69307-016LF | 16 | 14.00/.551 | 16.41/.646 | 10087008-016LF |
| 69307-018LF | 18 | 16.00/.630 | 18.39/.724 | 10087008-018LF |
| 69307-020LF | 20 | 18.01/.709 | 20.40/.803 | 10087008-020LF |
| 69307-022LF | 22 | 19.99/.787 | 22.40/.882 | 10087008-022LF |
| 69307-024LF | 24 | 22.00/.866 | 24.41/.961 | 10087008-024LF |
| 69307-026LF | 26 | 24.00/.945 | 26.39/1.039 | 10087008-026LF |
| 69307-028LF | 28 | 26.01/1.024 | 28.40/1.118 | 10087008-028LF |
| 69307-030LF | 30 | 27.99/1.102 | 30.40/1.197 | 10087008-030LF |
| 69307-032LF | 32 | 30.00/1.181 | 32.41/1.276 | 10087008-032LF |
| 69307-034LF | 34 | 32.00/1.260 | 34.40/1.354 | 10087008-034LF |
| 69307-036LF | 36 | 34.01/1.339 | 36.40/1.433 | 10087008-036LF |
| 69307-038LF | 38 | 35.99/1.417 | 38.40/1.512 | 10087008-038LF |
| 69307-040LF | 40 | 38.00/1.496 | 40.41/1.591 | 10087008-040LF |
| 69307-042LF | 42 | 40.01/1.575 | 42.39/1.669 | 10087008-042LF |
| 69307-044LF | 44 | 42.01/1.654 | 44.40/1.748 | 10087008-044LF |
| 69307-046LF | 46 | 43.99/1.732 | 46.41/1.827 | 10087008-046LF |
| 69307-048LF | 48 | 46.00/1.811 | 48.41/1.906 | 10087008-048LF |
| 69307-050LF | 50 | 48.01/1.890 | 50.39/1.984 | 10087008-050LF |

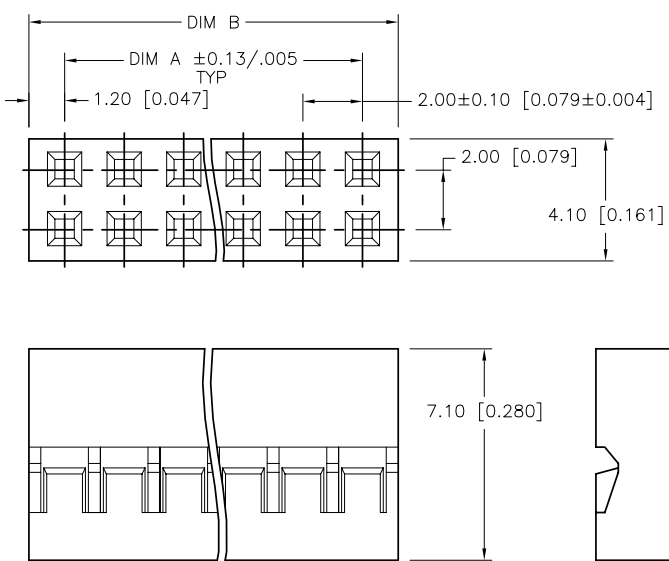

NOTES:

- MATERIAL: UNFILLED FLAME RETARDANT NYLON, FLAME RETARDANT PER UL94V-0, COLOR: BLACK.
- GENERAL TOLERANCE : ±0.25/.010
- PRODUCT MEETS EUROPEAN UNION DIRECTIVES AND OTHER COUNTRY REGULATIONS AS DESCRIBED IN GS-22-008.
- THE PRODUCT IS NOT INTENDED TO BE EXPOSED TO MANUFACTURING SOLDER PROCESSES.

| | | | | | |
|-------------|----------------|---------|------------|---------------------------------------|---|
| mat'l code | SEE NOTE 1 | surface | tolerance | projection | product family |
| lir | ecm no | dr | date | tolerances unless otherwise specified | MINITEK HOUSINGS |
| J | v91487 | EPK | 1999-11-09 | angles | title |
| K | v05-0733 | DAI | 2005-08-06 | linear | MINITEK C.T.W. RECEPTACLE HOUSING, DOUBLE ROW |
| L | v06-0516 | HTB | 2006-06-06 | 0°±2° | scale 5:1 |
| M | v07-0266 | HTB | 2007-04-02 | dr | E. KROPIEWNICKI |
| N | v08-0143 | HTB | 2008-03-25 | engr | L. GREEN |
| P | v08-0392 | HTB | 2008-09-12 | chr | L. GREEN |
| | | | | appd | L. GREEN |
| sheet index | revision sheet | P | 1 | | dwg no 69307 sheet 1 of 1 size A3 |
| | | | | | type Product Customer Drawing |