

**Part Number:** [0016020103](#)  
**Status:** **Active**  
**Overview:** [SL](#)  
**Description:** SL™ Crimp Terminal 70058, 22-24 AWG, Bag Selective Gold (Au)

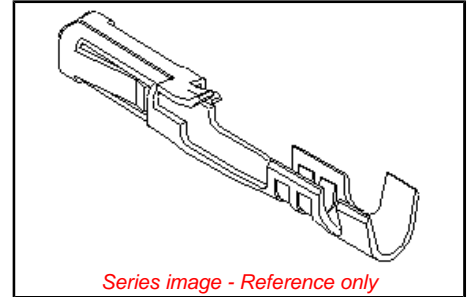

**General**

|                |                 |
|----------------|-----------------|
| Product Family | Crimp Terminals |
| Series         | 70058           |
| Overview       | SL              |
| Product Name   | SL™             |

**Physical**

|                                |                      |
|--------------------------------|----------------------|
| Gender                         | Female               |
| Material - Metal               | Phosphor Bronze      |
| Material - Plating Mating      | Gold                 |
| Material - Plating Termination | Tin                  |
| Packaging Type                 | Bag                  |
| Plating min: Mating (µin)      | 15                   |
| Plating min: Mating (µm)       | 0.375                |
| Plating min: Termination (µin) | 75                   |
| Plating min: Termination (µm)  | 1.875                |
| Termination Interface: Style   | Crimp or Compression |
| Wire Insulation Diameter       | 1.63mm (.064") max.  |
| Wire Size AWG                  | 22                   |
| Wire Size AWG                  | 24                   |
| Wire Size mm²                  | N/A                  |

**Material Info**

|                 |            |
|-----------------|------------|
| Old Part Number | 70058-0224 |
|-----------------|------------|

**EU RoHS**  
**ELV and RoHS**  
**Compliant**

**China RoHS**



**NOTES:**

1. TERMINAL TO BE USED IN HOUSINGS 70066-\*\*\*\* AND 70450-\*\*\*\*
2. REFER TO PRODUCT SPECIFICATION PS-70058
3. REFER TO MOLEX OPERATIONS AND SERVICE MANUAL FOR CRIMP DETAILS
4. TERMINAL TO BE USED WITH (0.64)/.025 SQUARE PINS
5. TERMINAL TO BE USED WITH 22-24 AWG STRANDED WIRE WITH (1.63)/.064 MAX. DIA. INSULATION
6. TERMINALS SUPPLIED LOOSE PER DRAWING PK-70873-0822

\*THE PRIMARY SHIPPING CARTON WILL BE LABELED \*COMPLIANT TO RoHS DIRECTIVE 2002/95/EC AND ELV ANNEX II OF DIRECTIVE 2000/53/EC\*. CARTONS WITHOUT THIS LABEL MAY CONTAIN PRODUCT WITH LEAD.

**PLATING:**

.000015 MIN. GOLD PLATE IN SELECT AREA,  
.000075 MIN. TIN PLATE IN SELECT AREA,  
OVER NICKEL PLATE OVERALL.

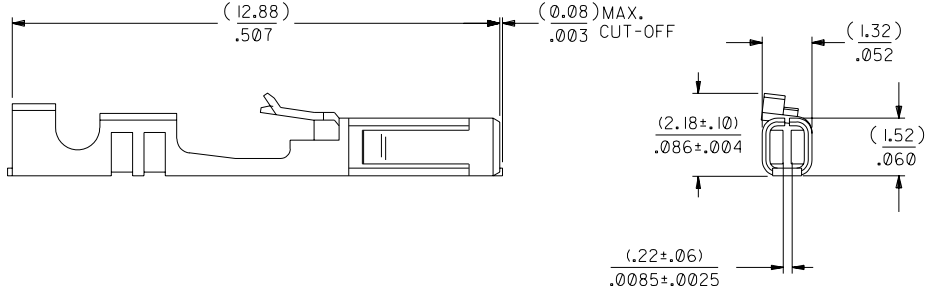
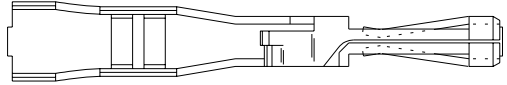

|      |  |      |  |  |  |  |  |  |
|------|--|------|--|--|--|--|--|--|
|      |  | CI   |  | REVISED PER ECR #U70928 MCGRATH 97/06/26 | DIMENSIONS SHOWN (METRIC) INCH UNLESS OTHERWISE SPECIFIED TOLERANCES: ANGULAR ± 1/2° |  | ▽ = 0 ▼ = 0 REVISE ONLY ON CAD SYSTEM  |  |
| D    |  | C    |  | LEAD FREE UCP2004-1769 RWHITE 04/03/11   | INCH METRIC  |  | TITLE  |  |
| C2   |  | B    |  | REVISED ECR #U80270 MCGRATH 97/07/31     | 3 PLACE ± .005 ---   |  | TERMINAL - BOX/CRIMP   |  |
| LTR. |  | LTR. |  | REVISIONS                                | 2 PLACE ± .01 ± 0.13   |  | MOLEX INCORPORATED SHEET NO. DATE  |  |
|      |  |      |  | REVISIONS                                | 1 PLACE --- ± 0.25   |  | LITSE,ILL. 60932 U.S.A. 1 OF 1 03/02/88  |  |
|      |  |      |  |  | DRAFT WHERE APPLICABLE MUST REMAIN WITHIN DIMENSIONS                                 |  | PART NO. DRWG. NO.   |  |
|      |  |      |  |  | DRWG. BY JAS CHK'D. BY   |  | 016-02-0103 SD-70058-0224  |  |
|      |  |      |  |  | APP'D. BY SCALE 10:1   |  | FILE NAME DIV. SIZE  |  |
|      |  |      |  |  |  |  | 570058C6 DGN THIS DRAWING CONTAINS INFORMATION THAT IS PROPRIETARY TO MOLEX INC. AND SHOULD NOT BE USED WITHOUT WRITTEN PERMISSION. DA B |  |

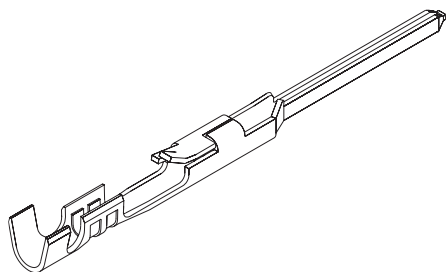
**2.54mm (.100") Pitch****SL™****Terminal****70021****Male, Crimp****Features and Benefits**

- Dual tab strain relief
- Locking tang secures terminal in housing

**Reference Information**

Product Specification: PS-70021  
 Packaging: Reel or bag  
 Mates With: 70058 and 71851 female crimp terminals,  
 and 70400 and 70430 connector assemblies  
 Use With: 70066D and 70107 housings  
 Designed In: Inches

**Electrical**

Voltage: 250V  
 Current: 3.0A  
 Contact Resistance: 15 milliohms max.  
 Insulation Resistance: 10,000 Megohms min.

**Mechanical**

Wire Pull-Out Force: 17.79N (4.0 lb) min.  
 Durability: Tin—25 cycles; Gold—50 cycles

**Physical**

Contact: Copper Alloy  
 Plating: See Table  
 Operating Temperature: -40 to +105°C  
 Wire Gauge: 22 to 24 and 24 to 30 AWG

**Not For Use With C-Grid III™ Components**

| Reel                       |         |                           |                                     |           |
|----------------------------|---------|---------------------------|-------------------------------------|-----------|
| Order No.                  | Plating | Wire Range (AWG) Stranded | Insulation Maximum Outside Diameter | Lead-free |
| <a href="#">16-02-0116</a> | 1       | 22-24                     | 1.63 (.064)                         | Yes       |
| <a href="#">16-02-0078</a> |         | 24-30                     | 1.52 (.060)                         |           |
| <a href="#">16-02-0081</a> | 2       | 22-24                     | 1.63 (.064)                         |           |
| <a href="#">16-02-0077</a> |         | 24-30                     | 1.52 (.060)                         |           |
| <a href="#">16-02-0107</a> | 3       | 22-24                     | 1.63 (.064)                         |           |
| <a href="#">16-02-0105</a> |         | 24-30                     | 1.52 (.060)                         |           |

| Bag                        |         |                           |                                     |           |
|----------------------------|---------|---------------------------|-------------------------------------|-----------|
| Order No.                  | Plating | Wire Range (AWG) Stranded | Insulation Maximum Outside Diameter | Lead-free |
| <a href="#">16-02-0117</a> | 1       | 22-24                     | 1.63 (.064)                         | Yes       |
| <a href="#">16-02-0110</a> |         | 24-30                     | 1.52 (.060)                         |           |
| <a href="#">16-02-0115</a> | 2       | 22-24                     | 1.63 (.064)                         |           |
| <a href="#">16-02-0109</a> |         | 24-30                     | 1.52 (.060)                         |           |
| <a href="#">16-02-0114</a> | 3       | 22-24                     | 1.63 (.064)                         |           |
| <a href="#">16-02-0108</a> |         | 24-30                     | 1.52 (.060)                         |           |

Plating No. 1: 30µm min. Gold in select area over 50µm min. Nickel overall with 75µm Tin in select area  
 Plating No. 2: 15µm min. Gold in select area over 50µm min. Nickel overall with 75µm Tin in select area  
 Plating No. 3: 150µm Tin over 50µm Nickel overall  
 Each reel contains 20,000 terminals

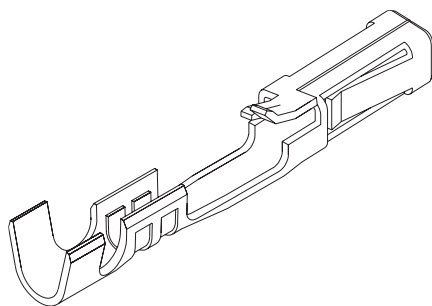
**2.54mm (.100") Pitch****SL™****Terminal****70058****Female Box, Crimp****Features and Benefits**

- Dual beam, fully-enclosed box contact
- Dual tab strain relief
- Locking tang secures terminal in housing

**Reference Information**

Product Specification: PS-70058  
 Packaging: Reel or bag  
 Mates With: 70021 male crimp terminals and  
 0.64mm (.025") square pins  
 Use With: All 70066 and 70450 housings  
 Designed In: Inches

**Electrical**

Voltage 250V  
 Current: 3.0A  
 Contact Resistance: 15 milliohms max.  
 Insulation Resistance: 10,000 Megohms min.

**Mechanical**

Contact Retention to Housing: 17.79N (4.0 lb) min.  
 Wire Pull-Out Force: 17.79N (4.0 lb) min.  
 Mating Force: 2.22N (.50 lb) max.  
 Unmating Force: 0.28N (.06 lb) min.  
 Normal Force: 0.98N (.22 lb) min.  
 Durability: Tin—25 cycles; Gold—50 cycles

**Physical**

Contact: Copper Alloy  
 Plating: See Table  
 Operating Temperature: -40 to +105°C  
 Wire Gauge: 22 to 24 and 24 to 30 AWG

**Not For Use With C-Grid III™ Components**

| Reel                       |         |                           |                                     |           |
|----------------------------|---------|---------------------------|-------------------------------------|-----------|
| Order No.                  | Plating | Wire Range (AWG) Stranded | Insulation Maximum Outside Diameter | Lead-free |
| <a href="#">16-02-0088</a> | 1       | 22-24                     | 1.63 (.064)                         | Yes       |
| <a href="#">16-02-0083</a> |         | 24-30                     | 1.52 (.060)                         |           |
| <a href="#">16-02-0087</a> | 2       | 22-24                     | 1.63 (.064)                         |           |
| <a href="#">16-02-0082</a> |         | 24-30                     | 1.52 (.060)                         |           |
| <a href="#">16-02-0086</a> | 3       | 22-24                     | 1.63 (.064)                         |           |
| <a href="#">16-02-0069</a> |         | 24-30                     | 1.52 (.060)                         |           |

| Bag                        |         |                           |                                     |           |
|----------------------------|---------|---------------------------|-------------------------------------|-----------|
| Order No.                  | Plating | Wire Range (AWG) Stranded | Insulation Maximum Outside Diameter | Lead-free |
| <a href="#">16-02-0104</a> | 1       | 22-24                     | 1.63 (.064)                         | Yes       |
| <a href="#">16-02-0098</a> |         | 24-30                     | 1.52 (.060)                         |           |
| <a href="#">16-02-0103</a> | 2       | 22-24                     | 1.63 (.064)                         |           |
| <a href="#">16-02-0097</a> |         | 24-30                     | 1.52 (.060)                         |           |
| <a href="#">16-02-0102</a> | 3       | 22-24                     | 1.63 (.064)                         |           |
| <a href="#">16-02-0096</a> |         | 24-30                     | 1.52 (.060)                         |           |

Plating No. 1: 30µm min. Gold in select area over 50µm min. Nickel overall with 75µm Tin in select area  
 Plating No. 2: 15µm min. Gold in select area over 50µm min. Nickel overall with 75µm Tin in select area  
 Plating No. 3: 150µm Tin over 50µm Nickel overall  
 Each reel contains 20,000 terminals

C-6 MX07

