

13 12 11 10 9 8 7 6 1625-9 4 3 2 1

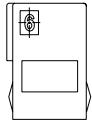

OPTIONAL MOUNTING EARS
SEE DETAIL 3 OR 4
FOR VERSIONS AVAILABLE

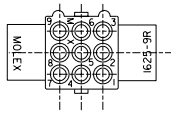
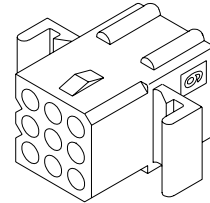
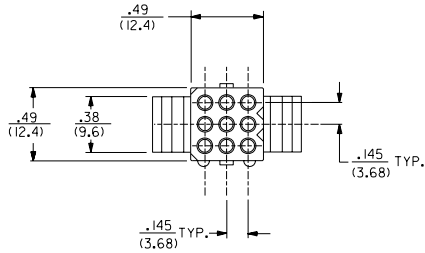
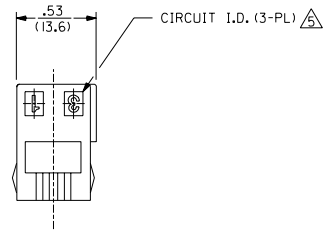
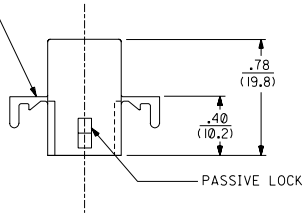

RECEPTACLE

		DIMENSIONS SHOWN (METRIC) INCH		REVISIONS		REVISIONS	
		UNLESS OTHERWISE SPECIFIED TOLERANCES ANGULAR ± 1/2°		O SEE SHEET I		O SEE SHEET I	
		INCH METRIC		OI SEE SHEET I		N SEE SHEET I	
		3 PLACE ± .010 ---		L SEE SHEET I		LTR. REVISIONS LTR. REVISIONS	
		2 PLACE ± .014 ± 0.25					
		1 PLACE --- ± 0.36					
		DRAFT WHERE APPLICABLE MUST REMAIN WITHIN DIMENSIONS					
		ORG. BY JJS DWG. BY RW					
		APP'D. RAS SCALE 2:1					
		FILE NAME S16259R2					
		NO. DRAWING CONTAINS INFORMATION THAT IS PROPRIETARY TO MOLEX INC. AND SHOULD NOT BE USED WITHOUT WRITTEN PERMISSION.					
		MOLEX INCORPORATED U.S.A.					
		PART NO. SD-1625-9					
		SEE CHART					
		SHEET NO. 2					
		DATE 2 / 5 / 88					
		CP C					

13 12 11 10 9 8 7 6 5 4 3 2 1

PLUG		
PART NO.	ENG. NO.	
03-06-2091	1625-9P	
03-06-2092	1625-9P I	
23-06-2091	1625-9P I-C	
23-06-2092	1625-9P I-C	
04-06-6091	1625-9P I-B	
03-06-7091	1625-9PBK	OBSOLETE
03-06-7092	1625-9P IBK	OBSOLETE

RECEPTACLE		
PART NO.	ENG. NO.	
03-06-1091	1625-9R	
03-06-1092	1625-9R I	
23-06-1091	1625-9R-C	
23-06-1092	1625-9R I-C	
03-06-6091	1625-9RBK	OBSOLETE
03-06-6092	1625-9R IBK	

LEGEND:

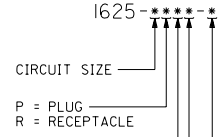

MOUNTING EAR & DETENT COMBINATIONS:
 BLANK=PLUG OR RECEPTACLE WITH STANDARD EARS
 I=PLUG OR RECEPTACLE WITHOUT EARS
 4=PLUG OR RECEPTACLE WITH PREBENT EARS

BLANK = NATURAL COLOR
 AM = AMBER BK = BLACK BU = BLUE
 BN = BROWN GY = GRAY GN = GREEN
 OR = ORANGE RD = RED YW = YELLOW

MATERIAL: A= MATERIAL CODE A
 B= MATERIAL CODE B
 C= MATERIAL CODE C

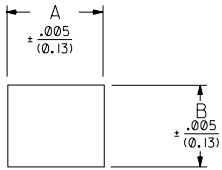
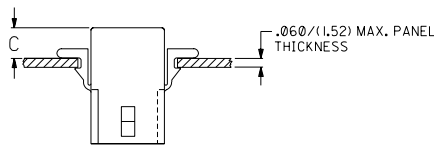

RECEP.	.650 (16.51)	.552 (14.02)	.21 (5.3)	.22 (5.6)
PLUG	.752 (19.10)	.615 (15.62)	.20 (5.1)	.21 (5.3)
PART	DIM. A	DIM. B	DIM. C (STANDARD EAR)	DIM. C (PREBENT EAR)

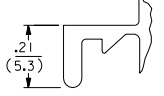

DETAIL 3
STANDARD MOUNTING EAR
(SCALE 4:1)

RECOMMENDED HOLE PATTERN

- NOTES:
- MATERIAL CODES:
 A-NYLON TYPE 6/6, 94V-2
 B-NYLON TYPE 6/6, 94V-0
 C-POLYPROPYLENE, 94V-0
 - THIS PRODUCT COMPLIES WITH MOLEX PRODUCT SPEC PS-02-06.
 - HOUSINGS FOR USE WITH MOLEX .062 DIA. TERMINALS.
- ⚠️ SOME PARTS MAY HAVE THIS CORNER CHAMFERED.
- ⚠️ CIRCUIT I.D. NUMBERS APPEAR ONLY ON TOOLS BUILT AFTER 11/1/92.

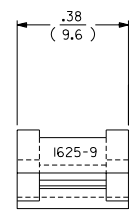

DETAIL 4
PREBENT MOUNTING EAR
(SCALE 4:1)

O SEE SHEET I		DIMENSIONS SHOWN IN METRIC INCH		▽ = 0 ▽ = 0 REVISE ONLY ON CAD SYSTEM	
P SEE SHT. I	SEE SHEET I	UNLESS OTHERWISE SPECIFIED TOLERANCES: ANGULAR ± .04° (1°)		TITLE	
OI SEE SHT. I	SEE SHEET I	INCH METRIC		.062/(1.57) HOUSINGS	
O SEE SHT. I	SEE SHEET I	3 PLACE ± .010 ---		PLUG & RECEPTACLE	
N SEE SHT. I	SEE SHEET I	2 PLACE ± .014 ± 0.25		9 CIRCUIT, 145/(3.68)CTRS	
M SEE SHT. I	SEE SHEET I	1 PLACE --- ± 0.36		MOLEX INCORPORATED SHEET NO. DATE	
L SEE SHT. I	SEE SHEET I	DRAFT WHERE APPLICABLE MUST REMAIN WITHIN DIMENSIONS		U.S.A. 3 2 / 12 / 88	
LTR. REVISIONS	LTR. REVISIONS	DRG. BY JJS	CHK'D. BY RW	PART NO. SD-1625-9	
		APP'D. BY RAS	SCALE 2 : 1	DRG. NO. 68532	
				NO DRAWING CONTAINS INFORMATION THAT IS PROPRIETARY TO MOLEX INC. AND SHOULD NOT BE USED WITHOUT WRITTEN PERMISSION. CP IC	