

REV	DATE	DESCRIPTION	BY	CHK	APP
00	ES	REVISED PER ECO-11-005033			

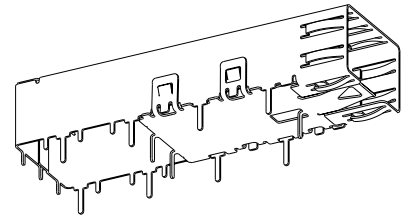
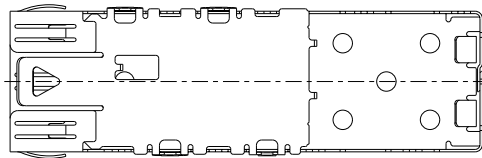
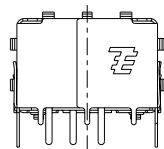
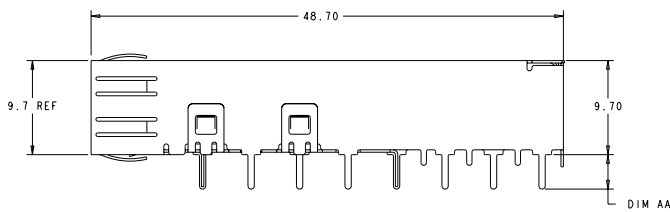
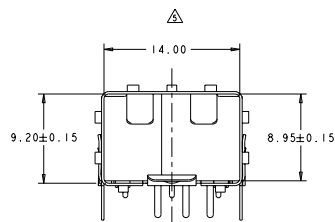
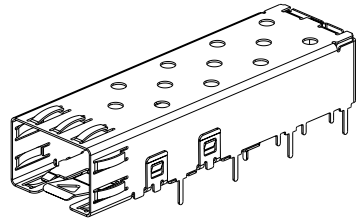
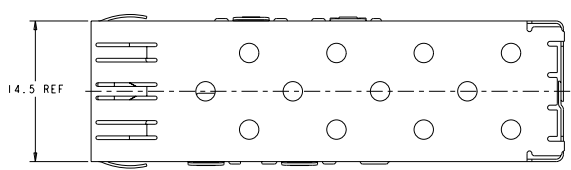

- △ 0.25 THICK COPPER ALLOY.
- △ TIN OVER NICKEL. NONPLATED EDGES PERMISSIBLE.
- 3. SFP MSA COMPATIBLE.
- △ PADS AND VIAS CHASSIS GROUND.
- △ DATUM AND BASIC DIMENSION ESTABLISHED BY CUSTOMER.

TRAY	1.80	1489962-4
REEL	1.80	1489962-3
TRAY	3.55	1489962-1
PACKAGING	DIM AA	PART NUMBER

THIS DRAWING IS A CONTROLLED DOCUMENT.

DATE: 04/15/16	BY: [Signature]	APPROVED: [Signature]
DESIGNED BY: [Signature]	CHECKED BY: [Signature]	DATE: 04/15/16
REVISED BY: [Signature]	DATE: 04/15/16	REVISED BY: [Signature]
DATE: 04/15/16	DATE: 04/15/16	DATE: 04/15/16

STE TE Connectivity
 CAGE ASSEMBLY, SOLDER PIN, SFP
 STATE: CA CASE NUMBER: 00779 © 1489962
 CUSTOMER DRAWING

