

15 Amp - Industrial/Commercial Grade

1584 Series

Key Features

- Built to meet the rugged requirements of commercial and industrial use.
- All metal housing - tough extruded aluminum case with a black powder paint coated steel cover.
- Heavy duty receptacles.
- Heavy 14 gauge wire cord - 14/3 SJT or SJWT for extreme temperature ranges and integral molded plug.
- Plug types available are NEMA 5-15P straight blade or NEMA L5-15P twist-lock (see table below).
- Mounting feet (with keyhole slots) allow temporary work station mounting if desired.
- On-Off switch is rocker type with light (on those units with on-off switch - listed below) or a red pilot light to indicate power on.
- Includes 15 amp, 125 volt resettable circuit breaker to prevent accidental line overload.
- CSA certified, Standards C22.2 (No. 21-95 and No. 42-99)
- UL listed, Standard UL1363
- Surge Protected models also available - please see the 1584 "S" models on **page 25**



Outlet Strips



| Part No. | Outlets | On-Off Switch | Pilot Light | Cord Length | Plug Type | Dimensions (inches) |
|----------|---------|---------------|-------------|-------------|------------|---------------------|
| 1584H4A1 | 4 | Yes | - | 6' | Straight | 11 x 2 x 2 |
| 1584H4B1 | 4 | Yes | - | 15' | Straight | 11 x 2 x 2 |
| 1584H4C1 | 4 | Yes | - | 6' | Twist-Lock | 11 x 2 x 2 |
| 1584H4D1 | 4 | Yes | - | 15' | Twist-Lock | 11 x 2 x 2 |
| 1584H5A1 | 5 | Yes | - | 6' | Straight | 14 x 2 x 2 |
| 1584H5B1 | 5 | Yes | - | 15' | Straight | 14 x 2 x 2 |
| 1584H5C1 | 5 | Yes | - | 6' | Twist-Lock | 14 x 2 x 2 |
| 1584H5D1 | 5 | Yes | - | 15' | Twist-Lock | 14 x 2 x 2 |
| 1584H6A1 | 6 | Yes | - | 6' | Straight | 14 x 2 x 2 |
| 1584H6B1 | 6 | Yes | - | 15' | Straight | 14 x 2 x 2 |
| 1584H6C1 | 6 | Yes | - | 6' | Twist-Lock | 14 x 2 x 2 |
| 1584H6D1 | 6 | Yes | - | 15' | Twist-Lock | 14 x 2 x 2 |
| 1584H7A1 | 7 | Yes | - | 6' | Straight | 17 x 2 x 2 |
| 1584H7B1 | 7 | Yes | - | 15' | Straight | 17 x 2 x 2 |
| 1584H7C1 | 7 | Yes | - | 6' | Twist-Lock | 17 x 2 x 2 |
| 1584H7D1 | 7 | Yes | - | 15' | Twist-Lock | 17 x 2 x 2 |
| 1584H8A1 | 8 | Yes | - | 6' | Straight | 17 x 2 x 2 |
| 1584H8B1 | 8 | Yes | - | 15' | Straight | 17 x 2 x 2 |
| 1584H8C1 | 8 | Yes | - | 6' | Twist-Lock | 17 x 2 x 2 |
| 1584H8D1 | 8 | Yes | - | 15' | Twist-Lock | 17 x 2 x 2 |
| 1584T4A1 | 4 | - | Yes | 6' | Straight | 11 x 2 x 2 |
| 1584T4B1 | 4 | - | Yes | 15' | Straight | 11 x 2 x 2 |
| 1584T4C1 | 4 | - | Yes | 6' | Twist-Lock | 11 x 2 x 2 |
| 1584T4D1 | 4 | - | Yes | 15' | Twist-Lock | 11 x 2 x 2 |
| 1584T5A1 | 5 | - | Yes | 6' | Straight | 14 x 2 x 2 |
| 1584T5B1 | 5 | - | Yes | 15' | Straight | 14 x 2 x 2 |
| 1584T5C1 | 5 | - | Yes | 6' | Twist-Lock | 14 x 2 x 2 |
| 1584T5D1 | 5 | - | Yes | 15' | Twist-Lock | 14 x 2 x 2 |
| 1584T6A1 | 6 | - | Yes | 6' | Straight | 14 x 2 x 2 |
| 1584T6B1 | 6 | - | Yes | 15' | Straight | 14 x 2 x 2 |
| 1584T6C1 | 6 | - | Yes | 6' | Twist-Lock | 14 x 2 x 2 |
| 1584T6D1 | 6 | - | Yes | 15' | Twist-Lock | 14 x 2 x 2 |
| 1584T7A1 | 7 | - | Yes | 6' | Straight | 17 x 2 x 2 |
| 1584T7B1 | 7 | - | Yes | 15' | Straight | 17 x 2 x 2 |
| 1584T7C1 | 7 | - | Yes | 6' | Twist-Lock | 17 x 2 x 2 |
| 1584T7D1 | 7 | - | Yes | 15' | Twist-Lock | 17 x 2 x 2 |
| 1584T8A1 | 8 | - | Yes | 6' | Straight | 17 x 2 x 2 |
| 1584T8B1 | 8 | - | Yes | 15' | Straight | 17 x 2 x 2 |
| 1584T8C1 | 8 | - | Yes | 6' | Twist-Lock | 17 x 2 x 2 |
| 1584T8D1 | 8 | - | Yes | 15' | Twist-Lock | 17 x 2 x 2 |

Also Available (by special order) - change to a 90 degree Nema 5-15P plug on 1584 models ending in 'A1' or 'B1'.

NOTES

BUILT TO MEET THE REQUIREMENTS OF INDUSTRIAL AND COMMERCIAL USE. ALL METAL HOUSING—TOUGH EXTRUDED ALUMINUM CASE WITH BLACK POWDER—COATED STEEL COVER.
HEAVY-DUTY CORD — 14/3 SJTW WIRE FOR EXTREME TEMPERATURE RANGES.
INTEGRAL MOLDED PLUG AVAILABLE IN STRAIGHT-BLADE (NEMA 5-15P) OR TWIST-LOCK (NEMA L5-15P) CONFIGURATIONS.
SEPARATE MOUNTING FEET WITH KEYHOLE SLOTS PROVIDE FOR WORK STATION MOUNTING IF DESIRED.
COMES WITH LIGHTED ON/OFF SWITCH.
INCLUDES 15A, 125VAC CIRCUIT BREAKER TO PREVENT ACCIDENTAL LINE OVERLOAD.
CSA CERTIFIED, UL 1363 LISTED.

L.SIDE VIEW

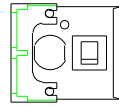

TOP VIEW

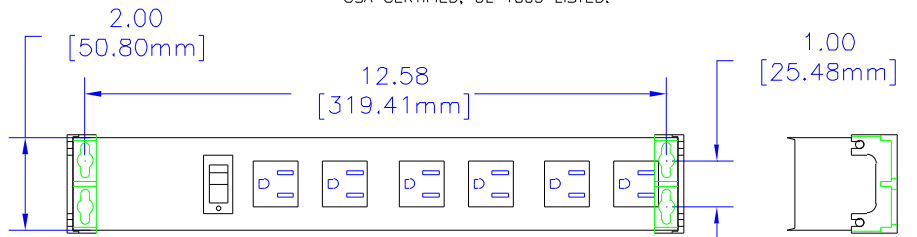

R.SIDE VIEW

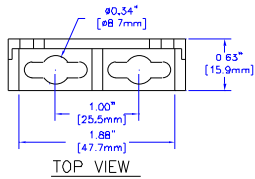

TOP VIEW

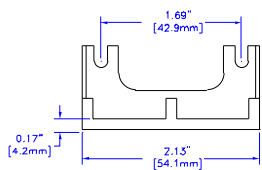

FRONT VIEW

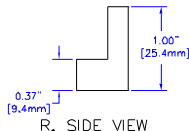

R. SIDE VIEW

MOUNTING FEET DETAIL

SIDE VIEW

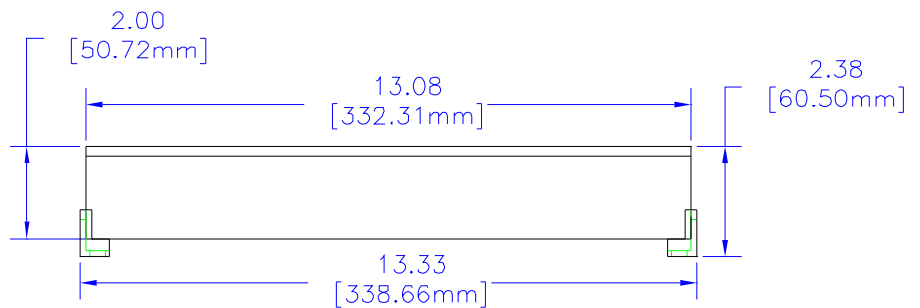

*SEE CATALOG FOR THE COMPLETE PART NUMBER BASED ON THE OPTIONS LISTED IN THE NOTE SECTION

UNLESS OTHERWISE SPECIFIED
DIMENSIONS ARE IN INCHES
X +/- .1
XX +/- .02
XXX +/- .012
DIMS +/- .005
ANGLES +/- .5 DEG.
HAMMOND CLEARANCE RIGHTS TO THE MATERIALS OF THIS DRAWING IS RESERVED TO BE USED AS A REFERENCE FOR INDICATED DIMENSIONS ONLY. THIS INFORMATION MAY NOT BE USED TO REPRODUCE OR COPY THIS DRAWING WITHOUT THE WRITTEN PERMISSION FROM HAMMOND MANUFACTURING.



HAMMOND
MANUFACTURING

FILE
HAMMOND INDUSTRIAL
GRADE POWER STRIPS
DRAWN BY NJM
SCALE PAGE 1 OF 1
PART NUMBER
1584H6****