

## PS-6360 6 Volt 36.0 AH

### Rechargeable Sealed Lead Acid Battery

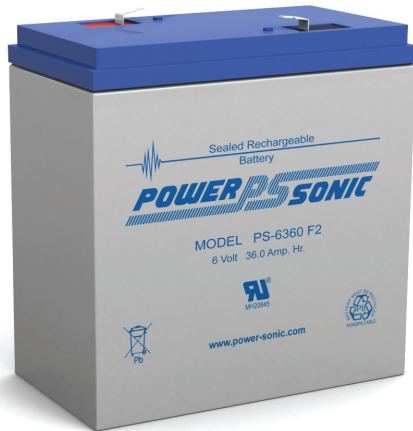

We've Got The Power.™



### Features

- Absorbent Glass Mat (AGM) technology for superior performance
- Valve regulated, spill proof construction allows safe operation in any position
- Power/volume ratio yielding unrivaled energy density
- Rugged impact resistant ABS case and cover (UL94-HB)
- Approved for transport by air. D.O.T., I.A.T.A., F.A.A. and C.A.B. certified
- U.L. recognized under file number MH 20845

### Terminals

(mm)

- F2 - Quick disconnect tabs, 0.250" x 0.032", mate with AMP. INC. FASTON "250"
- NB1 - tin plated brass posts with 5mm nut & bolt fasteners

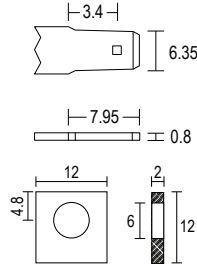

### Physical Dimensions: in (mm)

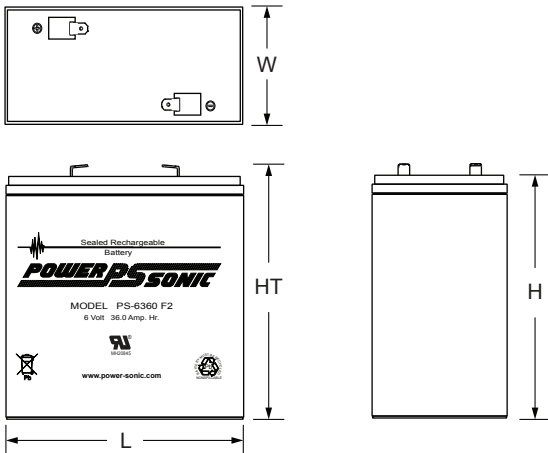

L: 6.25 (159) W: 3.35 (85) H: 6.50 (165) HT: 6.93 (176)

Tolerances are +/- 0.04 in. (+/- 1mm) and +/- 0.08 in. (+/- 2mm) for height dimensions. All data subject to change without notice.

### Performance Specifications

|   |  |
|---|--|
| <b>Nominal Voltage</b> .....                                | 6 volts (3 cells)                      |
| <b>Nominal Capacity</b>                                     |  |
| 20-hr. (1.8A to 5.25 volts) .....                           | 36.00 AH                               |
| 10-hr. (3.35A to 5.25 volts) .....                          | 33.50 AH                               |
| 5-hr. (6.12A to 5.10 volts) .....                           | 30.60 AH                               |
| 1-hr. (22.3A to 4.50 volts) .....                           | 22.30 AH                               |
| 15-min. (70.6A to 4.50 volts) .....                         | 17.65 AH                               |
| <b>Approximate Weight</b> .....                             | 12.10 lbs. (5.49 kg)                   |
| <b>Energy Density</b> (20-hr. rate) .....                   | 1.59 W-h/in <sup>3</sup> (96.85 W-h/l) |
| <b>Specific Energy</b> (20-hr. rate) .....                  | 17.85 W-h/lb (39.36 W-h/kg)            |
| <b>Internal Resistance</b> (approx.) .....                  | 6 milliohms                            |
| <b>Max Discharge Current</b> (7 Min.) .....                 | 108 amperes                            |
| <b>Max Short-Duration Discharge Current</b> (10 Sec.) ..... | 360 amperes                            |
| <b>Shelf Life</b> (% of nominal capacity at 68°F (20°C))    |  |
| 1 Month .....   | 97%                                    |
| 3 Months .....  | 91%                                    |
| 6 Months .....  | 83%                                    |
| <b>Operating Temperature Range</b>                          |  |
| Charge .....  | -4°F (-20°C) to 122°F (50°C)           |
| Discharge .....   | -40°F (-40°C) to 140°F (60°C)          |
| <b>Case</b> .....   | ABS Plastic                            |
| <b>Power-Sonic Chargers</b> .....                           | PSC-64000A, 64000A-C                   |

**Shelf Life & Storage**



**Discharge Characteristics**

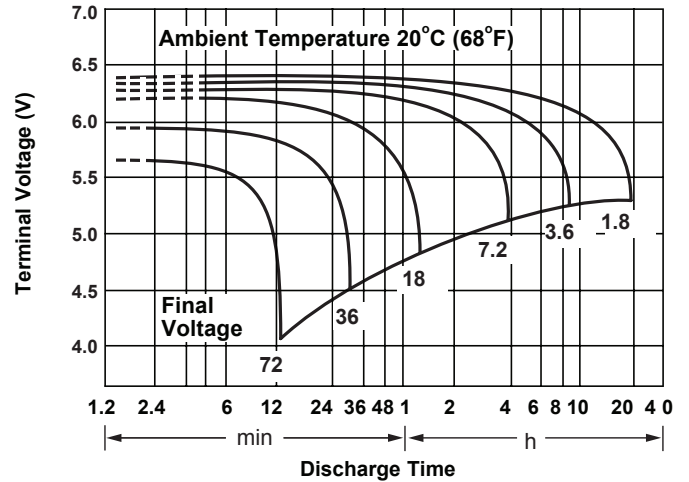

**Discharge Time vs. Discharge Current**

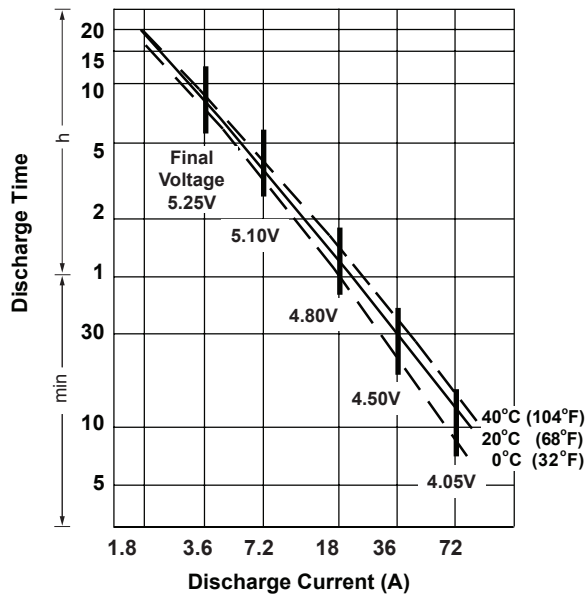

**Life Characteristics in Stand-By Use**



**Life Characteristics in Cyclic Use**



**Charging**

**Cycle Applications:** Limit initial current to 10.8A. Charge until battery voltage (under charge) reaches 7.20 to 7.35 volts at 68°F (20°C). Hold at 7.20 to 7.35 volts until current drops to under 360mA. Battery is fully charged under these conditions, and charger should be disconnected or switched to “float” voltage.

**“Float” or “Stand-By” Service:** Hold battery across constant voltage source of 6.75 to 6.90 volts continuously. When held at this voltage, the battery will seek its own current level and maintain itself in a fully charged condition.

**Note:** Due to the self-discharge characteristics of this type of battery, it is imperative that they be charged within 6 months of storage, otherwise permanent loss of capacity might occur as a result of sulfation.

**Chargers**

Power-Sonic offers a wide range of chargers suitable for batteries up to 100AH. Please refer to the Charger Selection Guide in our specification sheets for “C-Series Switch Mode Chargers” and “Transformer Type A and F Series”. Please contact our Technical department for advice if you have difficulty in locating suitable models.

**Further Information**

Please refer to our website [www.power-sonic.com](http://www.power-sonic.com) for a complete range of useful downloads, such as product catalogs, material safety data sheets (MSDS), ISO certification, etc..

**Contact Information**

[www.power-sonic.com](http://www.power-sonic.com)

**DOMESTIC SALES**

Tel: +1-619-661-2020  
 Fax: +1-619-661-3650  
[national-sales@power-sonic.com](mailto:national-sales@power-sonic.com)

**CUSTOMER SERVICE**

Tel: +1-619-661-2030  
 Fax: +1-619-661-3648  
[customer-service@power-sonic.com](mailto:customer-service@power-sonic.com)

**TECHNICAL SUPPORT**

Tel: +1-619-661-2020  
 Fax: +1-619-661-3648  
[support@power-sonic.com](mailto:support@power-sonic.com)

**INTERNATIONAL SALES**

Tel: +1-650-364-5001  
 Fax: +1-650-366-3662  
[battery@power-sonic.com](mailto:battery@power-sonic.com)