

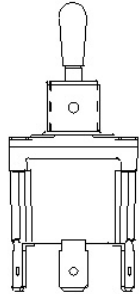

32NT91-70



Actual product appearance may vary.

NT Series Toggle Switch, 2 pole, 3 position, Quick Connect terminal, Standard Lever

Features

- Completely sealed switching chamber
- NEMA 3, 3R, 4, and 13
- UL recognized, File E12252, Vol. 1, Section 44
- CSA certified, File LR4442
- CE approved

Potential Applications

- Aerial lifts, scissor lifts, truck mounted tele-handlers, and cranes
- Construction equipment
- Agriculture equipment
- Material-handling equipment
- Factory-floor control units
- Machine tool equipment manufacturers

Description

MICRO SWITCH™ NT Series toggle switches meet the need for a rugged, cost-effective toggle switch. Quality construction features include a seal between the toggle lever and bushing, and between the cover and case. These switches can be used where panels are subject to splashes, hosedowns, or outdoor environments. The "Easy-Start" threaded bushing enables quick alignment of mounting nut to decrease the chance of cross threading. The panel stand-off with O-ring feature available on some listings, eliminates the need for behind-the-panel hardware, provides uniform panel height, and provides a panel to cover seal.

Product Specifications

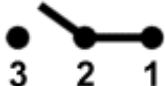
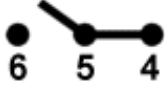
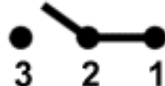
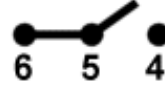
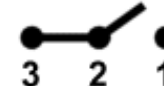
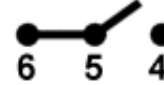
Circuitry/ Operating action	<div style="display: flex; justify-content: space-around;"> <div style="text-align: center;"> <p>Keyway Momentary Position</p>  <p>3 2 1</p>  <p>6 5 4</p> <p>ON</p> </div> <div style="text-align: center;"> <p>Center Maintained Position</p>  <p>3 2 1</p>  <p>6 5 4</p> <p>ON</p> </div> <div style="text-align: center;"> <p>Opposite Keyway Momentary Position</p>  <p>3 2 1</p>  <p>6 5 4</p> <p>ON</p> </div> </div>
Product Type	MICRO SWITCH™ Toggle Switch
Ampere/ Voltage Range (Resistive Load)	0.5 A to 18 A at 0.5 Vdc to 28 Vdc, 0.5 A to 10 A at 0.5 Vac to 277 Vac, 0.5 A at 250 Vdc, 0.75 A at 115 Vdc
Circuitry	DPDT
Action	3 position
Mounting	Bushing 15/32 in
Termination	Quick Connect
Lever Type	Standard
UL/CSA Rating Code	L192: 10 A-125, 250, 277 Vac; 1/4 Hp-125 Vac; 1/2 Hp-250, 277 Vac; 3 A-125 Vac "L"
Comment	Switches are capable of withstanding a temperature of 160 degrees F continuously at full rated load
Availability	Global
UNSPSC Code	30211908
UNSPSC Commodity	30211908 Toggle switches
Series Name	NT

CATALOG LISTING 32NT91-70 SERIES CHART 1
 ISSUE 2
 PTC/CAD 20
 DRAWN TSM
 CHECK 14 JUL 94
 CHECK 20 JUL 94
 DAW
 REVISIONS
 A CO-94361
 RSC
 24 NOV 99
 CHECK
 RELEASE NO. PR-21196
 REPLACES

MICRO SWITCH
 a Honeywell Division
 FED. MFG. CODE 91929

SWITCH - TOGGLE

CATALOG LISTING
32NT91-70 SERIES CHART 1

THIS DRAWING COVERS A PROPRIETARY ITEM AND IS THE PROPERTY OF MICRO SWITCH, A DIVISION OF HONEYWELL. THIS DRAWING IS NOT TO BE COPIED OR USED WITHOUT THE APPROVAL OF MICRO SWITCH

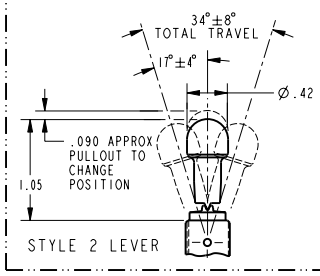
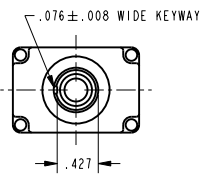

STYLE 1 LEVER

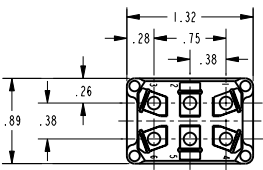
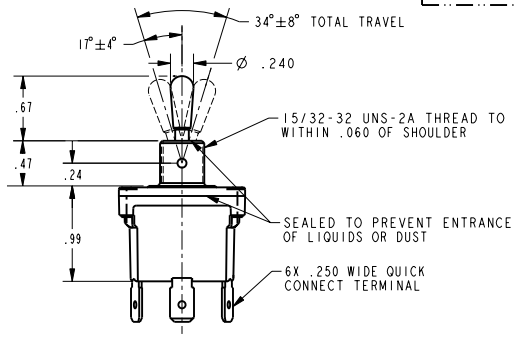

CATALOG LISTING	AVAILABLE LOCKING COMBINATIONS FOR CONFIGURATION SEE LETTERED DETAILS	STYLE NUMBER	ELECTRICAL RATING
32NT91-70	NONE	1	L192 10A 125, 250, 277 VAC 1/4HP 125 VAC 1/2HP 250, 277 VAC 3A 125 VAC "L"
32NT91-70/5	E.L.N	2	

"A"	"B"	"D"	"E"	"F"	"G"
LOCKED IN THREE POSITIONS	LOCKED IN CENTER AND EXTREME POS. (KEYWAY SIDE)	LOCKED OUT OF CENTER POSITION	LOCKED IN CENTER POSITION	LOCKED IN EXTREME POS. (OPP. KEYWAY)	LOCKED IN EXTREME POS. (KEYWAY SIDE)
"H"	"J"	"K"	"L"	"M"	"N"
LOCKED OUT OF CENTER AND EXTREME POS. (KEYWAY SIDE)	LOCKED OUT OF CENTER AND EXTREME POS. (OPP. KEYWAY)	LOCKED IN CENTER AND EXTREME POS. (OPP. KEYWAY)	LOCKED OUT OF CENTER POSITION (KEYWAY SIDE)	LOCKED OUT OF CENTER AND INTO EXTREME POS. (OPP. KEYWAY)	LOCKED OUT OF EXTREME POS. (OPP. KEYWAY)

CIRCUIT MADE WITH TOGGLE LEVER IN	KEYWAY SIDE	CENTER	OPPOSITE KEYWAY
	MOMENTARY POSITION	MAINTAINED POSITION	MOMENTARY POSITION

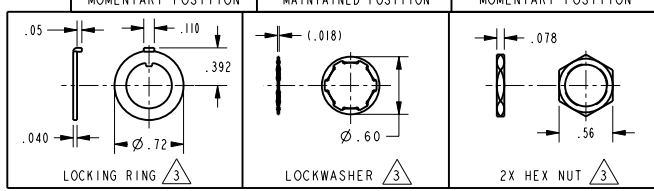

NOTES
 1 - SWITCHES ARE CAPABLE OF WITHSTANDING A TEMPERATURE OF 160°F CONTINUOUSLY AT FULL RATED LOAD
 2 - MICRO SWITCH CAT. LIST. MARKED ON SIDE OF SWITCH
 3 - FURNISHED UNASSEMBLED
 4 - KEYWAY SHOWN ON LEFT SIDE
 5 - SUFFIX LETTER MUST BE ADDED FOR DESIRED TYPE OF TOGGLE LOCKING. SEE CHART FOR AVAILABLE LOCKING COMBINATIONS

THIRD ANGLE PROJECTION	
SCALE	FULL
DO NOT SCALE PRINT	
UNLESS OTHERWISE SPECIFIED TOLERANCES ARE	
ONE PLACE	(.01) ±.030
TWO PLACE	(.00) ±.015
THREE PLACE	(.000) ±.005
ANGLES	±
WEIGHT	.12 LBS APPROX

ANSI Y14.5M-1982 APPLIES