



32NT91-1



Actual product appearance may vary.

NT Series Toggle Switch, 2 pole, 3 position, Quick Connect terminal, Standard Lever

Features



- Completely sealed switching chamber
- NEMA 3, 3R, 4, and 13
- UL recognized, File E12252, Vol. 1, Section 44
- CSA certified, File LR4442
- CE approved

Potential Applications

- Aerial lifts, scissor lifts, truck mounted tele-handlers, and cranes
- Construction equipment
- Agriculture equipment
- Material-handling equipment
- Factory-floor control units
- Machine tool equipment manufacturers

Description

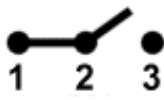
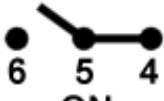
MICRO SWITCH™ NT Series toggle switches meet the need for a rugged, cost-effective toggle switch. Quality construction features include a seal between the toggle lever and bushing, and between the cover and case. These switches can be used where panels are subject to splashes, hosedowns, or outdoor environments. The "Easy-Start" threaded bushing enables quick alignment of mounting nut to decrease the chance of cross threading. The panel stand-off with O-ring feature available on some listings, eliminates the need for behind-the-panel hardware, provides uniform panel height, and provides a panel to cover seal.

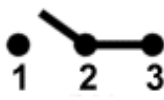
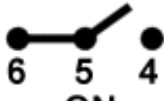
Product Specifications			
Circuitry/ Operating action	<p>Keyway Position</p>  <p>1 2 3</p>  <p>6 5 4</p> <p>ON</p>	<p>Center Position</p>  <p>1 2 3</p>  <p>6 5 4</p> <p>OFF</p>	<p>Opposite Keyway Position</p>  <p>1 2 3</p>  <p>6 5 4</p> <p>ON</p>
Product Type	MICRO SWITCH™ Toggle Switch		
Ampere/ Voltage Range (Resistive Load)	0.5 A to 15 A at 0.5 Vac to 277 Vac, 0.5 A to 20 A at 0.5 Vdc to 28 Vdc, 0.5 A at 250 Vdc, 0.75 A at 115 Vdc		
Circuitry	DPDT		
Action	3 position		
Mounting	Bushing 15/32 in		
Termination	Quick Connect		
Lever Type	Standard		
UL/CSA Rating Code	L191: 15 A-125, 250, 277 Vac; 1/2 Hp-125 Vac; 1 Hp-250, 277 Vac; 5 A-120 Vac "L"		
Comment	Switches are capable of withstanding a temperature of 160 degrees F continuously at full rated load		
Availability	Global		
UNSPSC Code	30211908		
UNSPSC Commodity	30211908 Toggle switches		
Series Name	NT		

MICRO SWITCH
a Honeywell Division
FED. MFG. CODE 91929

SWITCH - TOGGLE

32NT91 SERIES CHART 1

CATALOG LISTING

THIS DRAWING COVERS A PROPRIETARY ITEM AND IS THE PROPERTY OF MICRO SWITCH, A DIVISION OF HONEYWELL. THIS DRAWING IS NOT TO BE COPIED OR USED WITHOUT THE APPROVAL OF MICRO SWITCH

CATALOG LISTING	CIRCUIT MADE WITH TOGGLE LEVER IN			ELECTRICAL DATA
	KEYWAY SIDE (1-2, 4-5)	CENTER (1-2, 4-5)	OPPOSITE KEYWAY (2-3, 5-6)	
32NT91-1	ON	OFF	ON	L191 15A 125, 250, 277 VAC 1/2HP 125 VAC 1HP 250, 277 VAC 5A 125 VAC "L"
32NT91-2	OFF	NONE	ON	
32NT91-3	ON	NONE	ON	
32NT91-21	NONE	OFF	ON	
32NT91-31	NONE	ON	ON	
32NT91-4	MOM OFF	NONE	ON	
32NT91-5	MOM ON	OFF	ON	
32NT91-6	MOM ON	NONE	OFF	
32NT91-7	MOM ON	OFF	MOM ON	L192 10A 125, 250, 277 VAC 1/4HP 125 VAC 1/2HP 250, 277 VAC 3A 125 VAC "L"
32NT91-8	MOM ON	NONE	ON	
(A)	NONE	ON	MOM ON	
32NT91-61	MOM ON	OFF	NONE	

ELECTRICAL DATA

L191 15A 125, 250, 277 VAC
1/2HP 125 VAC
1HP 250, 277 VAC
5A 125 VAC "L"



L192 10A 125, 250, 277 VAC
1/4HP 125 VAC
1/2HP 250, 277 VAC
3A 125 VAC "L"



.076±.008 WIDE KEYWAY

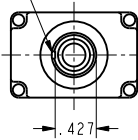

17°±4°
34°±8° TOTAL TRAVEL
Ø .240

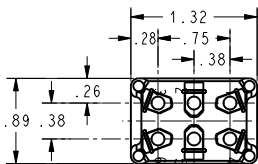
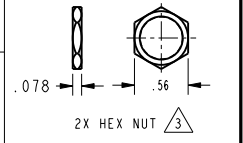
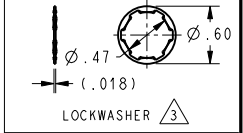
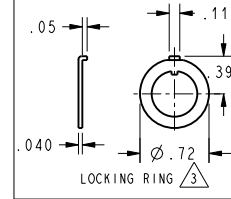
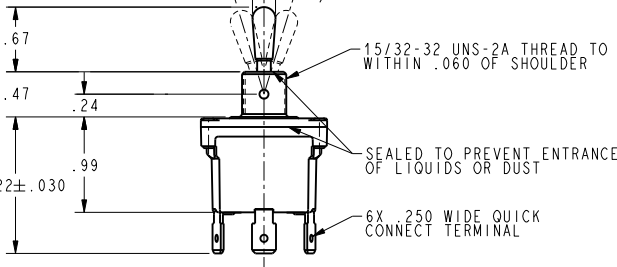

NOTES

- SWITCHES ARE CAPABLE OF WITHSTANDING A TEMPERATURE OF 160°F CONTINUOUSLY AT FULL RATED LOAD
- MICRO SWITCH CAT. LIST. MARKED ON SIDE OF SWITCH FURNISHED UNASSEMBLED
- APPLIES ONLY TO "ON" AND "MOMENTARY ON" POSITIONS
- TO ORDER WITHOUT HARDWARE ADD (-NH) SUFFIX TO CATALOG LISTING

THIRD ANGLE PROJECTION	
SCALE	FULL
DO NOT SCALE PRINT	
UNLESS OTHERWISE SPECIFIED TOLERANCES ARE	
ONE PLACE	(.01) ±.030
TWO PLACE	(.00) ±.015
THREE PLACE	(.000) ±.005
ANGLES	±
WEIGHT	

ANSI Y14.5M-1982 APPLIES

CATALOG LISTING 32NT91 SERIES CHART 1
PAGE 1 OF 1
ISSUE 7
RELEASE NO. PR-20625 REPLACES
CHECK
REVISIONS
A C095305 SM 9NOV99
B C0-94361 M/S 23 NOV 98
C 207782 C.S. 1 9NOV99
D 0002684 C.S. 1 27 NOV 93
E 0002302 C.S. 1 10 DEC 93
CHECK SAV 9NOV99
TSM
PTC/CAD 2D
DRAWN