

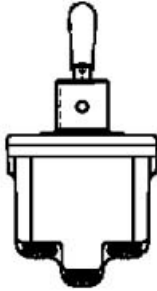

### 2NT1-50



**NT Series Toggle Switch, 2 pole, 3 position, Screw terminal, Standard Lever**

*Actual product appearance may vary.*

#### Features

- Completely sealed switching chamber
- NEMA 3, 3R, 4, and 13
- UL recognized, File E12252, Vol. 1, Section 44
- CSA certified, File LR4442
- CE approved

#### Potential Applications

- Aerial lifts, scissor lifts, truck mounted tele-handlers, and cranes
- Construction equipment
- Agriculture equipment
- Material-handling equipment
- Factory-floor control units
- Machine tool equipment manufacturers

#### Description

MICRO SWITCH™ NT Series toggle switches meet the need for a rugged, cost-effective toggle switch. Quality construction features include a seal between the toggle lever and bushing, and between the cover and case. These switches can be used where panels are subject to splashes, hosedowns, or outdoor environments. The "Easy-Start" threaded bushing enables quick alignment of mounting nut to decrease the chance of cross threading. The panel stand-off with O-ring feature available on some listings, eliminates the need for behind-the-panel hardware, provides uniform panel height, and provides a panel to cover seal.

## Product Specifications

Circuitry/ Operating action	<div style="display: flex; justify-content: space-around; text-align: center;"> <div> <p><b>Keyway Momentary Position</b></p> <p><b>ON</b></p> </div> <div> <p><b>Center Maintained Position</b></p> <p><b>ON</b></p> </div> <div> <p><b>Opposite Keyway Maintained Position</b></p> <p><b>ON</b></p> </div> </div>
Product Type	MICRO SWITCH™ Toggle Switch
Ampere/ Voltage Range (Resistive Load)	0.75 A at 115 Vdc, 0.5 A at 250 Vdc, 0.5 A to 10 A at 0.5 Vac to 277 Vac, 0.5 A to 18 A at 0.5 Vdc to 28 Vdc
Circuitry	DPDT
Action	3 position
Mounting	Bushing 15/32 in
Termination	Screw
Lever Type	Standard
UL/CSA Rating Code	L192: 10 A-125, 250, 277 Vac; 1/4 Hp-125 Vac; 1/2 Hp-250, 277 Vac; 3 A-125 Vac "L"
Comment	Thermoplastic case
Availability	Global
UNSPSC Code	30211908
UNSPSC Commodity	30211908 Toggle switches
Series Name	NT

ISSUE 2 OF 2 PAGES  
 CATALOG LISTING 2NT1-50 SERIES CHART 1  
 REVISIONS  
 A CO-94328  
 3 A V  
 2 NOV 85  
 PTC/CAD 20  
 DRAWN  
 S A V 22 NOV 99 CHECK JAF 22 NOV 99 CHECK  
 RELEASE NO. PR-21800 REPLACES

**MICRO SWITCH**  
a Honeywell Division  
FED. MFG. CODE 91929

**SWITCH - TOGGLE**

CATALOG LISTING  
**2NT1-50 SERIES CHART 1**

THIS DRAWING COVERS A PROPRIETARY ITEM AND IS THE PROPERTY OF MICRO SWITCH, A DIVISION OF HONEYWELL. THIS DRAWING IS NOT TO BE COPIED OR USED WITHOUT THE APPROVAL OF MICRO SWITCH

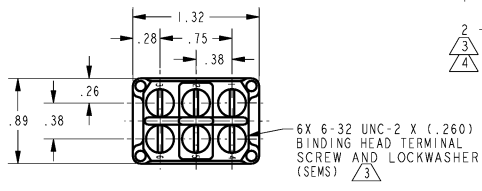
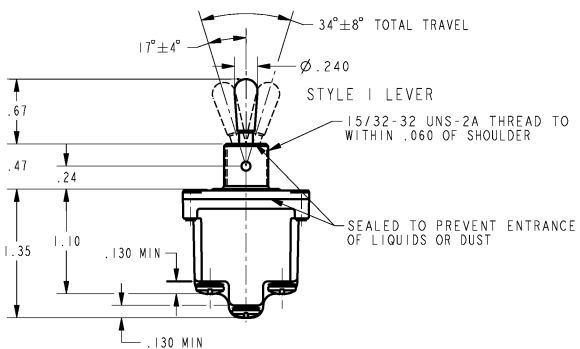
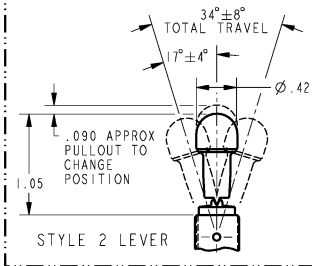
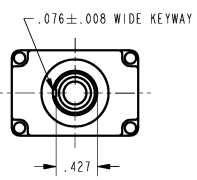

CATALOG LISTING	AVAILABLE LOCKING COMBINATIONS FOR CONFIGURATION SEE LETTERED DETAILS	STYLE NUMBER	CURRENT CAPACITY (AMPS)								
			RESISTIVE LOAD DC VOLTS		AC VOLTS		LAMP LOAD 28 VDC	INDUCTIVE LOAD 28 VAC			
2NT1-50	NONE	1	18	.75	.5	11	6	5	2	10	8
2NT1-50/4	E, F, K, L, M, N	2									
"A"	LOCKED IN THREE POSITIONS	4									
"B"	LOCKED IN CENTER AND EXTREME POS. (KEYWAY SIDE)	4									
"D"	LOCKED OUT OF CENTER POSITION	4									
"E"	LOCKED IN CENTER POSITION	4									
"F"	LOCKED IN EXTREME POS. (OPP. KEYWAY)	4									
"G"	LOCKED IN EXTREME POS. (KEYWAY SIDE)	4									
"H"	LOCKED OUT OF CENTER AND EXTREME POS. (KEYWAY SIDE)	4									
"J"	LOCKED OUT OF CENTER AND EXTREME POS. (OPP. KEYWAY)	4									
"K"	LOCKED IN CENTER AND EXTREME POS. (OPP. KEYWAY)	4									
"L"	LOCKED OUT OF EXTREME POS. (KEYWAY SIDE)	4									
"M"	LOCKED OUT OF CENTER AND INTO EXTREME POS. (OPP. KEYWAY)	4									
"N"	LOCKED OUT OF EXTREME POS. (OPP. KEYWAY)	4									

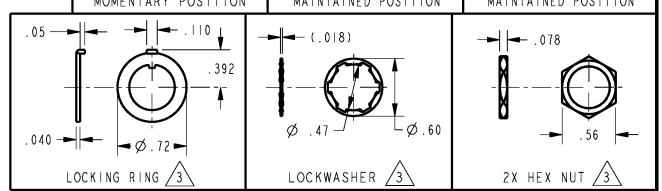
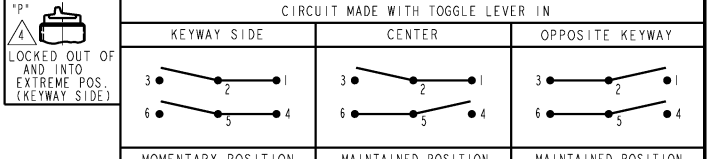

**NOTES**  
 1 - SWITCHES ARE CAPABLE OF WITHSTANDING A TEMPERATURE OF 160°F CONTINUOUSLY AT FULL RATED LOAD  
 2 - MICRO SWITCH CAT. LIST, MARKED ON SIDE OF SWITCH FURNISHED UNASSEMBLED  
 3 - SUFFIX LETTER MUST BE ADDED FOR DESIRED TYPE OF TOGGLE LOCKING. SEE CHART FOR AVAILABLE LOCKING COMBINATIONS

**ELECTRICAL RATING**

L192 10A 125, 250, 277 VAC  
 1/4HP 125 VAC  
 1/2HP 250, 277 VAC  
 3A 125 VAC "L"

THIRD ANGLE PROJECTION

SCALE FULL

DO NOT SCALE PRINT

UNLESS OTHERWISE SPECIFIED TOLERANCES ARE

ONE PLACE (.03) ±.030  
 TWO PLACE (.00) ±.015  
 THREE PLACE (.000) ±.005  
 ANGLES ±

WEIGHT .12 LBS APPROX

ANSI Y14.5M-1982 APPLIES