

AT494
Protective Guard
 Polycarbonate & polyamide
 Series: KB

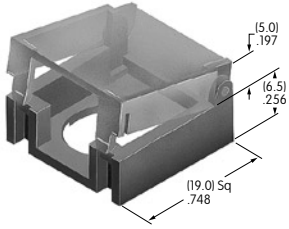

AT495
Dust Cover
 Polyamide & polyvinyl chloride
 Series: KB

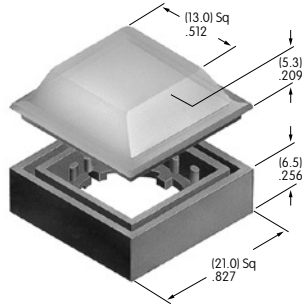

AT496
.295" Diameter Cap
 Polyamide
 Colors: A B C
 Series: AB BB FB M2B MB24



AT497
End Barrier
 Polyamide
 Color: A
 Series: LB

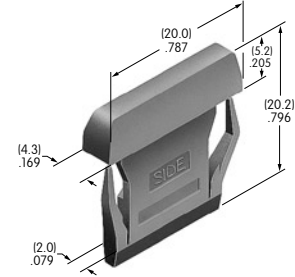

AT498
Center Barrier
 Polyamide
 Color: A
 Series: LB

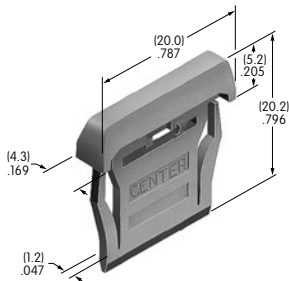

AT499
Protective Guard for Square
 Polycarbonate & polyamide
 Series: LB

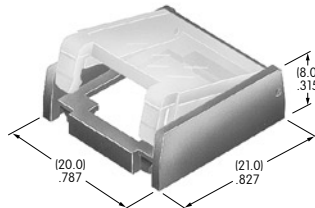

AT500s

AT501 (M-metric H-inch)
Knurled Face Nut
 Chrome/brass
 Series: E EB M MB20 MB24 P

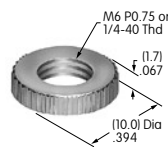

AT503
Hex Face Nut
 Chrome/brass
 Series: M P S SB WB WT

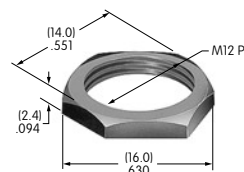

AT504
Knurled Face Nut
 Chrome/brass
 Series: M P S SB WB WT

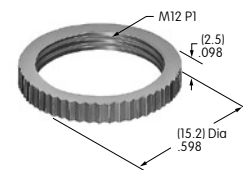

Color Codes: A Black B White C Red D Amber E Yellow F Green G Blue H Gray J Clear

AT4146
Tubular Key
 Nickel/brass
 with ABS handle
 Color: A
 Series: CKM

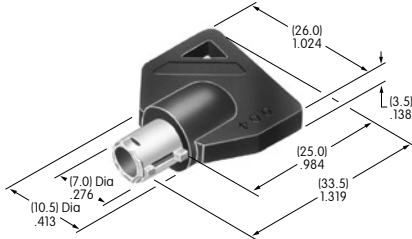

AT4147
Flat Key
 Nickel/brass
 with ABS handle
 Color: A
 Series: CKM

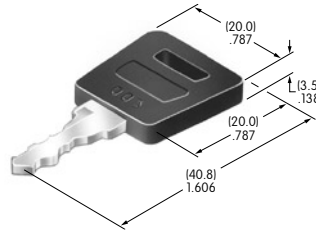

AT4148
.365" Wide Rocker
 Polyamide
 Colors: A B C E F G H
 Series: M M2T P

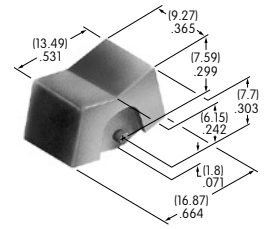

AT4149
.365" Wide Paddle
 Polyamide
 Colors: A B C E F G H
 Series: M M2T P

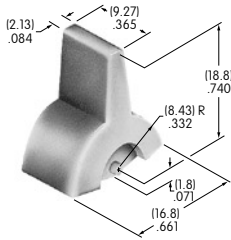

AT4150
.450" Wide Rocker
 Polyamide
 Colors: A B C E F G H
 Series: M M2T

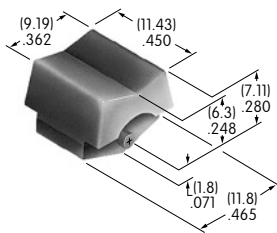

AT4151
.450" Wide Paddle
 Polyamide
 Colors: A B C E F G H
 Series: M M2T

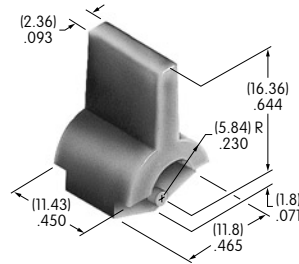

AT4152
Tubular Key
 Nickel/brass
 Series: CKL

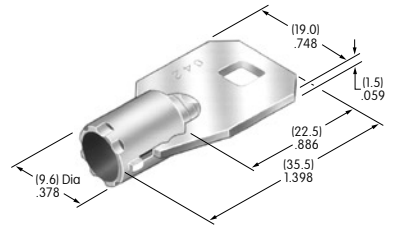

AT4153
Flat Key
 Chrome/brass
 Series: CKL

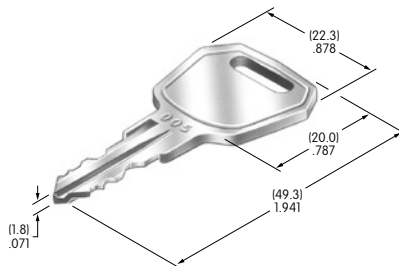

AT4156
.595" Wide Rocker
 Polyamide
 Colors: A B C E F G H
 Series: M P

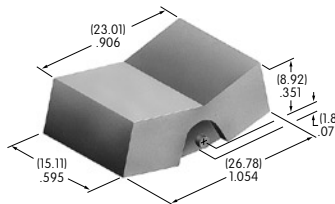

AT4157
.595" Wide Paddle
 Polyamide
 Colors: A B C E F G H
 Series: M P

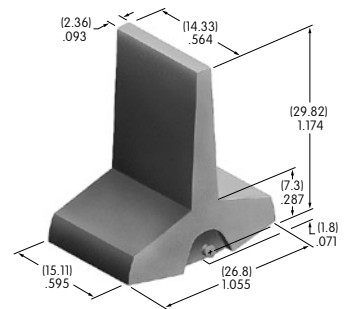

Color Codes: A Black B White C Red D Amber E Yellow F Green G Blue H Gray J Clear