

## LED COLORS & SPECIFICATIONS

The electrical specifications shown are determined at a basic temperature of 25°C.  
 LED circuit is isolated and requires external power source. Single element LED is colored in OFF state.  
 If the source voltage exceeds the rated voltage, a ballast resistor is required.  
 The resistor value can be calculated by using the formula in the Supplement section.

Bright AT633		Note for Super Bright:	Bright			Super Bright			Unit	
			5C	5D	5F	6B	6F	6G		
Super Bright		Color	Red	Amber	Green	White	Green	Blue		
AT624G Blue		Forward Peak Current	$I_{FM}$	30	30	25	30	30	30	mA
		Continuous Forward Current	$I_F$	20	20	20	20	20	20	mA
AT629B White		Forward Voltage	$V_F$	1.85	2.0	2.2	3.6	3.5	3.6	V
AT630F Green		Reverse Peak Voltage	$V_{RM}$	5	5	5	5	5	5	V
		Current Reduction Rate Above 25°C	$\Delta I_F$	0.40	0.42	0.38	0.50	0.50	0.50	mA/°C
T-1 Bi-pin		Ambient Temperature Range		-25° ~ +50°C			-25° ~ +50°C			

## CAP TYPES & COLORS

Color Codes:      A Black      B White      C Red      D Amber      F Green      J Clear

### Colored Cap for Bright LEDs

Cap Colors Available:

**AB** Black Cap with Translucent White Window for LED Display

**AT4052**  
Spot Illuminated

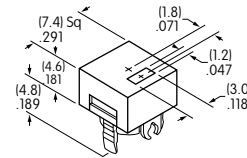

Square only

Material: Polycarbonate  
Finish: Matte

Lens/Diffuser  
Colors Available:

**CB** Red/White

**DB** Amber/White

**FB** Green/White

**AT4166**  
Square

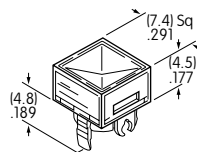

**AT4167**  
Round

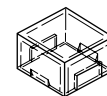
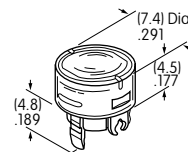

Transparent Colored Lens



Translucent White Diffuser



Colored LED  
AT633

Material: Polycarbonate      Finish: Glossy

### White Cap for Bright & Super Bright LEDs

**JB** Clear Lens/  
White Diffuser

Material: Polycarbonate  
Finish: Glossy

**AT4031**  
Square

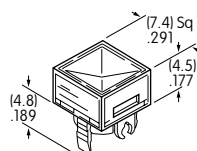

**AT4032**  
Round

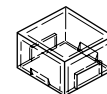
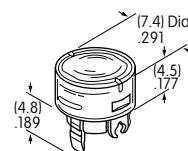

Transparent Clear Lens



Translucent White Diffuser



Colored LEDs  
AT624, AT629,  
AT630, or AT633

## TYPICAL SWITCH DIMENSIONS

### Square

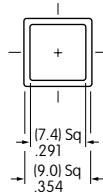

### Single Pole

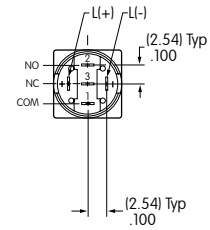
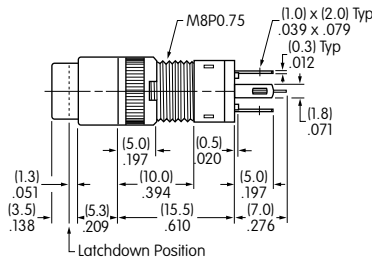

HB15SKW01-5C-CB

### Round

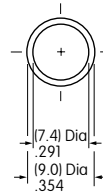

### Single Pole

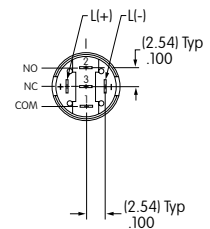
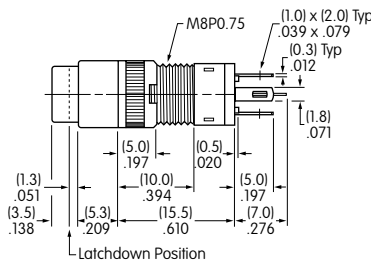

HB16CKW01-5C-CB

## ASSEMBLY INSTRUCTIONS

### Cap Removal

1. Have cap in extended position (not latchdown) for alternate action models.
2. Use the grip slots on the sides of the cap and pull it out of the switch.

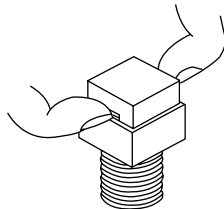

### LED Polarity & Orientation in Lamp Socket

For AT624, AT629, AT630: Insert the LED with the D flat opposite the black dot molded inside the switch lamp socket. For AT633: Insert the LED with the Black Dot on the terminal to the right.

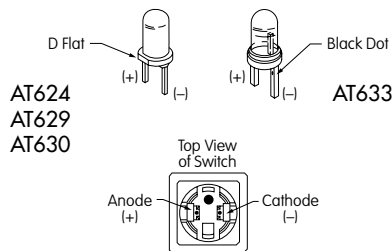

Super Bright LEDs AT624, AT629, & AT630 are electrostatic sensitive.

### Cap Replacement

1. Match the prongs on the cap base with the projections in the switch, at the same time aligning the spring clips on the cap with the indentations in the switch.
2. Press firmly in place.

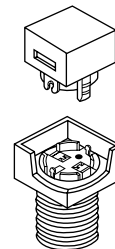

### AT111 Lamping Tool

Lamping Tool AT111 may be used to remove and replace LED.



### AT110 Socket Wrench

Socket Wrench AT110 may be used to tighten the mounting nut.

