

Tous droits strictement réservés. Reproduction ou communication a des tiers interdite sous quelque forme que ce soit sans autorisation écrite du propriétaire. Propriété de c FCI. Droits de reproduction FCI.

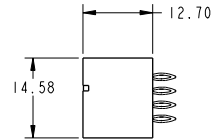

All rights strictly reserved. Reproduction or issue to third parties in any form whatever is not permitted without written authority from the proprietor. Property of FCI. Copyright FCI.

PRODUCT No.	ROWS	POWER		SIGNAL						POWER	
		E1	P1	1	2	3	4	5	6	P2	E2
51952-002-- NOTE: 3	D C B A										

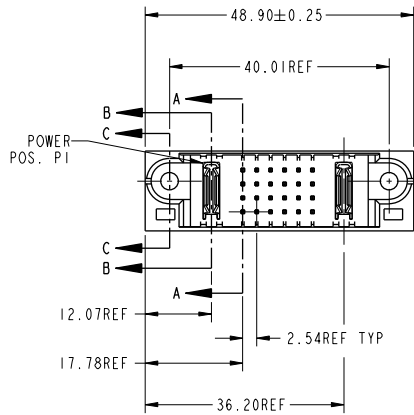
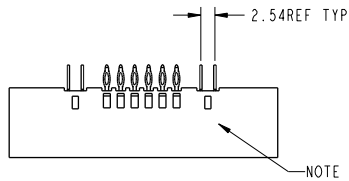

CODE	DIM "M" ±.010 [0.25]	CONTACT TYPE
G	[6.86]	SIGNAL
K	[5.59]	SIGNAL
PC	[N/A]	POWER

mat'l code				SEE NOTE	tolerances unless otherwise specified	CUSTOMER	FCI www.fciconnect.com	
lfr	ecn no.	dr	date		0.X ± 0.3	COPY		
A	V12513	DAI	10/31/01	linear	0.XX ± 0.13	projection	title IP + 24S + IP PRESS FIT VERTICAL HEADER	
B	V21104	TBA	10/01/02		0.XXX ± 0.051	MM	product family PwrBlade code 213	
C	DG05-0472	Ryan	11/17/05	angles	0° + 2°	scale	size A 51952-002 sheet 1 of 3	
D	DG07-0357	JULIA	09/10/07	dr	J. WITMER 9/19/01	1:1	cage code 22526	
				eng	J. ALLISON 9/19/01			
				chr	J. ALLISON 9/19/01			
				oppd	J. ALLISON 9/19/01			
sheet index	revision sheet	D	D	D				
		1	1	1				

Tous droits strictement réservés. Reproduction ou communication a des tiers interdite sous quelque forme que ce soit sans autorisation écrite du propriétaire. Propriété de e FCI. Droits de reproduction FCI.



All rights strictly reserved. Reproduction or issue to third parties in any form whatever is not permitted without written authority from the proprietor. Property of FCI. Copyright FCI.

PRODUCT NUMBER
51952-002...
NOTE: 3

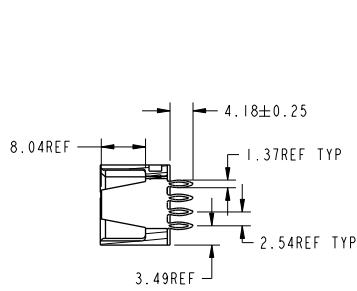

SECTION B-B

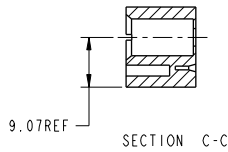

SECTION C-C

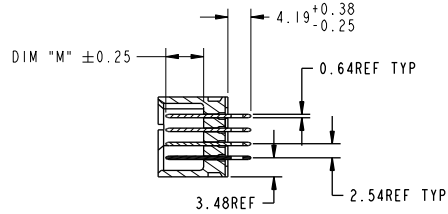

SECTION A-A

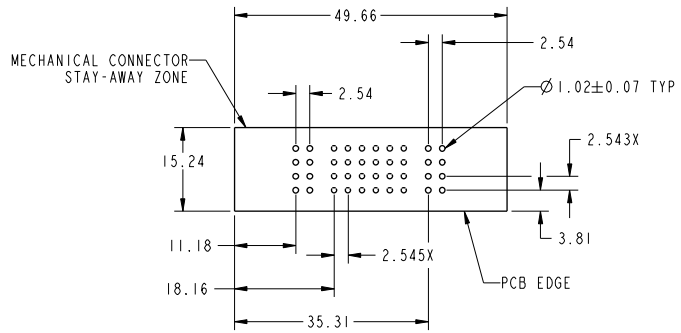

RECOMMENDED PCB LAYOUT

mat'l code				SEE NOTE		tolerances unless otherwise specified		CUSTOMER		FCI	
lfr	ecm no.	dr	date	linear	0.X ±0.3	projection	COPY	www.fciconnect.com		title	
D					0.XX ±0.13			IP + 24S + IP		PRESS FIT VERTICAL HEADER	
				angles	0.XXX ±0.051			product family		PwrBlade	
				dr	0 +2°			size	dwg no	code	213
				eng	J. WILMER 9/19/01			A	51952-002	sheet	2
				chr	J. ALLISON 9/19/01			scale		1:1	
				oppd	J. ALLISON 9/19/01			cage code		22526	
sheet index	revision sheet										

Tous droits strictement réservés. Reproduction ou communication à des tiers interdite sous quelque forme que ce soit sans autorisation écrite du propriétaire. Propriété de © FCI. Droits de reproduction FCI.



All rights strictly reserved. Reproduction or issue to third parties in any form whatever is not permitted without written authority from the proprietor. Property of FCI. Copyright FCI.

PRODUCT NUMBER
51952-002-
NOTE: 3

NOTES:

1. DIMENSIONS AND TOLERANCES ARE IN ACCORDANCE WITH ASME Y14.5M, 1994 UNLESS OTHERWISE SPECIFIED.

CONNECTOR NOTES:

- ② HOUSING MATERIAL: UL 94 V-0 GLASS FILLED
HIGH-TEMP THERMOPLASTIC
POWER CONTACT MATERIAL: COPPER ALLOY
SIGNAL PIN MATERIAL: COPPER ALLOY
 - 3. PLATING:
51952-002 ,51952-002LF PLATING SPEC. WAS SHOWN IN THE PRINT OF 10064183.
 - ④ MANUFACTURER'S NAME, P/N, AND DATE CODE TO APPEAR ON THIS SURFACE.
 - 5. PRODUCT SPECIFICATION GS-12-149.
APPLICATION SPECIFICATION BUS-20-067.
 - 6. PACKAGED IN TRAYS.
- PCB NOTES:
- 7. ALL HOLE DIAMETERS ARE FINISHED HOLE SIZE.
 - 8. MOUNTING HOLES, WHERE APPLICABLE, ARE UNPLATED.
 - ⑨ $\varnothing 1.151 \pm 0.025$ DRILLED HOLES PLATED WITH
0.008 MIN SnPb OR Sn OVER .001 [0.03]
TO 0.08 Cu PLATING TO ACHIEVE
 $\varnothing 1.02 \pm .07$ HOLE.
 - ⑩ "DIM XXX" TO BE DETERMINED BY THE CUSTOMER.
 - ⑪ CONNECTOR KEEP-OUT ZONE.
12. FOR PRESS FIT APPLICATION USE FCI CAM TOOL 430169-XXX.

mat'l code				SEE NOTE		tolerances unless otherwise specified		CUSTOMER		FCI		www.fciconnect.com	
lfr	ecn no.	dr	date	linear		0. X ± 0.3		COPY		projection	title IP + 24S + IP PRESS FIT VERTICAL HEADER		
D						0. XX ± 0.13					product family	PwrBlade	code
				angles		0. XXX ± 0.051					size	dwg no	213
				dr	J. WITMER	9/19/01				scale	A	51952-002	sheet
				eng	J. ALLISON	9/19/01				1:1			3
				chr	J. ALLISON	9/19/01							
				oppd	J. ALLISON	9/19/01							
sheet index	revision sheet												

cage code 22526

Pro/E