



Designers' Choice

SPACERS & STANDOFFS

ALUMINUM ECONOMY SPACERS

• PRECISION FORMED • NO BURRS

Made of flat strip aluminum and rolled on precision equipment. Assures maximum bearing surface, square ends.

Aluminum: Per 5052-H34 per QQ-A-250/8b

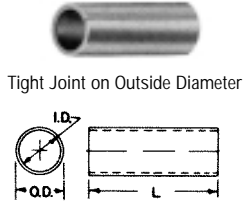

Description and Tol.

| SPACER FOR | I.D. ±.005 | O.D. ±.007 |
|------------|------------|------------|
| #4 | .125 | .167 |
| #6 | .151 | .193 |
| #8 | .178 | .232 |

| L Length | #4 Screw CAT. NO. | #6 Screw CAT. NO. | #8 Screw CAT. NO. |
|----------|-------------------|-------------------|-------------------|
| .187 | 397 | — | — |
| .250 | 398 | 405 | 412 |
| .312 | 399 | 406 | 413 |
| .375 | 400 | 407 | 414 |
| .437 | 401 | 408 | 415 |
| .500 | 402 | 409 | 416 |
| .625 | 403 | 410 | 417 |
| .750 | 418 | 425 | 432 |
| .875 | 419 | 426 | 433 |
| 1.000 | 420 | 427 | 434 |
| 1.250 | 421 | 428 | 435 |
| 1.500 | 422 | 429 | 436 |
| 1.750 | — | 430 | 437 |
| 2.000 | — | — | 438 |

BLIND CAPTIVE NUTS — PRESS FIT

MOUNT CHASSIS, PANELS, HEAT SINKS, SOCKETS

MATERIAL: Molded Nylon with Brass threaded insert.

- EASY ASSEMBLY
- DAMPENS VIBRATION
- ELIMINATES INSULATING WASHER
- HI-DIELECTRIC STRENGTH

A unique reusable fastener made of NYLON which contains a threaded brass nut. Finger pressure or light tap seals it in a pre-drilled hole. The nut is drawn up causing a Nylon bulge behind the workpiece. Screw may be removed or replaced.

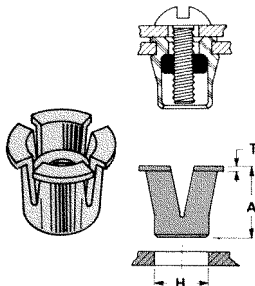

| CAT. NO. | THREAD | "H" HOLE SIZE REQ/D. | IDEAL SHEET THICKNESS | A | T |
|----------|--------|----------------------|-----------------------|------|------|
| 4341 | 4-40 | .250 | .047 | .312 | .030 |
| 4342 | 6-32 | .312 | .078 | .375 | .030 |
| 4343 | 8-32 | .406 | .093 | .500 | .030 |

METRIC HEX THREADED STANDOFFS

A comprehensive range of precision made metric hex spacers.

MATERIAL: Brass, ASTM-B16, Nickel plated (QQ-N-290)

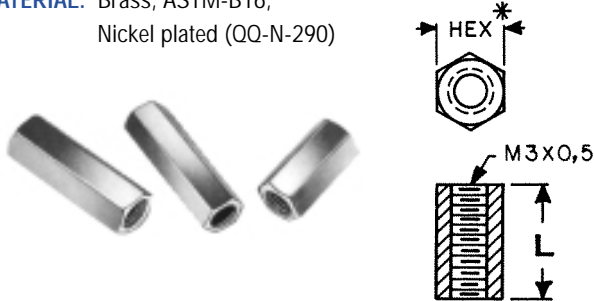

| 5mm HEX* | |
|----------|------|
| CAT. NO. | "L" |
| 4390 | 5mm |
| 4391 | 10mm |
| 4392 | 15mm |
| 4393 | 20mm |
| 4394 | 25mm |

| 5.5mm HEX* | |
|------------|------|
| CAT. NO. | "L" |
| 4395 | 5mm |
| 4396 | 10mm |
| 4397 | 15mm |
| 4398 | 20mm |
| 4399 | 25mm |

ROUND CLEAR SPACERS

BRASS OR ALUMINUM

MATERIALS:

Brass: ASTM-B16, Nickel plate (QQ-N-290)
Aluminum: Iridite Finish (MIL-C-5541)

| L LENGTH | HOLE | BRASS | ALUMINUM |
|----------|------|----------|----------|
| | | CAT. NO. | CAT. NO. |
| .125 | .120 | 1909 | 2036 |
| .250 | .120 | 1454A | 3457 |
| .375 | .120 | 1454B | 3458 |
| .500 | .120 | 1454C | 3459 |
| .625 | .120 | 1919 | 2314 |
| .750 | .120 | 1454D | 3460 |
| .875 | .120 | 1920 | 3402 |
| 1.000 | .120 | 1545E | 3461 |
| 1.500 | .120 | 1924 | 3462 |
| 2.000 | .120 | 1925 | 3463 |
| .125 | .140 | 1934 | 3403 |
| .250 | .140 | 1457A | 3464 |
| .375 | .140 | 1457B | 3465 |
| .500 | .140 | 1457C | 3466 |
| .625 | .140 | 1935 | 3429 |
| .750 | .140 | 1957D | 3467 |
| .875 | .140 | 1936 | 3438 |
| 1.000 | .140 | 1457E | 3468 |
| 1.500 | .140 | 1937 | 3469 |
| 2.000 | .140 | 1938 | 3470 |
| .125 | .171 | 1942 | 4258 |
| .250 | .171 | 1480 | 3471 |
| .375 | .171 | 1481 | 3472 |
| .500 | .171 | 1482 | 3473 |
| .625 | .171 | 2032 | 4259 |
| .750 | .171 | 1483 | 3474 |
| .875 | .171 | 2033 | 4260 |
| 1.000 | .171 | 1484 | 3475 |
| 1.500 | .171 | 2034 | 3476 |
| 2.000 | .171 | 2035 | 3477 |

CLEARANCE HOLE:

- .120 for #4 screw
- .140 for #6 screw
- .171 for #8 screw

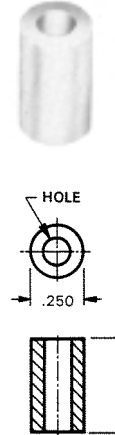

ROUND SWAGE CLEAR SPACERS

MATERIAL: Brass, ASTM-B16, Nickel plate (QQ-N-290)

CLEARANCE HOLE:

- .120 for #4 screw
- .140 for #6 screw

| CAT. NO. | H HEIGHT | FOR PANEL THICKNESS | C HOLE | L |
|----------|----------|---------------------|--------|------|
| 5060-2 | .250 | 1/16 | .120 | .109 |
| 5060-3 | .250 | 3/32 | .120 | .141 |
| 5061-2 | .375 | 1/16 | .120 | .109 |
| 5061-3 | .375 | 3/32 | .120 | .141 |
| 5062-2 | .500 | 1/16 | .120 | .109 |
| 5062-3 | .500 | 3/32 | .120 | .141 |
| 5063-2 | .250 | 1/16 | .140 | .109 |
| 5063-3 | .250 | 3/32 | .140 | .141 |
| 5064-2 | .375 | 1/16 | .140 | .109 |
| 5064-3 | .375 | 3/32 | .140 | .141 |
| 5065-2 | .500 | 1/16 | .140 | .109 |
| 5065-3 | .500 | 3/32 | .140 | .141 |

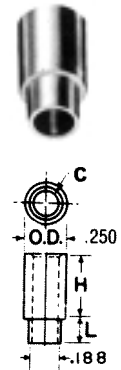

HEX STAINLESS THREADED STANDOFFS

MATERIAL: Stainless Steel per ASTM-A581/A582, Class 303

• Corrosion Resistant

| L Length Inches | 4-40 Thread CAT. NO. | 6-32 Thread CAT. NO. | 8-32 Thread CAT. NO. |
|-----------------|----------------------|----------------------|----------------------|
| 1/4 (.250) | 1921 | 1922 | 1923 |
| 3/8 (.375) | 1921A | 1922A | 1923A |
| 1/2 (.500) | 1921B | 1922B | 1923B |
| 3/4 (.750) | 1921C | 1922C | 1923C |
| 1 (1.000) | 1921D | 1922D | 1923D |
| 1 1/2 (1.500) | 1921E | 1922E | 1923E |
| 2 (2.000) | 1921F | 1922F | 1923F |

- 4-40 thread on 1/2" and over tapped 1/4" each end
- 6-32 & 8-32 thread on 1" and over tapped 3/8" each end

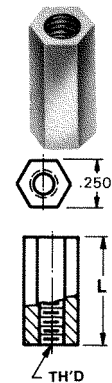



Designers' Choice

INSULATED SPACERS/STANDOFFS

CERAMIC STANDOFFS

- Ideal for very high temperature conditions
- Commercial and military types available
- Special sizes available upon request
- Exceptional strength in compression and tension
- Withstands very high voltage without flashover.
- Military types meet MIL-1-010, NL# clearly marked

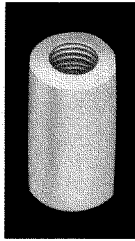
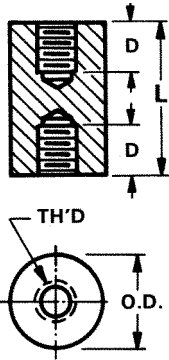

COMMERCIAL

| CAT. NO. | LENGTH | O.D. | T THREAD | D(2) DEPTH |
|----------|--------|------|----------|------------|
| 7710 | .250 | .250 | 6-32 | THRU |
| 7711 | .500 | .250 | 6-32 | .156 |
| 7712 | .375 | .375 | 6-32 | .156 |
| 7713 | .500 | .375 | 6-32 | .187 |
| 7714 | .500 | .500 | 6-32 | .140 |
| 7715 | .750 | .500 | 6-32 | .250 |
| 7716 | 1.000 | .500 | 6-32 | .375 |
| 7717 | 1.500 | .500 | 6-32 | .562 |
| 7718 | 2.500 | .500 | 6-32 | .500 |
| 7719 | 2.500 | .750 | 1/4-20 | .750 |
| 7720 | 4.000 | .750 | 1/4-20 | .750 |

MILITARY

| CAT. NO. | LENGTH | O.D. | T THREAD | D(2) DEPTH | NL # |
|----------|--------|-------|----------|------------|--------------|
| 7661 | .500 | .375 | 6-32 | .156 | NL523W01-004 |
| 7662 | .625 | .375 | 6-32 | .250 | NL523W01-005 |
| 7663 | .625 | .500 | 8-32 | .187 | NL523W02-005 |
| 7664 | .750 | .375 | 6-32 | .250 | NL523W01-006 |
| 7665 | .750 | .500 | 8-32 | .250 | NL523W02-006 |
| 7666 | 1.000 | .375 | 10-32 | .375 | NL523W01-008 |
| 7667 | 1.000 | .500 | 8-32 | .375 | NL523W02-008 |
| 7668 | 1.000 | .750 | 10-32 | .375 | NL523W03-008 |
| 7669 | 1.250 | .375 | 6-32 | .375 | NL523W01-010 |
| 7670 | 1.250 | .500 | 8-32 | .375 | NL523W02-010 |
| 7671 | 1.250 | 1.000 | 1/4-20 | .437 | NL523W04-010 |
| 7672 | 1.500 | .375 | 6-32 | .375 | NL523W01-012 |
| 7673 | 1.500 | .500 | 8-32 | .375 | NL523W02-012 |
| 7674 | 1.500 | .750 | 10-32 | .375 | NL523W03-012 |
| 7675 | 1.500 | 1.000 | 1/4-20 | .500 | NL523W04-012 |
| 7676 | 2.000 | .375 | 6-32 | .375 | NL523W01-016 |
| 7677 | 2.000 | .500 | 8-32 | .375 | NL523W02-016 |
| 7678 | 2.000 | .750 | 10-32 | .375 | NL523W03-016 |

MATERIAL: Grade L5 Ceramic

PHENOLIC SPACERS/STANDOFFS

- RESISTS ABRASIONS & CHEMICALS • EXCELLENT DIELECTRIC STRENGTH
- LOW MOISTURE ABSORPTION • GOOD MECHANICAL STRENGTH

MATERIAL: PBE Grade Natural Color Phenolic

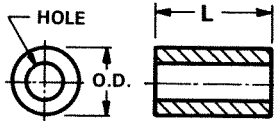
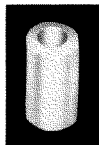

CLEAR HOLE SPACERS

| "L" Length Inches | .250 O.D. (1/4) | | | .312 O.D. |
|-------------------|-----------------------------|-----------------------------|-----------------------------|------------------------------|
| | #4 Screw .120 Hole CAT. NO. | #6 Screw .140 Hole CAT. NO. | #8 Screw .171 Hole CAT. NO. | #10 Screw .200 Hole CAT. NO. |
| 1/4 (.250) | 360 | 367 | 1490 | 453 |
| 3/8 (.375) | 361 | 368 | 1491 | 454 |
| 1/2 (.500) | 362 | 369 | 1492 | 455 |
| 3/4 (.750) | 363 | 370 | 1493 | 456 |
| 1 (1.000) | 364 | 371 | 1494 | 457 |
| 1 1/2 (1.500) | 365 | 372 | 374 | 458 |
| 2 (2.000) | 366 | 373 | 375 | 459 |

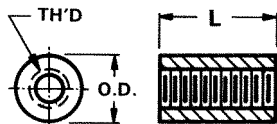
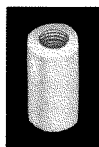

THREADED STANDOFFS

| "L" Length Inches | .250 O.D. (1/4) | | | .312 O.D. | |
|-------------------|--------------------|--------------------|--------------------|---------------|----------------|
| | 4-40 Th'd CAT. NO. | 6-32 Th'd CAT. NO. | 8-32 Th'd CAT. NO. | 8-32 CAT. NO. | 10-32 CAT. NO. |
| 1/4 (.250) | 376 | 383 | 390 | 460 | 467 |
| 3/8 (.375) | 377 | 384 | 391 | 461 | 468 |
| 1/2 (.500) | 378 | 385 | 392 | 462 | 469 |
| 3/4 (.750) | 379 | 386 | 393 | 463 | 470 |
| 1 (1.000) | 380 | 387 | 394 | 464 | 471 |
| 1 1/2 (1.500) | 381 | 388 | 395 | 465 | 472 |
| 2 (2.000) | 382 | 389 | 396 | 466 | 473 |

NOTE: 1 1/2" and 2" spacers are tapped 3/8" deep each end.

NYLON SPACERS/STANDOFFS

Economical for terminal or printed circuit board supports.

ROUND THRU-HOLE SPACERS

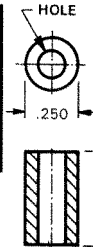
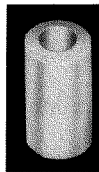

| "L" Length Inches | #4 Screw .120 Hole CAT. NO. | #6 Screw .140 Hole CAT. NO. | #8 Screw .171 Hole CAT. NO. |
|-------------------|-----------------------------|-----------------------------|-----------------------------|
| 1/8 (.125) | 875 | 883 | 891 |
| 1/4 (.250) | 876 | 884 | 892 |
| 3/8 (.375) | 877 | 885 | 893 |
| 1/2 (.500) | 878 | 886 | 894 |
| 5/8 (.625) | 879 | 887 | 895 |
| 3/4 (.750) | 880 | 888 | 896 |
| 7/8 (.875) | 881 | 889 | 897 |
| 1 (1.000) | 882 | 890 | 898 |

MATERIAL: Nylon 6/6

HEX THREADED STANDOFFS

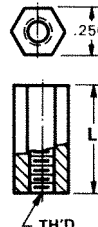
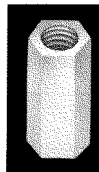

| "L" Length Inches | 4-40 Thread CAT. NO. | 6-32 Thread CAT. NO. | 8-32 Thread CAT. NO. |
|-------------------|----------------------|----------------------|----------------------|
| 1/4 (.250) | 1902A | 1903A | 1904A |
| 3/8 (.375) | 1902B | 1903B | 1904B |
| 1/2 (.500) | 1902C | 1903C | 1904C |
| 5/8 (.625) | 1902F | 1903F | 1904F |
| 3/4 (.750) | 1902D | 1903D | 1904D |
| 7/8 (.875) | 1902G | 1903G | 1904G |
| 1 (1.000) | 1902E | 1903E | 1904E |

MATERIAL: Nylon 6/6

FLAME RETARDANT HEX THREADED STANDOFFS

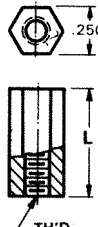
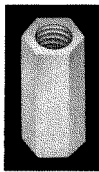

| "L" Length Inches | 4-40 Thread CAT. NO. | 6-32 Thread CAT. NO. | 8-32 Thread CAT. NO. |
|-------------------|----------------------|----------------------|----------------------|
| 1/4 (.250) | 8440A | 8441A | 8442A |
| 3/8 (.375) | 8440B | 8441B | 8442B |
| 1/2 (.500) | 8440C | 8441C | 8442C |
| 5/8 (.625) | 8440D | 8441D | 8442D |
| 3/4 (.750) | 8440E | 8441E | 8442E |
| 7/8 (.875) | 8440F | 8441F | 8442F |
| 1 (1.000) | 8440G | 8441G | 8442G |

MATERIAL: Nylon 6/6