

Tous droits strictement réservés. Reproduction ou communication à des tiers interdite sous quelque forme que ce soit sans autorisation écrite du propriétaire. Propriété de c FCI. Droits de reproduction FCI.

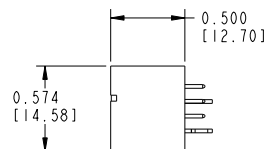

All rights strictly reserved. Reproduction or issue to third parties in any form whatever is not permitted without written authority from the proprietor. Property of FCI. Copyright FCI.

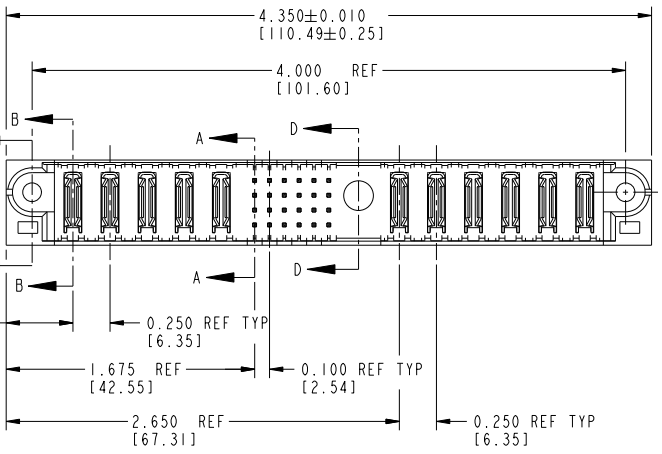
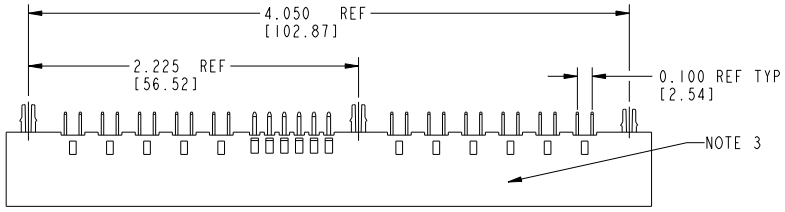
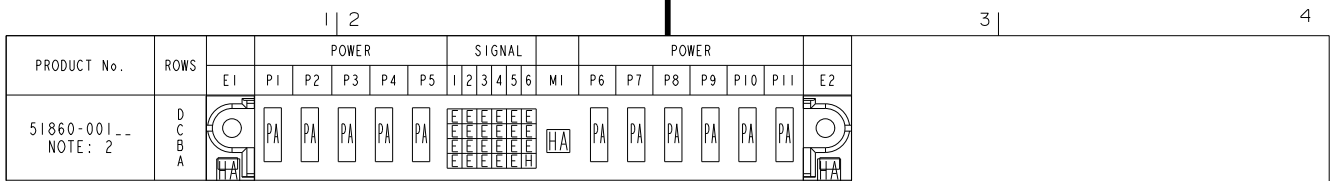

CODE	DIM "M" ±.010 [0.25]	CONTACT TYPE
E	0.270 [6.86]	SIGNAL
H	0.220 [5.59]	SIGNAL
PA	[N/A] [N/A]	POWER
HA	N/A [N/A]	HOLD-DOWN

NOTE 1				tolerances unless otherwise specified		CUSTOMER	
ltr	ecr no.	dr	date	linear	XX±.01/0.XX±0.3	COPY	
A	V11839	JRW	07/06/01	linear	XXX±.005/0.XX±0.13	projection	
B	V12513	DAI	10/18/01	linear	XXX±.0020/0.XX±0.051	INCH/MM	
C	V21104	TAB	09/30/02	angles	0°±?	scale	
D	DG05-0530	GuoJM	12/09/05	dr	C. DAILY 03/08/01	1:1	
E	DG08-0251	W D	09/16/08	engr	E. TREECE 03/07/01	A	
				chr	E. TREECE 03/08/01		
				appd	E. TREECE 03/08/01		

CUSTOMER		FCI	
www.fciconnect.com		www.fciconnect.com	
title		5P + 24S + 1M + 6P	
product family		PWRBLADE	
size		dwg no	
A		51860	
code		213	
sheet		1 of 3	

sheet index	revision	E	E	E
1	2	3		

Pro/E

PDM: Rev: E

STATUS: Released

Printed: Dec 20, 2010

Tous droits strictement réservés. Reproduction ou communication à des tiers interdite sous quelque forme que ce soit sans autorisation écrite du propriétaire. Propriété de c FCI. Droits de reproduction FCI.



All rights strictly reserved. Reproduction or issue to third parties in any form whatever is not permitted without written authority from the proprietor. Property of FCI. Copyright FCI.

PRODUCT NUMBER  
51860-001--  
NOTE: 2

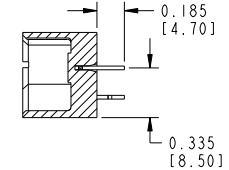
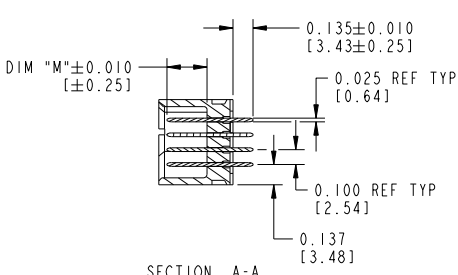
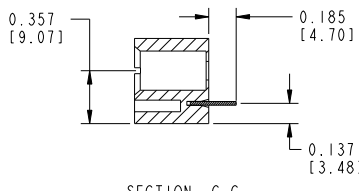
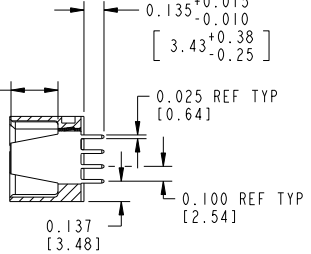
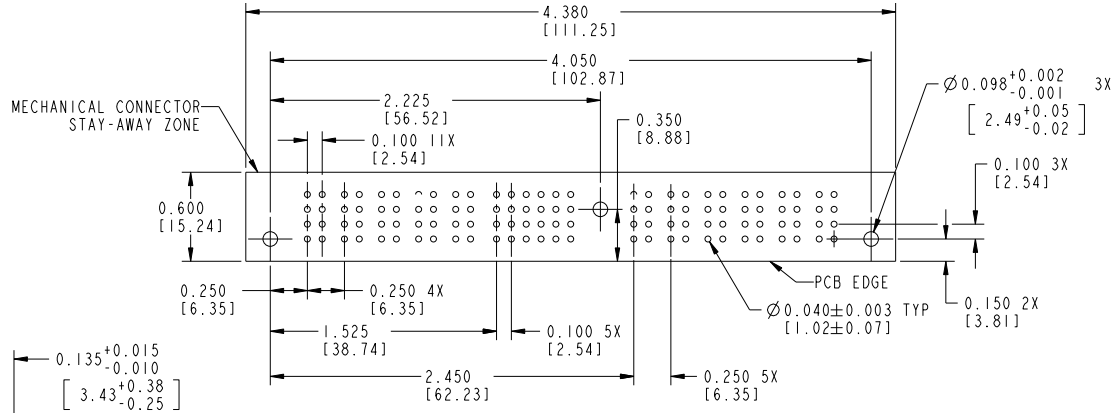

NOTE 1				tolerances unless otherwise specified	CUSTOMER	www.fciconnect.com
lfr	ecr no.	dr	date	linear	COPY	
E				angles	projection	product family PWRBLADE code 213
				dr	INCH/MM	size dwg no 51860 sheet 2
				engr	scale 1:1	
				chr		
				appd		
sheet index	revision sheet					

Pro/E

PDM: Rev: E

STATUS: Released

Printed: Dec 20, 2010

Tous droits strictement réservés. Reproduction ou communication à des tiers interdite sous quelque forme que ce soit sans autorisation écrite du propriétaire. Propriété de c FCI. Droits de reproduction FCI.



All rights strictly reserved. Reproduction or issue to third parties in any form whatever is not permitted without written authority from the proprietor. Property of FCI. Copyright FCI.

PRODUCT NUMBER  
51860-001--  
NOTE: 2

CONNECTOR NOTES:

1. HOUSING MATERIAL: UL 94 V-0 GLASS FILLED HIGH TEMP THERMOPLASTIC  
POWER CONTACT MATERIAL: COPPER ALLOY  
SIGNAL CONTACT MATERIAL: COPPER ALLOY
2. SEE ITEM 1 & 2 IN PRINT 10064183 FOR PLATING SPEC OF 51860-001 AND 51860-001LF RESPECTIVELY.
3. "MANUFACTURER'S" NAME, P/N, AND DATE CODE TO APPEAR ON THIS SURFACE
4. PRODUCT SPECIFICATION GS-12-149
5. DIMENSIONS AND TOLERANCES ARE IN ACCORDANCE WITH ASME Y14.5M, 1994 UNLESS OTHERWISE SPECIFIED.

PCB NOTES:

6. ALL DIMENSIONS ARE BASIC UNLESS OTHERWISE SPECIFIED.
7. ALL THROUGH HOLES ARE LOCATED WITH A TRUE POSITION OF 0.004 [0.10]
8. ALL HOLE DIAMETERS ARE FINISHED HOLE SIZE
9.  $\varnothing 0.098 [2.41]$  THROUGH HOLES ARE UNPLATED.
10.  $\varnothing 0.0453 \pm 0.0010 [1.151 \pm 0.025]$  DRILLED HOLES PLATED WITH 0.0003 [0.008] MIN SnPb OVER 0.001 [0.03] TO 0.003 [0.08] Cu PLATING TO ACHIEVE A  $\varnothing 0.040 \pm 0.003 [1.02 \pm 0.07]$  HOLE.
11. A  $\Delta$  SYMBOL WILL BE NEXT TO ANY DIMENSION, VIEW, OR NOTE WHICH HAS BEEN MODIFIED WITH THE CURRENT DRAWING REVISION.

mat'l code		NOTE 1		tolerances unless otherwise specified		CUSTOMER		FCJ		www.fciconnect.com	
lfr	ecr no.	dr	date	linear	.XX±.01/0.XX±0.3	COPY		projection		title	
E					.XXX±.005/0.XX±0.13	INCH/MM				5P + 24S + 1M + 6P VERTICAL SOLDER HEADER	
				angles	.XXX±.002/0.XX±0.051	←		product family		code	
				dr	0° ± 2°	←		PWRBLADE		213	
				engr	C. DAILY 03/08/01	←		size		sheet	
				chr	E. TREECE 03/07/01	←		A		3	
				appd	E. TREECE 03/08/01	←		51860			
sheet index	revision sheet										

1 | 2

Pro/E

PDM: Rev: E

STATUS: Released

Printed: Dec 20, 2010