

13 12 11 10 9 8 7 6 5 4 3 2 1

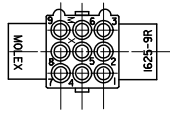

OPTIONAL MOUNTING EARS  
SEE DETAIL 3 OR 4  
FOR VERSIONS AVAILABLE

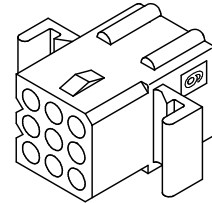
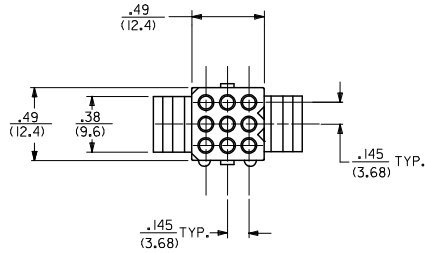
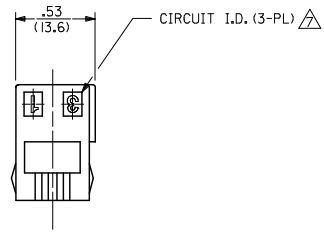
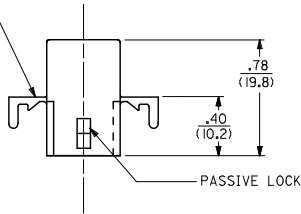
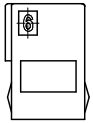

RECEPTACLE

UPDATE REV. LEVEL EC NO. UCP200-0585 DRAWN: RBENES 2009/09/04 CHKD: 2009/09/10 APPR: SMITH 2009/09/15	QUALITY SYMBOLS ◻=0 ◻=0	GENERAL TOLERANCES (UNLESS SPECIFIED)		DIMENSION STYLE		SCALE	DESIGN UNITS	THIRD ANGLE PROJECTION		
			mm	INCH	IN/MM		1:1	INCH		
		4 PLACES	±---	±---	DRAWN BY	DATE	TITLE			
		3 PLACES	±---	±.010	JJS	1988/02/05	.062/(157) HOUSINGS, PLUG AND RECEPTACLE, 9 CKT., .145/(3.68) CTRS.			
	2 PLACES	±0.25	±.014	CHECKED BY	DATE	MATERIAL NO.				
	1 PLACE	±0.36	±---	RW	1988/02/05	DOCUMENT NO.				
	ANGULAR		±1/2°	APPROVED BY	DATE	MOLEX INCORPORATED		SHEET NO.		
				RAS	1988/02/05			2 OF 3		
DRAFT WHERE APPLICABLE MUST REMAIN WITHIN DIMENSIONS		SEE CHART		SD-1625-9*						
THIS DRAWING CONTAINS INFORMATION THAT IS PROPRIETARY TO MOLEX INCORPORATED AND SHOULD NOT BE USED WITHOUT WRITTEN PERMISSION										

lb\_frame\_C.P.M.E.T  
Rev. E 2006/04/15

12 11 10 9 8 7 6 5 4 3 2 1

PLUG	
PART NO.	ENG. NO.
03-06-2091	I625-9P
03-06-2092	I625-9P1
23-06-2091	I625-9P-C
23-06-2092	I625-9P1-C
04-06-6091	I625-9P1-B
03-06-7091	I625-9PBK
03-06-7092	I625-9PIBK
	<b>OBSELETE</b>

RECEPTACLE	
PART NO.	ENG. NO.
03-06-1091	I625-9R
03-06-1092	I625-9R1
23-06-1091	I625-9R-C
23-06-1092	I625-9R1-C
03-06-6091	I625-9RBK
03-06-6092	I625-9R1BK
50-36-1871	I625-9R4
50-36-1872	I625-9R4-C

**LEGEND:**

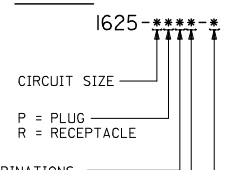

MOUNTING EAR & DETENT COMBINATIONS:  
 BLANK=PLUG OR RECEPTACLE WITH STANDARD EARS  
 1=PLUG OR RECEPTACLE WITHOUT EARS  
 4=PLUG OR RECEPTACLE WITH PREBENT EARS

BLANK = NATURAL COLOR  
 AM = AMBER BK = BLACK BU = BLUE  
 BN = BROWN GY = GRAY GN = GREEN  
 OR = ORANGE RD = RED YW = YELLOW

MATERIAL: A=MATERIAL CODE A  
 B=MATERIAL CODE B  
 C=MATERIAL CODE C

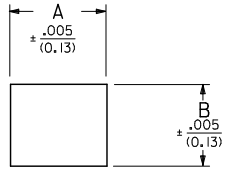
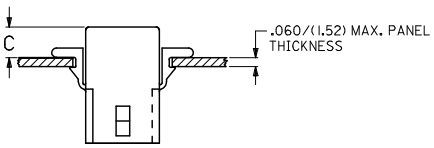

RECEP.	.650 (16.51)	.552 (14.02)	.21 (5.3)	.22 (5.6)
PLUG	.752 (19.10)	.615 (15.62)	.20 (5.1)	.21 (5.3)
PART	DIM. A	DIM. B	DIM. C (STANDARD EAR)	DIM. C (PREBENT EAR)

**RECOMMENDED HOLE PATTERN**

- NOTES:
- MATERIAL CODES:  
 A-NYLON TYPE 6/6, 94V-2  
 B-NYLON TYPE 6/6, 94V-0  
 C-POLYPROPYLENE, 94V-0
  - FINISH: NONE
  - PRODUCT SPECIFICATION: PS-02-06
  - PACKAGING SPECIFICATION: PK-1625-001
  - HOUSINGS OF USE WITH MOLEX .062 DIAMETER TERMINALS.
- △ SOME PARTS MAY HAVE THIS CORNER CHAMFERED.
- △ ETCHED CIRCUIT I.D. NUMBERS ON HOUSING MAY OR MAY NOT BE PRESENT.
- PARTS CONFORM TO CLASS B REQUIREMENTS OF COSMETIC SPECIFICATION PS-45499-002.

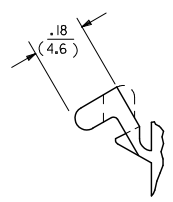
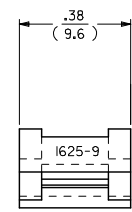
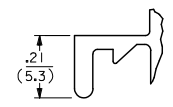

**DETAIL 3**  
STANDARD MOUNTING EAR  
(SCALE 4:1)

**DETAIL 4**  
PREBENT MOUNTING EAR  
(SCALE 4:1)

RE-INSTATE 1625-9R EC NO. UCP2010-0585 DRAWN: BRENNES 2009/09/04 CHKD: BELL 2009/09/10 APPR: SMITH 2009/09/15	QUALITY SYMBOLS ▽=0 ▽=0	GENERAL TOLERANCES (UNLESS SPECIFIED) mm INCH 4 PLACES ±--- ±--- 3 PLACES ±--- ±.010 2 PLACES ±0.25 ±.014 1 PLACE ±0.36 ±--- ANGULAR ± 1°		DIMENSION STYLE IN/MM DRAWN BY: JJS DATE: 1988/02/12 CHECKED BY: RW DATE: 1988/02/12 APPROVED BY: RAS DATE: 1988/02/12		SCALE 1:1 DESIGN UNITS INCH THIRD ANGLE PROJECTION	TITLE .062/(1.57) HOUSINGS, PLUG AND RECEPTACLE, 9 CKT., .145/(3.68) CTRS	
		DRAFT WHERE APPLICABLE MUST REMAIN WITHIN DIMENSIONS		SEE CHART		MATERIAL NO. SD-1625-9* DOCUMENT NO.	MOLEX INCORPORATED SHEET NO. 3 OF 3	