



## PLC2S-S6-C



- For indoor use
- Used to secure a cable bundle to another surface such as a control panel, communication rack, wall or ceiling
- Design allows for bundling before or after screwing clamp in place
- One-piece construction for consistent performance and reliability
- Curved tip is easy to pick up from flat surfaces and allows faster initial threading to speed installation

|                                     |   |
|-------------------------------------|---|
| ▪ Part Number                       | PLC2S-S6-C                              |
| ▪ RoHS Compliancy Status            | Compliant                               |
| ▪ Part Description                  | Clamp Tie, 7.9", Standard cross section |
| ▪ Product Type                      | Cable Ties                              |
| ▪ Material                          | Nylon 6.6                               |
| ▪ Color                             | Natural                                 |
| ▪ CSA Certified                     | Yes                                     |
| ▪ UL Listed (File #E56854)          | Yes                                     |
| ▪ UL Recognized (File #E56854)      | Yes                                     |
| ▪ Length (In.)                      | 7.9                                     |
| ▪ Length (mm)                       | 201                                     |
| ▪ Width (In.)                       | .190                                    |
| ▪ Width (mm)                        | 4.8                                     |
| ▪ Boss Height (In.)                 | .160                                    |
| ▪ Boss Height (mm)                  | 4.1                                     |
| ▪ Boss Width (In.)                  | .373                                    |
| ▪ Boss Width (mm)                   | 9.5                                     |
| ▪ CE Compliant                      | Yes                                     |
| ▪ Cross Section                     | Standard                                |
| ▪ Locking Style                     | Locking                                 |
| ▪ Material Flammability Rating      | UL 94V-2                                |
| ▪ Max. Bundle Diameter (In.)        | 1.84                                    |
| ▪ Max. Bundle Diameter (mm)         | 47                                      |
| ▪ Max. Continuous Use Temperature   | 185°F (85°C)                            |
| ▪ Min. Loop Tensile Strength (Lbs.) | 50                                      |
| ▪ Min. Loop Tensile Strength (N)    | 222                                     |

|                               |   |
|-------------------------------|---|
| ▪ Nominal Hole Diameter (In.) | .148  |
| ▪ Nominal Hole Diameter (mm)  | 3.8   |
| ▪ Pricing Description         | Clamp Tie, 7.9"L (201mm), #6 (M3) Screw, Standard, Nylon, Natural |
| ▪ Screw Size                  | #6  |
| ▪ Screw Size Metric           | M3  |
| ▪ Thickness (In.)             | .047  |
| ▪ Thickness (mm)              | 1.2   |
| ▪ Tool                        | GTS, GTSL, GS2B, GTH, GS4H, PTS, PTH, PPTS, STS2, STH2            |
| ▪ Min. Order UOM              | PC  |
| ▪ Min. Order Qty.             | 100   |
| ▪ BOM Qty. (# of Pkgs.)       |   |

THIS COPY IS PROVIDED ON A RESTRICTED BASIS AND IS NOT TO BE USED IN ANY WAY DETRIMENTAL TO THE INTERESTS OF PANDUIT CORP.

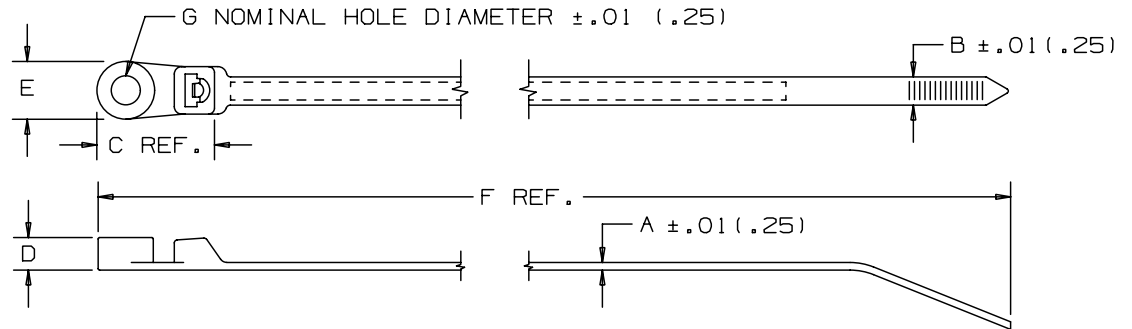
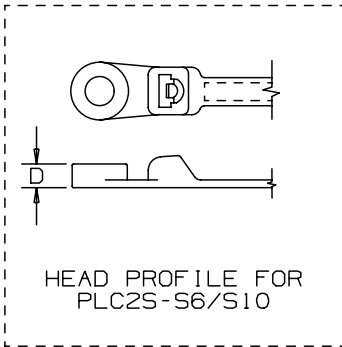

| PANDUIT PART NO. * | BUNDLE DIA.  |              | A In (mm)  | B In (mm)  | C In (mm)   | D In (mm)  | E In (mm)  | F In (mm)   | G In (mm)  | MIN. LOOP TENSILE lbs (N) | CROSS-SECTION | RECM. FASTENER  | WEIGHT lbs/100pcs (g) |
|--------------------|--------------|--------------|------------|------------|-------------|------------|------------|-------------|------------|---------------------------|---------------|-----------------|-----------------------|
|                    | MIN. In (mm) | MAX. In (mm) |            |            |             |            |            |             |            |                           |               |                 |                       |
| PLC1M-S4           | .06 (1.5)    | .75 (19)     | .045 (1.1) | .100 (2.5) | .542 (13.8) | .153 (3.9) | .239 (6.1) | 4.3 (109.2) | .122 (3.1) | 18 (80)                   | MINIATURE     | #4 (M2.5) SCREW | .08 (36)              |
| PLC1.5I-S8         | .06 (1.5)    | 1.25 (32)    | .045 (1.1) | .135 (3.4) | .694 (17.6) | .166 (4.2) | .335 (8.5) | 6.1 (154.9) | .174 (4.4) | 40 (178)                  | INTERMEDIATE  | #8 (M4) SCREW   | .18 (82)              |
| PLC2S-S6           | .06 (1.5)    | 1.84 (47)    | .047 (1.2) | .190 (4.8) | .765 (19.4) | .180 (4.1) | .373 (9.5) | 7.9 (200.7) | .148 (3.8) | 50 (222)                  | STANDARD      | #6 (M3) SCREW   | .32 (145)             |
| PLC2S-S10          | .06 (1.5)    | 1.84 (47)    | .047 (1.2) | .190 (4.8) | .765 (19.4) | .180 (4.1) | .373 (9.5) | 7.9 (200.7) | .200 (5.1) | 50 (222)                  | STANDARD      | #10 (M5) SCREW  | .32 (145)             |
| PLC3S-S10          | .06 (1.5)    | 3.00 (76)    | .052 (1.3) | .190 (4.8) | .765 (19.4) | .220 (5.6) | .373 (9.5) | 12 (304.8)  | .200 (5.1) | 50 (222)                  | STANDARD      | #10 (M5) SCREW  | .50 (227)             |
| PLC4S-S10          | .06 (1.5)    | 4.00 (102)   | .052 (1.3) | .190 (4.8) | .765 (19.4) | .220 (5.6) | .373 (9.5) | 15 (381.0)  | .200 (5.1) | 50 (222)                  | STANDARD      | #10 (M5) SCREW  | .59 (268)             |

NOTES:

- \*1) SEE CURRENT PRICE SHEET FOR PART NUMBER SUFFIX DESIGNATION FOR PACKAGE SIZE AND PART COLOR
- 2) RECOGNIZED UNDER THE COMPONENT PROGRAM OF UNDERWRITERS LABORATORIES INC.

SS-2724-18.PRT

CAD FILENAME/LAYERS  
DIMENSIONS IN PARENTHESES ARE IN METRIC UNITS

PANDUIT CORP. TINLEY PARK, ILLINOIS

PAN-TY LOCKING CLAMP TIE  
PLC SERIES

UNLESS OTHERWISE SPECIFIED,  
DIMENSIONAL TOLERANCES ARE:  
(.X) ± .005 (XXX) ± .020 (.51)  
(.XX) ± .02 (.5) ANGLES ± .005

UNLESS OTHERWISE SPECIFIED,  
ALL DIMENSIONS ARE GIVEN  
IN INCHES, THIRD ANGLE PROJECTION.

| REV | DATE    | BY  | CHK | DESCRIPTION   | ECN  | R  | CUST | SUP | DRAWN BY | DATE    | CHK'D | MAT'L     | SCALE | DWG NO. | DWG SIZE |
|-----|---------|-----|-----|---|------|----|------|-----|----------|---------|-------|-----------|-------|---------|----------|
| --  | -----   | --- |     | CHANGED MAX. BUNDLE DIA. METRIC NUMBERS TO WHOLE NUMBERS          | ---- | -- |      |     | L.V./AJC | 2-11-71 | HVP   | NYLON 6.6 | NONE  | SS-2724 | A        |
| 18  | 5/31/05 | ERW |     | CHANGED DIMENSION 'G' FROM A TOLERANCE TO A NOMINAL HOLE DIAMETER | 2724 | 18 |      |     |          |         |       |           |       |         |          |