

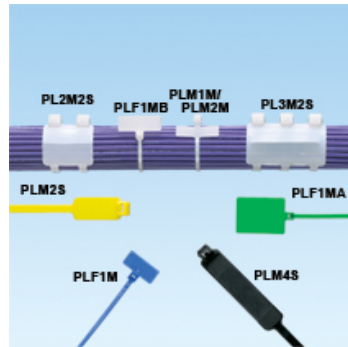

PLF1M-C



- For indoor use
- Used to fasten and identify bundles at the same time
- One-piece construction for consistent performance and reliability
- Can be marked with *PANDUIT* marker pens or custom imprinted with text, symbols, or trademarks available using *PANDUIT* Custom Hot Stamping Service
- Curved tip is easy to pick up from flat surfaces and allows faster initial threading to speed installation

• Part Number	PLF1M-C
• RoHS Compliancy Status	Compliant
• Part Description	Marker Tie, Flag, 4.3", Miniature cross section
• Product Type	Cable Ties
• Material	Nylon 6.6
• Color	Natural
• CSA Certified	Yes
• UL Listed (File #E56854)	No
• UL Recognized (File #E56854)	Yes
• Length (In.)	4.3
• Length (mm)	109
• Width (In.)	.098
• Width (mm)	2.5
• CE Compliant	Yes
• Cross Section	Miniature
• Head Height (In.)	.154
• Head Height (mm)	3.9
• Head Width (In.)	.180
• Head Width (mm)	4.6
• Locking Style	Locking
• Marker Type	Flag
• Marker Write-On Area (In.)	.31 x .75
• Marker Write-On Area (mm)	7.9 x 19.1
• Material Flammability Rating	UL 94V-2
• Max. Bundle Diameter (In.)	.87
• Max. Bundle Diameter (mm)	22

• Max. Continuous Use Temperature	185°F (85°C)
• Min. Loop Tensile Strength (Lbs.)	18
• Min. Loop Tensile Strength (N)	80
• Pricing Description	Marker Tie, Flag, 4.3"L (109mm), Miniature, Nylon, Natural
• Thickness (In.)	.045
• Thickness (mm)	1.1
• Tool	GTS, GTSL, GS2B, PTS, PPTS, STS2
• Min. Order UOM	PC
• Min. Order Qty.	100
• BOM Qty. (# of Pkgs.)	

THIS COPY IS PROVIDED ON A RESTRICTED BASIS AND IS NOT TO BE USED IN ANY WAY DETRIMENTAL TO THE INTERESTS OF PANDUIT CORP.

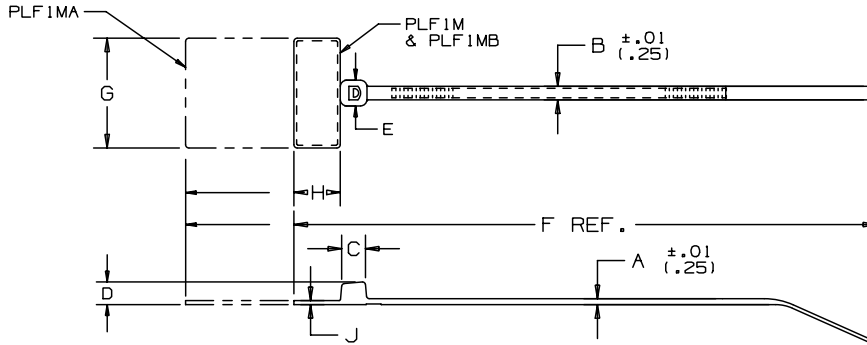

PANDUIT * PART NO.	BUNDLE DIA.		A IN. (mm)	B IN. (mm)	C IN. (mm)	D IN. (mm)	E IN. (mm)	F IN. (mm)	G IN. (mm)	H IN. (mm)	J IN. (mm)	WRITE-ON AREA IN. (mm)	MINIMUM LOOP TENSILE lbs. (N)	CROSS-SECTION	WEIGHT LBS/100 (G)
	MIN. (mm)	MAX. (mm)													
PLF1M	.06 (1.5)	.87 (22.1)	.045 (1.1)	.098 (2.5)	.177 (4.5)	.154 (3.9)	.180 (4.6)	4.3 (109)	.812 (20.6)	.366 (9.3)	.028 (.71)	.31 X .75 (7.9 X 19.1)	18 (80)	MINIATURE	.10 (46)
PLF1MA	.06 (1.5)	.87 (22.1)	.045 (1.1)	.098 (2.5)	.177 (4.5)	.154 (3.9)	.180 (4.6)	5.1 (130)	.812 (20.6)	1.10 (28.)	.028 (.71)	.76 X 1.04 (19.1 X 26.4)	18 (80)	MINIATURE	.16 (73)
PLF1MB	.06 (1.5)	.75 (19)	.045 (1.1)	.098 (2.5)	.177 (4.5)	.154 (3.9)	.180 (4.6)	3.98 (101)	.980 (24.9)	.366 (9.3)	.028 (.71)	.31 X .92 (7.9 X 23.4)	18 (80)	MINIATURE	.10 (46)

NOTES:

- * SEE CURRENT PRICE SHEET FOR PART NUMBER SUFFIX DESIGNATION FOR PACKAGE SIZE AND PART COLOR.
- RECOGNIZED UNDER THE COMPONENT PROGRAM OF UNDERWRITERS LABORATORIES INC.

										DIMENSIONS IN PARENTHESES ARE IN METRIC UNITS						
										<h1>PANDUIT</h1> <p>CORP. TINLEY PARK, ILLINOIS</p> <h2>PAN-TY® FLAG MARKER TIE</h2> <h3>PLF SERIES</h3>						
										<small>UNLESS OTHERWISE SPECIFIED, DIMENSIONAL TOLERANCES ARE: (.X) ± .0005 (.XXX) ± .0020 (.51) (.XX) ± .02 (.5) ANGLES ± .0005</small>						
										<small>UNLESS OTHERWISE SPECIFIED, ALL DIMENSIONS ARE GIVEN IN INCHES, THIRD ANGLE PROJECTION.</small>						
										<small>DRAWN BY L.V./AJC</small>		<small>MAT'L:</small> <p style="font-size: 1.2em;">NYLON 6/6</p>		<small>SCALE</small> <p style="font-size: 1.2em;">NONE</p>		
										<small>DATE</small> <p style="font-size: 1.2em;">2-10-71</p>				<small>DRAWING NO.</small> <p style="font-size: 1.2em;">SS-2723</p>		
										<small>CHK'D</small> <p style="font-size: 1.2em;">HVP</p>				<small>DWG SIZE</small> <p style="font-size: 1.2em;">A</p>		
REV	DATE	BY	CHK	DESCRIPTION				ECN	R	CUST	SUP					
11	2/13/03	JABO		ADDED WRITE-ON AREA FOR ALL PARTS				2723	11							