

Switch Language

English

Need Assistance?

- Contact Us
- Find a Distributor
- Order Samples
- Tech Library

[Printer-friendly page](#)

[Email this page](#)

[Home](#) [I/O Connectors](#) [Datasheet](#)

Part Number: 0743232051

Status: Active

Description: MicroCross™ DVI Digital Single Link, High Volume Plug Connector Sub- assembly, ESD Type, Gold (Au) Flash, Vertical, with key, 18 Circuits, Lead Free

Documents:

Note - Please disable browser pop-up blockers for documents on www.molex.com

[Drawing \(PDF\)](#)

[Product Specification PS-74320-001 \(PDF\)](#)

[Related Catalog Page \(PDF\)](#)

Order Products:

[Check Distributor Inventory](#)

[Add to My Parts](#)

[Request Samples](#)

Part Detail: [\(show all\)](#)

[General](#) [Physical](#) [Electrical](#) [Material Info](#)

General

Product Family	I/O Connectors
Series	74323
Application	Wire-to-Board
Comments	DDWG (Digital Display Working Group) Standard
Component Type	I/O Plug Connector Subassembly
Product Name	MicroCross™ DVI
Type	N/A

Physical

Boot Color	N/A
Circuits (Loaded)	18
Circuits (maximum)	24
Circuits Detail	Circuits 1-3, 6-8, 9-11, 14-16, 17-19, 22-24 are loaded; with key
Color - Resin	Black
Durability (mating cycles) min	100 cycles
Flammability	94V-0
Keying to mating part	Yes
Lock to Mating Part	Yes
Material - Metal	Copper Alloy
Material - Plating Mating	Gold
Material - Plating Termination	Tin
Material - Resin	High Temperature Thermoplastic
Number of Rows	3
Orientation	Vertical
PCB Retention	None
Packaging Type	Tray
Panel Mount	N/A
Pitch - Mating Interface (in)	0.075 In
Pitch - Mating Interface (in)	0.100 In
Pitch - Mating Interface (mm)	1.90 mm



EU RoHS

ELV and RoHS Compliant

China RoHS



Need more information on product compliance?

Email productcompliance@molex.com

Please visit the [Contact Us](#) section for any non-product compliance questions.

Search Parts in this Series

[74323](#) Series

Mates With

Other receptacle components, [74320](#) DVI Receptacle, [67351](#) DVI Receptacle

Pitch - Mating Interface (mm)	2.54 mm
Pitch - Term. Interface (in)	0.075 In
Pitch - Term. Interface (in)	0.100 In
Pitch - Term. Interface (mm)	1.90 mm
Pitch - Term. Interface (mm)	2.54 mm
Plating min: Mating (uin)	10
Plating min: Mating (um)	0.25
Plating min: Termination (uin)	150
Plating min: Termination (um)	3.80
Polarized to Mating Part	Yes
Polarized to PCB	Yes
Ports	1
Temperature Range - Operating	-20°C to +85°C
Termination Interface: Style	Solder or Weld
Waterproof / Dustproof	No
Wire Size AWG	N/A

Electrical

CSA	LR19980
Current - Maximum	3.000 Amp
Grounding to Panel	Yes
Shield Type	Full Shield
Shielded	Yes
UL	E29179
Voltage - Maximum	40V AC (RMS)

Material Info

Reference - Drawing Numbers

Product Specification	PS-74320-001
Sales Drawing	SD-74323-006

NOTES:
 1. MATERIALS: HOUSING: HIGH TEMPERATURE PLASTIC
 UL 94V-0, COLOR: BLACK
 TERMINAL: COPPER ALLOY
 SHIELD: STEEL ALLOY
 2. FINISH: TERMINAL: SEE THE CHART FOR GOLD PLATING OVER 127 MICROMETER (50 μ) NICKEL IN CONTACT AREA AND 3.81 MICROMETER (150 μ) PURE TIN OVER 1.27 MICROMETER (50 μ) NICKEL AT SOLDERING AREA.
 SHIELD: 3.81 MICROMETER (150 μ) BRIGHT TIN OVER 1.27 MICROMETER (50 μ) NICKEL OVERALL.
 3. PRODUCT SPECIFICATION: PS-74320-001 .
 4. PACKAGING: PARTS ARE TO BE PACKAGED 40 PCS PER TRAY.
 5. THE LOADED CIRCUITS SEE THE CHART.
 6. THE TEXTS ARE SHOWN FOR REFERENCE ONLY.
 7. THE DIMENSION SHOWN ON SHEET 1 REFLECT THE DVI-D SINGLE AND DUAL LINK SUB-ASSEMBLY.
 THE DIMENSION SHOWN ON SHEET 2 REFLECT THE DVI-A AND DVI-I SUB-ASSEMBLY, FOR ALL OTHER DIMENSIONS REFER TO SHEET 1.

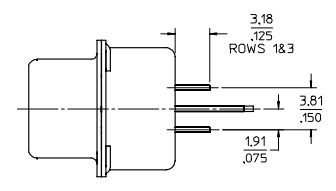
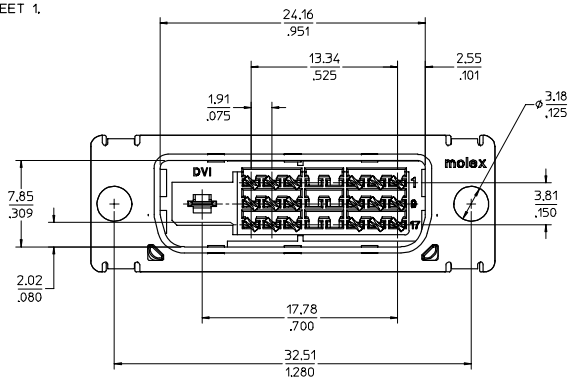
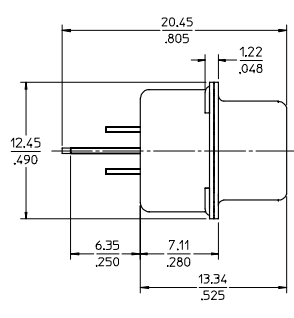
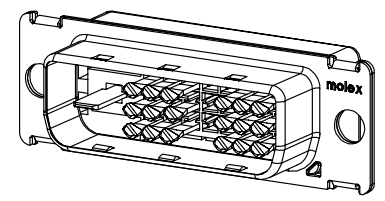
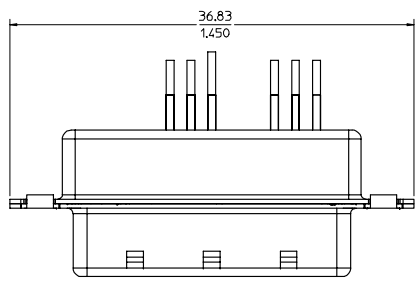

LEAD-FREE EC NO: SH2005-0067 DRWN: DXUE 2004/09/02 CHK: YTYA2004/09/03 APPR: JZHOU	QUALITY SYMBOLS	GENERAL TOLERANCES (UNLESS SPECIFIED)	SCALE 4:1	DESIGN UNITS INCH	THIRD ANGLE PROJECTION	REVISE ON CAD ONLY	
	DESCRIPTION	mm	INCH	DIMENSION STYLE IN/MM	DVI HIGH VOLUME PLUG CONNECTOR SUB-ASSEMBLY FOR ESD TYPE		
		4 PLACES ± --- ± ---	± .010	DRAWN BY GRACE			DATE 00/08/09
		5 PLACES ± --- ± ---	± 0.25	CHECKED BY JASON			DATE 00/08/21
1 PLACE ± --- ± ---	ANGULAR ± 1 °	DRAFT WHERE APPLICABLE MUST REMAIN WITHIN DIMENSIONS	APPROVED BY MEGA	DATE	MATERIAL NO. SEE CHART	DOCUMENT NO. SD-74323-006	
REV						SHEET NO. 1 OF 2	

