

PRODUCT NUMBER

71600-YXXLF

LEAD FREE, SEE NOTE 6

TOTAL NB OF POSITION 04 TO 64
SEE SHEET 2

OPTIONAL STRAIN RELIEF
SEE SHEET 2

TRIANGLE INDICATES
POSITION 1
NOTE 5

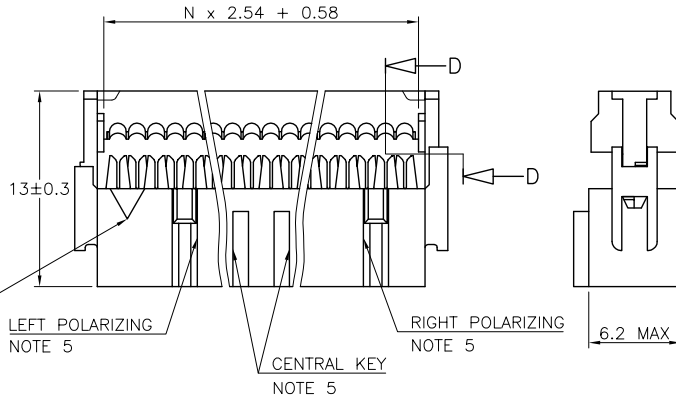

NOTES:

- 1 - PLASTIC MAT'L : GLASS FILLED HIGH TEMPERATURE THERMOPLASTIC. UL94V-0 COLOR: GREY
- 2 - PIN MATERIAL : PHOSPHOR BRONZE
- 3 - PRODUCT PACKAGED IN TUBES.
- 4 - TO DETERMINE DIMENSIONS :
N = NUMBER OF POSITIONS
EXAMPLE : 8 POS N x 2.54 = 20.32mm
- 5 - 2x5, 2x6, 2x7 HAVE NO LEFT POLARIZING SLOT.
- 2x2, 2x3 WITH CENTRAL KEY HAVE NO TRIANGLE, NO LEFT AND RIGHT POLARIZING SLOT.
- 2x2 WITHOUT CENTRAL KEY HAS NO LEFT AND RIGHT POLARIZING SLOT.
- 2x3, 2x4 WITHOUT CENTRAL KEY HAVE NO LEFT POLARIZING SLOT
- 2x4 WITH CENTRAL KEY HAVE NO LEFT AND RIGHT POLARIZING SLOT
- 6 - THIS PRODUCT MEETS EUROPEAN UNION DIRECTIVES AND OTHER COUNTRY REGULATIONS AS PER GS-22-008.
PACKAGING SPECIFICATION AS PER GS-14-920.

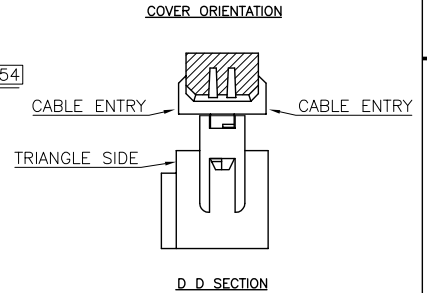
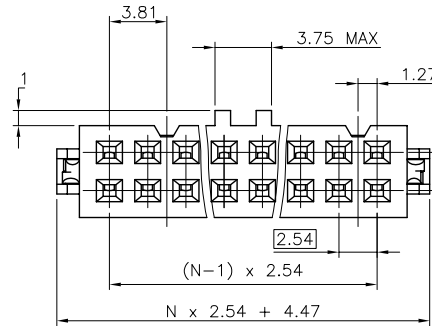

mat'l. code SEE NOTES		surface ISO 1302	tolerance ISO 406 ISO 1101	projection	product family 2.54MM IDC
Ltr	ecn no	dr	date	tolerances unless otherwise specified	title
AG	F04-0330	LMU	04.09.01	angles linear X.X ±0.3	QUICKIE III FEM
AH	F05-0109	JCO	05.01.17	X.XXX ±0.13	0.76µm Au
AJ	F05-0171	LMU	05.04.07	X.XXX ±0.05	scale 5:1
AK	F05-0180	LMU	05.04.22	dr D.LE 01.01.24	FCJ
AL	F06-0270	LMU	06.09.12	engr P.NZ 01.01.24	dwg no
AM	F06-0274	LMU	06.09.25	chr J.F.N 01.01.24	71600
AN	F09-0233	LMU	09.12.15	appd P.NZ 01.01.24	sheet 1 of 2
sheet index	revision	AN	AE		size
	1	2			A3
					type
					CUSTOMER Drawing

PDM: Rev:AN

STATUS:Released

Printed: Feb 20, 2010

CORE RANGE	
STRAIN RELIEF	Nbr OF POSITIONS
0/1	04
0/1	06
0/1	08
0/1	10
0/1	14
0/1	16
0/1	18
0/1	20
0/1	24
0/1	26
0/1	30
0/1	34
0/1	40
0/1	50
0/1	60
0/1	64

CATALOGUE RANGE	
STRAIN RELIEF	Nbr OF POSITIONS
2/6	04
2/6	06
2/6	08
2/6	10
2/6	14
2/6	16
2/6	18
2/6	20
2/6	24
2/6	26
2/6	30
2/6	34
2/6	40
2/6	50
2/6	60
2/6	64

PLATING
0.76µm GOLD ON CONTACT AREA
1.27 µm Ni REMAINDER OF PRODUCT

PLATING
0.76µm GOLD ON CONTACT AREA
1.27 µm Ni REMAINDER OF PRODUCT

624
304
204 / 224
004
DASHES NOT AVAILABLE

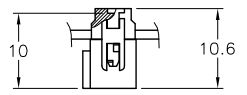

WITHOUT STRAIN RELIEF

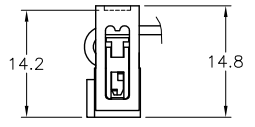

WITH LOW PROFILE STRAIN RELIEF

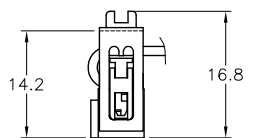

WITH STANDARD STRAIN RELIEF

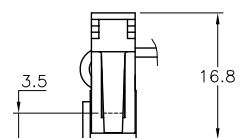

WITH LATCHING STRAIN RELIEF

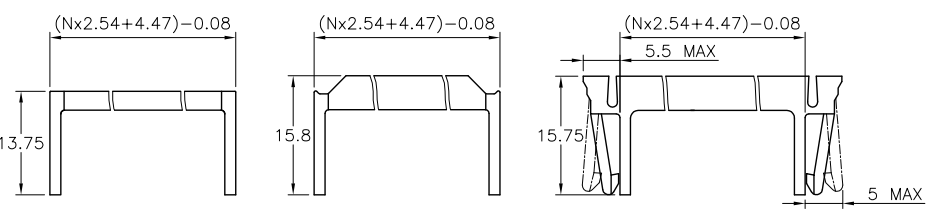

LOW PROFILE STRAIN RELIEF

STANDARD STRAIN RELIEF

LATCHING STRAIN RELIEF FOR SLIM HEADER

PRODUCT NUMBER	CENTRAL KEY		STRAIN RELIEF			
	WITH	WITHOUT	STANDARD	WITHOUT	LOW PROFILE	LATCHING
71600-6YYLF	●		●			●
71600-3YYLF		●	●			
71600-2YYLF	●				●	
71600-1YYLF	●			●		
71600-0YYLF	●		●			

mat'l. code	surface ISO 1302	tolerance ISO 406 ISO 1101	projection	product family
X F70666 AAN 97.11.05	tolerances unless otherwise specified		QUICKIE	
Y F10121 DLE 01.01.24	angles linear		mm	title
AA F10199 GCO 01.04.26			scale N/A	IDC RECEPT DR
AB F03019 DLE 03.01.23	dr D.LE	01.01.24		dwg no
AC F05-018d LMU 05.04.22	engr P.N.Z	01.01.24		71600
AD F06-027d LMU 06.09.12	chr J.F.N	01.01.24		sheet 2 of - size
AE F06-027d LMU 06.09.25	appd P.N.Z	01.01.24		A3
sheet index	revision sheet			type
				CUSTOMER Drawing