

Switch Language

English

Need Assistance?

Contact Us
Find a Distributor
Order Samples
Tech Library

Printer-friendly page

Email this page

[Home](#) [Crimp Housings](#) [Datasheet](#)

Part Number: 0039012020

Status: Active **Overview:** [Mini-Fit Jr.™](#)

Description: 4.20mm (.165") Pitch Mini-Fit Jr.™ Receptacle Housing, Dual Row, UL 94V-2, 2 Circuits

Documents:

Note - Please disable browser pop-up blockers for documents on www.molex.com

- | | |
|---|---|
| Drawing (PDF) | Product Specification PS-5557-003 (PDF) |
| Product Specification PS-5557-004 (PDF) | Product Specification PS-5557-010 (PDF) |
| Product Specification PS-5557-011 (PDF) | Product Specification PS-5557-012 (PDF) |
| Product Specification PS-5557-013 (PDF) | Product Specification PS-5557-015 (PDF) |
| Product Specification PS-5557-016 (PDF) | Product Specification PS-5557-021 (PDF) |
| Product Specification PS-5557-039 (PDF) | Product Specification PS-5557-040 (PDF) |
| Product Specification PS-5557-041 (PDF) | Product Specification PS-5557-042 (PDF) |
| Product Specification PS-5557-043 (PDF) | Product Specification PS-5557-044 (PDF) |
| 3D Model | Test Summary (PDF) |
| Related Catalog Page (PDF) | |

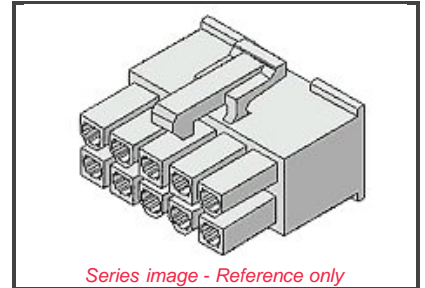

EU RoHS **China RoHS**
ELV and RoHS Compliant



Need more information on product compliance?

Email productcompliance@molex.com

Please visit the [Contact Us](#) section for any non-product compliance questions.

Order Products:

[Check Distributor Inventory](#) [Add to My Parts](#)
[Request Samples](#)

Part Detail: [\(show all\)](#)

[General](#) [Physical](#) [Electrical](#) [Material Info](#)

General

Product Family	Crimp Housings
Series	5557
Comments	Glow Wire Equivalent Part Number 50361673
Overview	Mini-Fit Jr.™
Product Name	Mini-Fit Jr.™

Physical

Breakaway	No
Circuits (maximum)	2
Color - Resin	Natural
Flammability	94V-2
Gender	Female
Material - Resin	Nylon
Number of Rows	2
Packaging Type	Bag
Panel Mount	No
Pitch - Mating Interface (in)	0.165 In
Pitch - Mating Interface (mm)	4.20 mm
Pitch - Term. Interface (in)	0.165 In
Pitch - Term. Interface (mm)	4.20 mm

Search Parts in this Series

[5557](#) Series

Mates With

[5559d](#), [5566vw](#), [5566vwo](#), [5569rdf](#), [5569rdp](#), [43810a](#), [43810b](#), [43810c](#), [43810d](#), [44068a](#), [44068b](#), [44068c](#), [44068d](#), [44281](#), [44472dw](#), [44472dwo](#), [87427](#), [87427r](#), [87427rf](#), [42404](#), [44474](#), [42440](#), [43879](#), [42475](#)

Use With

[5556](#), [44476](#), [44485](#), [41995](#)

Polarized to Mating Part	Yes
Stackable	No
Temperature Range - Operating	-40°C to +105°C

Electrical

CSA	LR19980
TUV	R75142
UL	E29179

Material Info

Old Part Number	5557-02R
-----------------	----------

Reference - Drawing Numbers

Product Specification	PS-5557-003
Product Specification	PS-5557-004
Product Specification	PS-5557-010
Product Specification	PS-5557-011
Product Specification	PS-5557-012
Product Specification	PS-5557-013
Product Specification	PS-5557-015
Product Specification	PS-5557-016
Product Specification	PS-5557-021
Product Specification	PS-5557-039
Product Specification	PS-5557-040
Product Specification	PS-5557-041
Product Specification	PS-5557-042
Product Specification	PS-5557-043
Product Specification	PS-5557-044
Sales Drawing	SD-5557-003

10 9 8 7 6 5 4 3 2 1

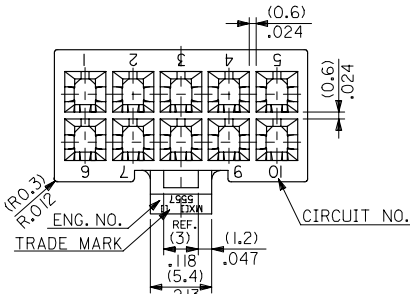

NOTES

1. TERMINAL : 5556 SERIES
2. MATE WITH : 5559 SERIES
5566 SERIES
5569 SERIES
501566 SERIES
3. (METRIC) VALUES SHOWN GOVERN OVER ENGLISH CONVERSION VALUES.
⚠ TO BE MEASURED AT POSITION OF D SURFACE.

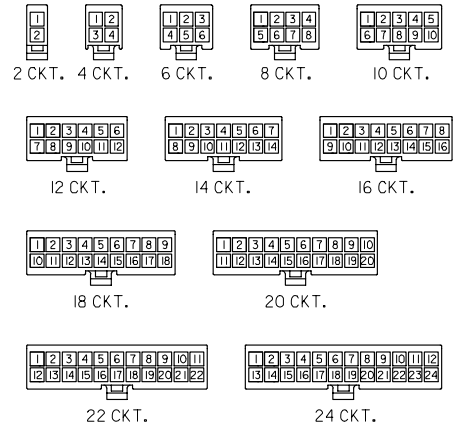

CIRCUIT SIZE LAYOUT
(SCALE 1:1)

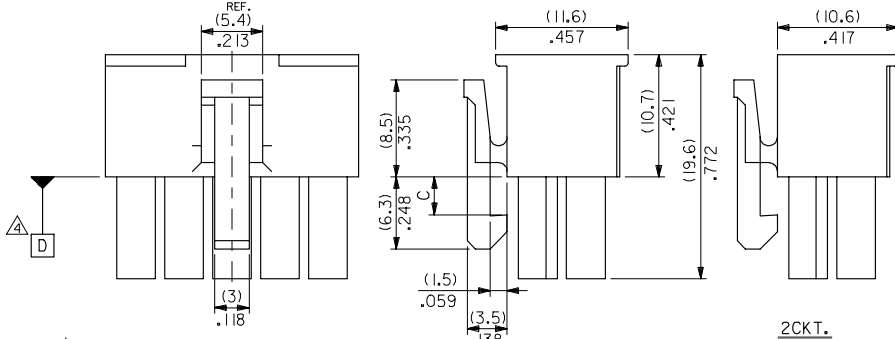

材料	66NYLON (UL94V-2)
仕上り	FINISH
適用電線範囲	WIRE RANGE
被覆外径	INS. RANGE

(51.6)	2.031	(46.2)	1.819	39-01-2240	5557-24R	24
(3.6)	(47.4)	1.866	(42)	1.654	↑ -2220	↑ -22R
.142	(43.2)	1.701	(37.8)	1.488	↑ -2200	↑ -20R
	(39)	1.535	(33.6)	1.323	-2180	-18R
	(34.8)	1.37	(29.4)	1.158	-2160	-16R
	(30.6)	1.205	(25.2)	.992	-2140	-14R
	(26.4)	1.039	(21)	.827	-2120	-12R
(3.3)	(22.2)	.874	(16.8)	.661	-2100	-10R
.129	(18)	.709	(12.6)	.496	-2080	-08R
	(13.8)	.543	(8.4)	.331	-2060	-06R
	(9.6)	.378	(4.2)	.165	↓ -2040	↓ -04R
	(5.4)	.213	—	—	39-01-2020	5557-02R
					EDP. NO.	ENG. NO.
						NO. OF
						CKTS.

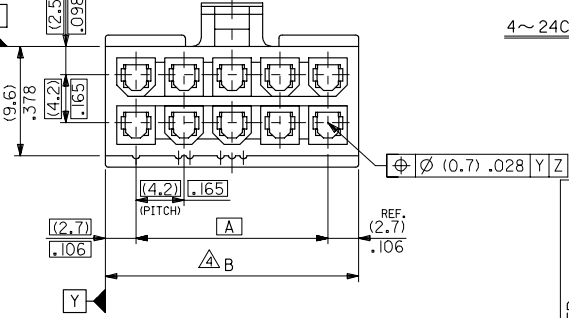

REVISED EC NO. J2005-3799 DRW:HNABEI 2005/06/20 CHK:KATOYODA 2005/06/21 APPR:NIKIITA 2005/06/27	GENERAL TOLERANCES (UNLESS SPECIFIED)	DIMENSION STYLE MM ONLY	SCALE 3:1	DESIGN UNITS METRIC	THIRD ANGLE PROJECTION	
	10 UNDER ±0.2 10 OVER 30 UNDER ±0.3 30 OVER ±0.4 ANGULAR ±3 °	DRAWN BY S. MOCHIZUKI	DATE '90/02/22	TITLE NEW MINI FIT CONN REC. HOUSING		
	DRAFT WHERE APPLICABLE MUST REMAIN WITHIN DIMENSIONS	CHECKED BY M. FUKUSHIMA	DATE '97/01/08	MOLEX INCORPORATED		
		APPROVED BY M. FUKUSHIMA	DATE '97/01/08	MATERIAL NO. SEE CHART	DOCUMENT NO. SD-5557-003	SHEET NO. 2 OF 2