

FUSES

MXT 250

Non resettable fuses

**Subminiature Fuses
Type MXT 250**

time-lag T

high breaking capacity

available in lead-free **NEW** version

directly solderable into printed circuit boards or pluggable into fuseholders

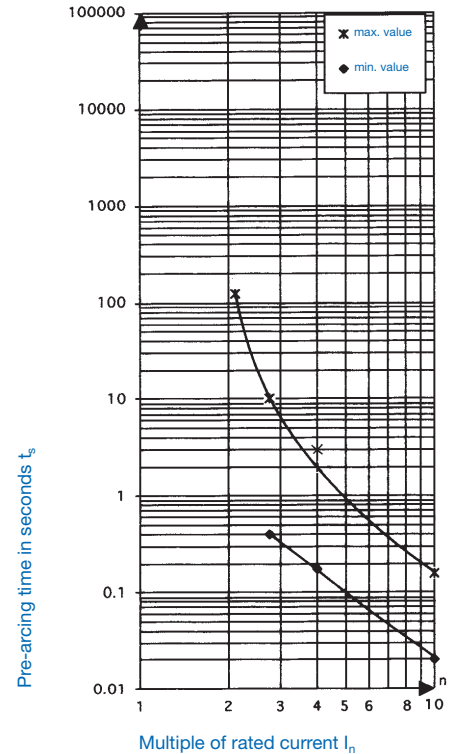
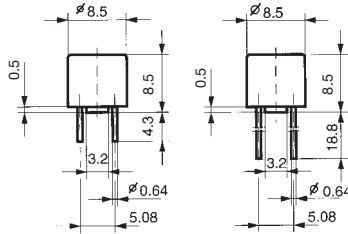

Standards

IEC 60127-3/4; EN 60127-3/4
however with a higher breaking capacity

UL 248-14
CSA C22.2 No. 248.14 } with modifications based on IEC.../EN...

Approvals

- SEV C US
- VDE C US
- SEMCO

Pre-arcing time/current characteristic (at T_a 23 °C)

Rated current I _n \ n · I _n	1,5 · I _n *	2,1 · I _n	2,75 · I _n	4 · I _n	10 · I _n
800 mA–6,3 A	≥ 3600 s	< 120 s	> 400 ms / < 10 s	> 150 ms / < 3 s	> 20 ms / < 150 ms

* Non fusing current I_{nf}

Rated current I _n \ n · I _n	1 · I _n	2 · I _n
8 A–10 A	4 h	< 60 s

Order No.	Terminals		Taped and reeled	Rated current I _n Rated voltage U _n	Breaking capacity	Voltage drop		Sustained power dissipation		Pre-arcing t _p at 10 · I _n	Approvals	
	short	long				at max. I _n	at 1,5 I _n	at max. I _n	at 1,5 I _n			
0034.6914	0034.6944	0034.6974	800 mA / 250 V	100 A/250 V AC p.f. / cos φ 1		at max. I _n	at 1,5 I _n	at max. I _n	at 1,5 I _n	at 10 · I _n	SEV	
0034.6915	0034.6945	0034.6975	1 A / 250 V			160	150	430	300	2,2	VDE	SEMCO
0034.6916	0034.6946	0034.6976	1,25 A / 250 V			140	130	500	350	4,4	C US	C US
0034.6917	0034.6947	0034.6977	1,6 A / 250 V			130	120	600	400	6,3		
0034.6918	0034.6948	0034.6978	2 A / 250 V			120	110	730	500	10		
0034.6919	0034.6949	0034.6979	2,5 A / 250 V			100	85	870	500	16		
0034.6920	0034.6950	0034.6980	3,15 A / 250 V			100	85	1000	650	32		
0034.6921	0034.6951	0034.6981	4 A / 250 V			100	75	1200	670	57		
0034.6922	0034.6952	0034.6982	5 A / 250 V			100	75	1400	900	77		
0034.6923	0034.6953	0034.6983	6,3 A / 250 V				70		1100	155		
0034.6924	0034.6954	0034.6984	8 A / 250 V				65		1150	262		
0034.6925	0034.6955	0034.6985	10 A / 250 V				62		600	397		
							62		680	440		

Additional technical data and packaging see page 72



Suitable fuseholder see page 180

