

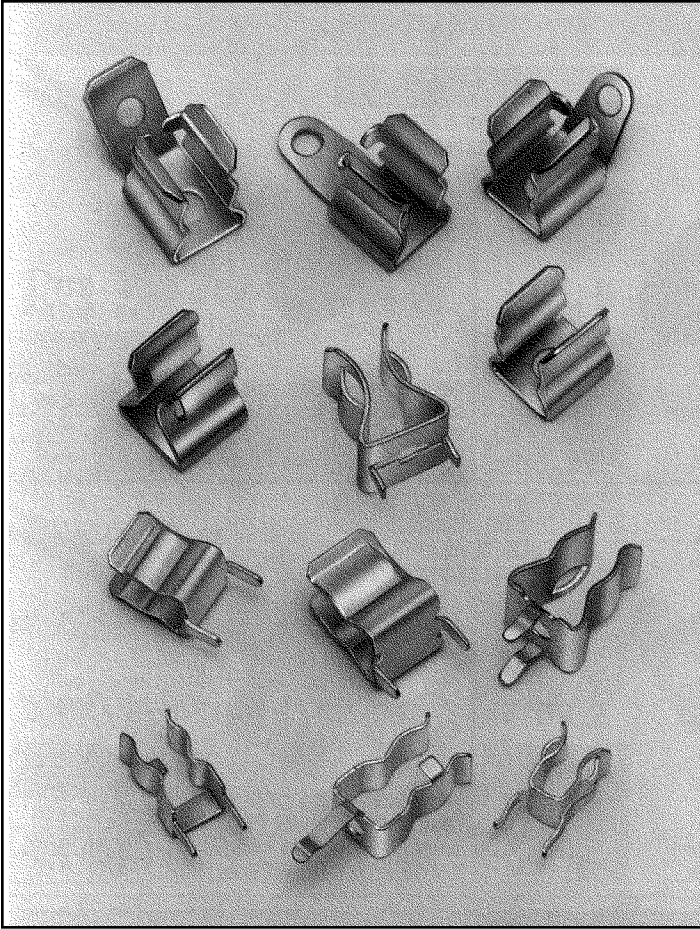

Designers' Choice

2AG & 5mm FUSE CLIPS



- PC thru mount and rivet types for 2AG, 5mm, 3AG, 9/32 & 13/32 fuse sizes
- Low contact resistance
- Withstands shock and vibration
- Rated 6.3 to 30 Amps
- Custom designs and modifications available to your specifications

PC THRU MOUNT TYPES

- Available for 2AG, 5mm, 3AG & 13/32 sizes
- Low profile, space saving
- Snap-fit design enhances assembly and PC retention for wave soldering
- Available with orientation legs to assure proper PC installation
- Available with or without end stops

RIVET TYPES

- Available for 3AG & 9/32 sizes
- Available with straight or 45° solder lugs
- Available with .187, .205 or .250 or quick fit tabs
- Low profile, space saving
- Available with or without end stops

5mm/3AG PC MULTI-FUSE CLIP

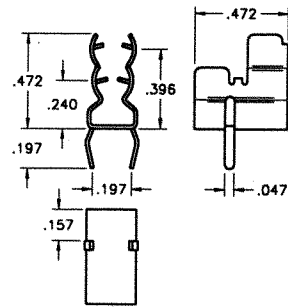

.016 Phosphor Bronze, Tin Plate
Current Rating: 15 Amps

Mounting Detail

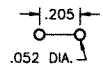

CAT. NO. 3562

5mm PC CLIP



3517 3518P

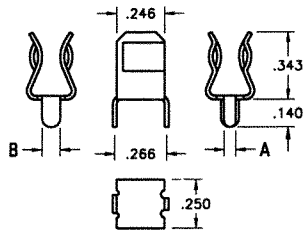

.020 Brass, Tin Plate
Current Rating: 15 Amps

CAT. NO.	"A"	"B"
3517	.060	.060
3518P	.060	.093

With or Without Orientation Legs

2AG/5mm THM/SMT FUSE CLIP

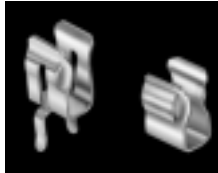

3521 3561

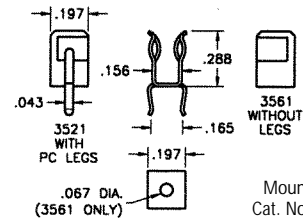

.016 Brass, Tin Plate
Current Rating: 10 Amps

CAT. NO. 3521 (THM with PC legs)

CAT. NO. 3561 (SMT with Hole)

Mounting Detail
Cat. No. 3521 Only

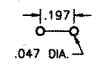

5mm PC CLIP



.016 Brass, Tin Plate
Current Rating: 6.3 Amps

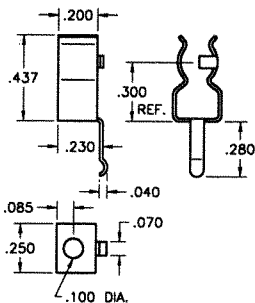

CAT. NO. 3520

5mm PC CLIP

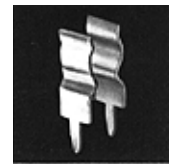

.016 Brass, Tin Plate
Current Rating: 10 Amps

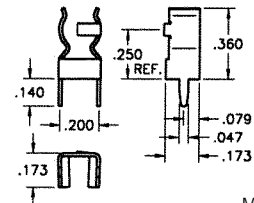

CAT. NO. 3519

Mounting Detail

