

DATE MANUFACTURE REVISIONS FOR PUBLICATION ALL RIGHTS RESERVED

DUAL CRIMP TABLE	
PART NO	WIRE SIZE
1326030-9	0.35±0.35
AND	0.35±0.75
1-1326030-1	0.5±1.0
AND	0.5±1.5
1-1326030-0	0.5±1.5
AND	0.75±0.75
1-1326030-2	0.75±1.0
AND	0.75±1.5
1-1326030-3	1.0±1.0
AND	1.0±1.5

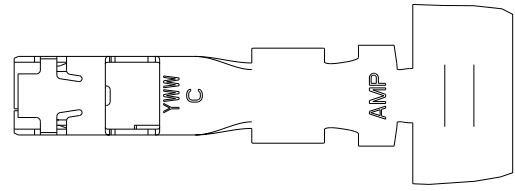
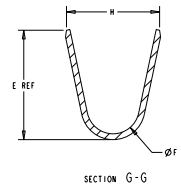
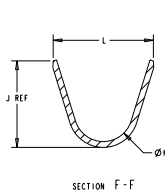
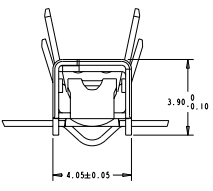
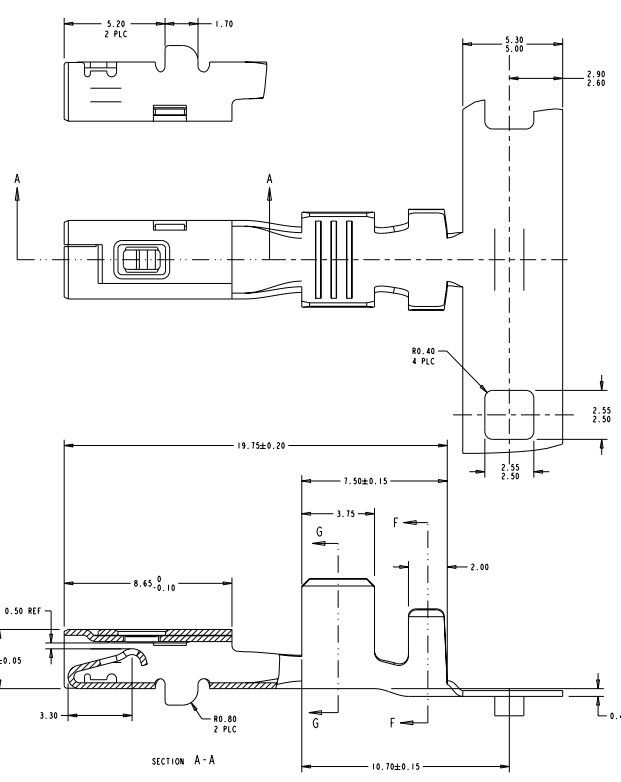

REV	DATE	DESCRIPTION	BY	CHK	APP
00		REVISED PER ECO-11-005030			

△ MATERIAL: 0.30 THICK COPPER ALLOY, PREPLATED WITH 0.0008 MINIMUM THICK REFLOW TIN OR BRIGHT TIN (ELV COMPLIANT).  
 △ ALTERNATE MATERIAL: 0.30 THICK COPPER ALLOY, PREPLATED WITH 0.0008 MINIMUM THICK BRIGHT TIN (ELV COMPLIANT).

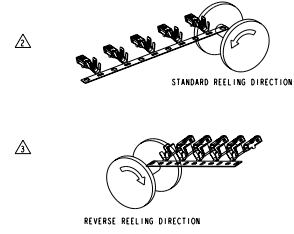

5. QUALIFICATION OF THE CRIMP APPLICATION TOOLING SHALL BE CONTROLLED BY THE REQUIREMENTS ESTABLISHED UNDER USCAR 21.  
 6. LOOSE END SPLICING TO BE USED.

REELING	L	ØK	J	H	ØF	E	WIRE SIZE	PART NO.
△	1-1326030-0 REELED FOR AMP APPLICATOR	REFERENCE DUAL CRIMP TABLE	1-1326030-2					
△	1326030-9 REELED FOR AMP APPLICATOR	REFERENCE DUAL CRIMP TABLE	1-1326030-1					
	4.6	1.80	5.35	3.9	1.70	3.88		
	3.6	1.40	4.32	3.3	1.30	2.76		
△	1326030-4 REELED FOR AMP APPLICATORS	REFERENCE DUAL CRIMP TABLE	1326030-9					
	1326030-4 REELED FOR AMP APPLICATORS	12 AWG	1326030-8					
△	1326030-3 REELED FOR AMP APPLICATORS	14-16 AWG	1326030-7					
	1326030-2 REELED FOR AMP APPLICATORS	18-20 AWG	1326030-6					
	1326030-1 REELED FOR AMP APPLICATORS	22 AWG	1326030-5					
	5.2	3.20	4.22	4.7	2.70	5.25	12 AWG	1326030-4
	3.8	1.80	3.14	3.9	1.30	3.88	14-16 AWG	1326030-3
	3.1	1.40	2.55	3.3	1.30	2.76	18-20 AWG	1326030-2
	2.6	1.00	2.04	2.5	0.90	2.11	22 AWG	1326030-1

THIS DRAWING IS A CONTROLLED DOCUMENT. **STRASBURG** 284P899 **TE Connectivity**

DATE: 11-05-2013  
 DRAWN BY: [Signature]  
 CHECKED BY: [Signature]  
 APPROVED BY: [Signature]

MATERIAL: **2.8mm RECEPTACLE, UNSEALED**

SIZE: 132-13013  
 PART NO: 00779 ©-1326030  
 CUSTOMER DRAWING