

10091767 - X 0 C - X 0 X L F

6-COLUMN DIFFERENTIAL SIGNAL

LEAD-FREE DESIGNATION ONLY WITH APPLICABLE PLATING CODES

LETTER	PERFORMANCE-BASED PLATING (SEE NOTE 2)	
	TARGET APPLICATION	LEAD FREE (LF)
B	TELCORDIA CO	NO
C	TELCORDIA UE	NO
D	TELCORDIA CO	YES
E	TELCORDIA UE	YES

MODULE DESCRIPTION	LETTER DESIGNATION REPRESENTED IN DASH NUMBER									BASE MODULE
	J	A	B	C	D	E	F	G	H	
LEFT POLARIZING GUIDANCE MODULE (SEE SHEET 3)										
RIGHT POLARIZING GUIDANCE MODULE (SEE SHEET 4)										
OPEN MODULE (TWO WALL) (SEE SHEET 2)	0 (ZERO)									
LEFT WALL MODULE (SEE SHEET 5)	L									
RIGHT WALL MODULE (SEE SHEET 6)	M									
FOUR WALL MODULE (SEE SHEET 7)	I									

NUMBER	CONTACT MATING WIPE LENGTH		COMPLIANT PIN DRILL SIZE
	SIGNAL	WIDE GROUND	
1	2	4	Ø0.55 [0.0217"]
2	3	4	Ø0.55 [0.0217"]
3	2	4	Ø0.45 [0.0177"]
4	3	4	Ø0.45 [0.0177"]
5	2	3	Ø0.55 [0.0217"]
6	3	3	Ø0.55 [0.0217"]
7	2	3	Ø0.45 [0.0177"]
8	3	3	Ø0.45 [0.0177"]

TABLE 1: OPTIONAL PCB HOLE SIZE (SEE NOTE 11)

	GROUNDED	UNGROUNDED
FINISHED	Ø2.35-2.55	Ø2.35-2.55
PAD	Ø5.50	N/A
PLATED	YES	NO
DRILL (mm/in)	2.58 / .1015	2.44 / .096

TABLE 2: OPTIONAL SCREW TYPE (SEE NOTE 10)

SCREW P/N	DESCRIPTION	BOARD THICKNESS
10091790-002LF	#2-56 X .375" PHILLIPS PANHEAD W/SO CONICAL WASHER	1.60 - 5.00
10091790-003LF	#2-56 X .500" PHILLIPS PANHEAD W/SO CONICAL WASHER	5.00 - 10.00

Copyright FCJ

spec ref	SEE NOTES	dr	W. J. SWAIN	2009-02-04	projection	MM	size	A2	scale	4:1
tolerance std	ASME Y14.5	eng	NG. R	2011-05-16	chr	NG. R	2011-05-16	ecr no		
ASME Y14.5	TOLERANCES UNLESS OTHERWISE SPECIFIED	appr	C. H. TAN	2011-05-16	product family		XCode	rel level	Released	
surface	linear	0.1	±0.2	0.25	±0.10	0.25	±0.050			
ASME Y14.5	angular	0°	±°							
		www.fcj.com	cat. no.	10091767	Product	Customer Drw	rev	A	sheet 1 of 6	

PDS: Rev :A STATUS: Released Printed: 18 May 20, 2011

OPEN (2-WALL) MODULE

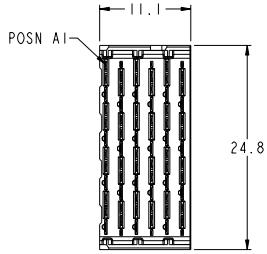
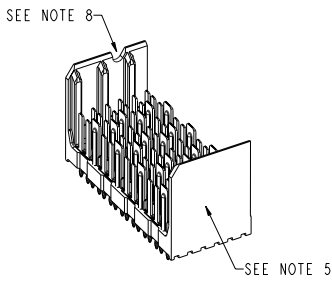

- 6.2 (4MM WIPE WIDE GROUNDS)
- 5.2 (3MM WIPE WIDE GROUNDS)
- 5.2 (3MM SMALL END GROUNDS)
- 5.2 (3MM WIPE SIGNALS)
- 4.2 (2MM WIPE SIGNALS)
- SEE P/N TREE

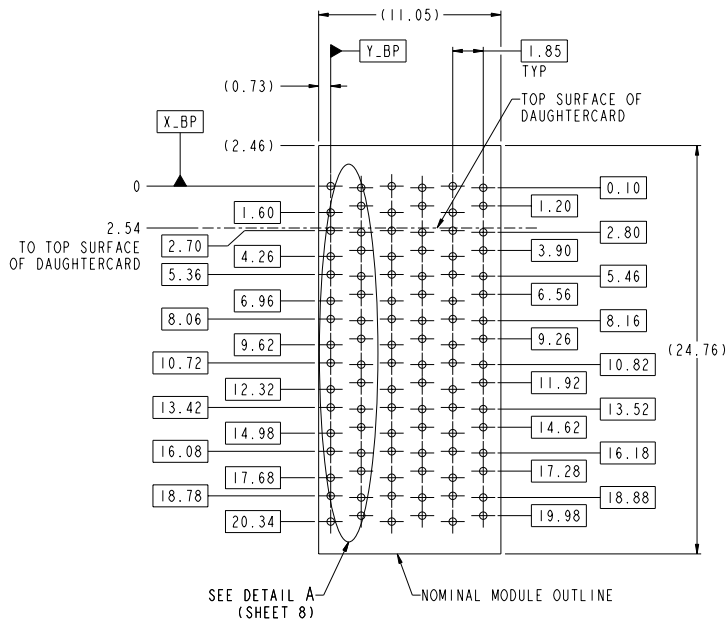
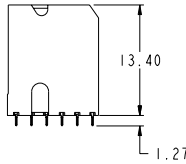
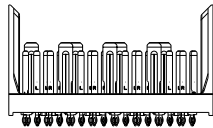
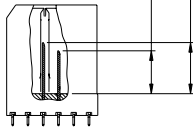

PCB HOLE PATTERN  
COMPONENT SIDE  
SCALE 6:1

spec ref	SEE NOTES	dr	M. J. SWAIN	2009-02-04	projection	MM	size	A2	scale	4:1
tolerance std	TOLERANCES UNLESS OTHERWISE SPECIFIED	eng	NG. R	2011-05-16	chr	NG. R	2011-05-16	ecn no		Released
ASME Y14.5		appr	C. H. TAN	2011-05-16	product family		XCode	rel level		
surface	linear	0.1	±0.2							
		0.2X	±0.10							
		0.3XX	±0.050							
ASME Y14.5	angular	0°	±°							

**FCJ** MODULE ASSEMBLY  
 VERTICAL HEADER, 6 COLUMN, 4-PAIR  
 SEE P/N TREE Product: Customer Draw sheet 2 of 6  
**PDS: Rev: A**      **STATUS: Released**      **Printed: May 20, 2011**

Copyright FCJ

LEFT POLARIZING/GUIDE MODULE

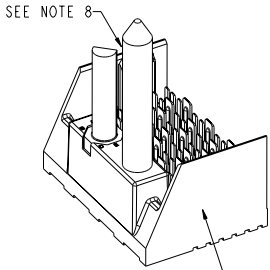

SEE NOTE 5

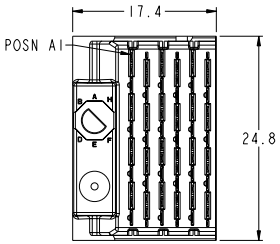

- 6.2 (4MM WIPE WIDE GROUNDS)
  - 5.2 (3MM WIPE WIDE GROUNDS)
  - 5.2 (3MM SMALL END GROUNDS)
  - 5.2 (3MM WIPE SIGNALS)
  - 4.2 (2MM WIPE SIGNALS)
- SEE P/N TREE

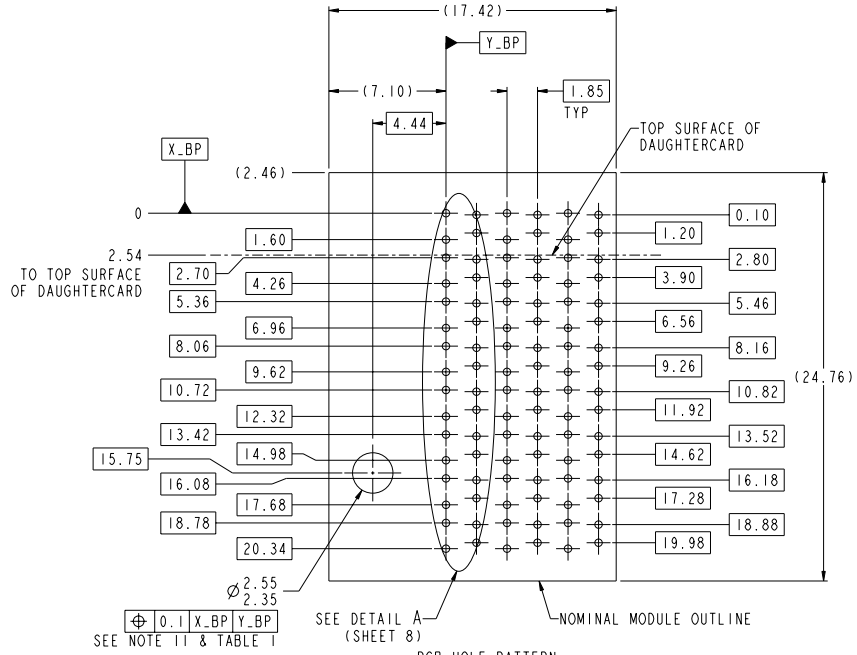
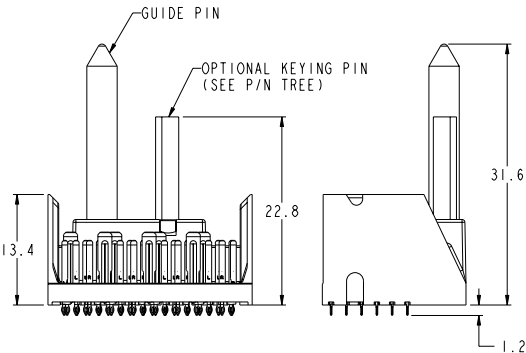
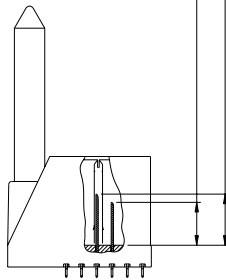

0.1 X\_BP | Y\_BP

SEE NOTE 11 & TABLE 1

spec ref	SEE NOTES	dr	M. J. SWAIN	2009-02-04	projection	MM	size	A2	scale	4:1
tolerance std	TOLERANCES UNLESS OTHERWISE SPECIFIED	eng	NG. R	2011-05-16	chr	NG. R	2011-05-16	ecr no		Released
ASME Y14.5		appr	C. H. TAN	2011-05-16	product family		XCode	rel level		
surface	linear	0.1	±0.2							
		0.2X	±0.10							
		0.3XX	±0.050							
ASME Y14.5	angular	0°	±°							

FCJ MODULE ASSEMBLY

VERTICAL HEADER, 6 COLUMN, 4-PAIR

SEE P/N TREE

Product: Customer Draw

10091767

rev A

sheet 3 of 6

PDS: Rev: A STATUS: Released Printed: May 20, 2011

Copyright FCJ

# RIGHT POLARIZING/GUIDE MODULE

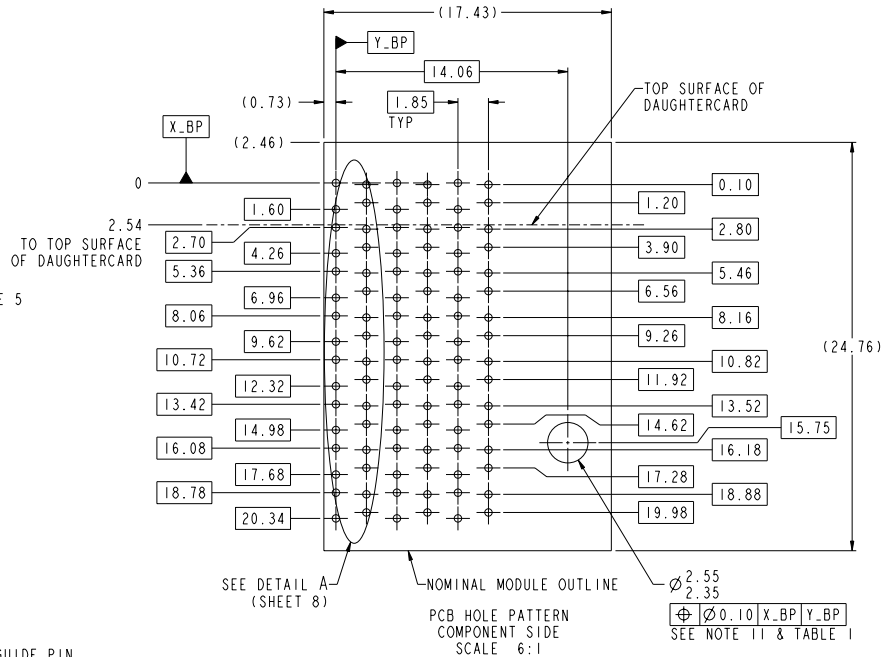
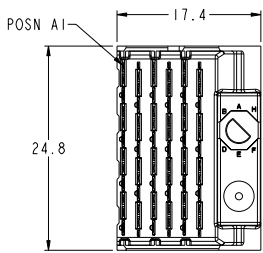
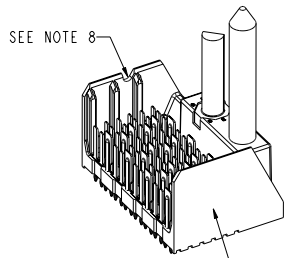

- 6.2 (4MM WIPE WIDE GROUNDS)
- 5.2 (3MM WIPE WIDE GROUNDS)
- 5.2 (3MM SMALL END GROUNDS)
- 5.2 (3MM WIPE SIGNALS)
- 4.2 (2MM WIPE SIGNALS)
- SEE P/N TREE

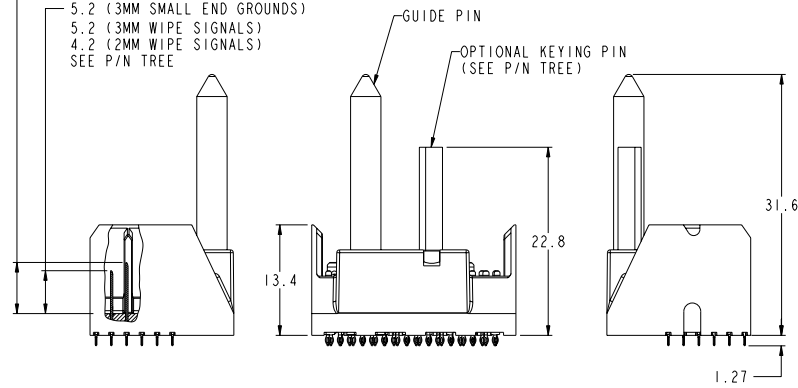

spec ref	SEE NOTES	dr	M. J. SWAIN	2009-02-04	projection	MM	size	A2	scale	4:1			
tolerance std	TOLERANCES UNLESS OTHERWISE SPECIFIED	eng	NG. R	2011-05-16	chr	NG. R	2011-05-16	ecm no					
ASME Y14.5		appr	C. H. TAN	2011-05-16	product family		XCode	rel level	Released				
surface	linear	0.1	±0.2		FCJ MODULE ASSEMBLY VERTICAL HEADER, 6 COLUMN, 4-PAIR SEE P/N TREE					eng	10091767	rev	A
ASME Y14.5	angular	0°	±°							Product	Customer Draw	sheet	4 of 6

PDS: Rev :A STATUS: Released Printed: May 20, 2011

Copyright FCJ

LEFT WALL MODULE

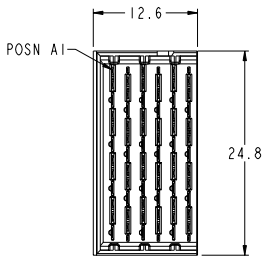
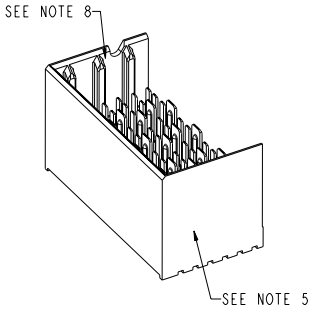

- 6.2 (4MM WIPE WIDE GROUNDS)
- 5.2 (3MM WIPE WIDE GROUNDS)
- 5.2 (3MM SMALL END GROUNDS)
- 5.2 (3MM WIPE SIGNALS)
- 4.2 (2MM WIPE SIGNALS)
- SEE P/N TREE

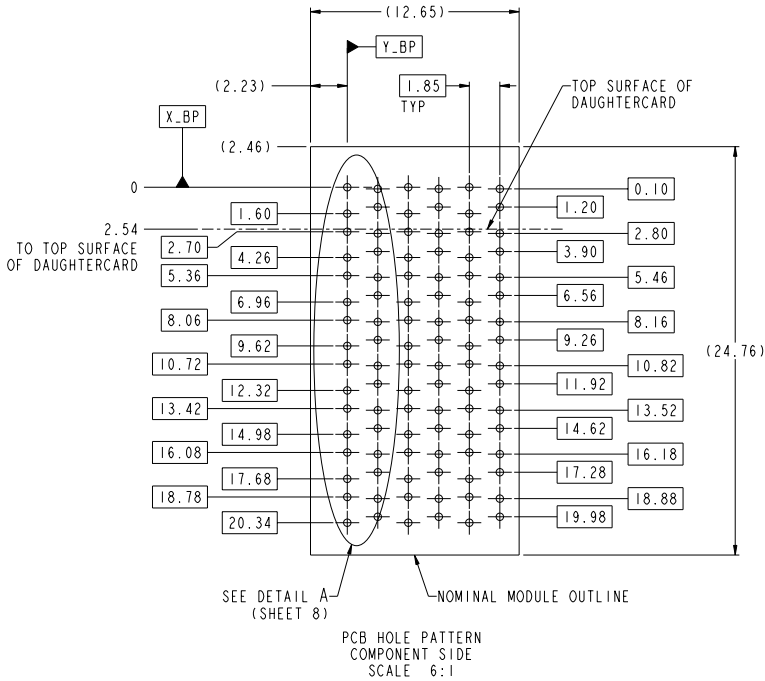
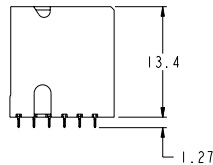
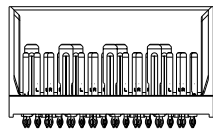
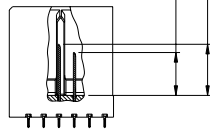

spec ref	SEE NOTES	dr	W. J. SWAIN	2009-02-04	projection	MM	size	A2	scale	4:1
tolerance std	TOLERANCES UNLESS OTHERWISE SPECIFIED	eng	NG. R	2011-05-16	chr	NG. R	2011-05-16	ecn no		
ASME Y14.5		appr	C. H. TAN	2011-05-16	product family		XCode	rel level	Released	
surface	linear	0.1	±0.2	0.25	±0.10	0.25	±0.050	10091767		
ASME Y14.5	angular	0°	±°							

**MODULE ASSEMBLY**  
 VERTICAL HEADER, 6-COLUMN, 4-PAIR  
 SEE P/N TREE Product Customer Draw  
**PDS: Rev: A**      **STATUS: Released**      **Printed: May 20, 2011**

Copyright FCJ

# RIGHT WALL MODULE

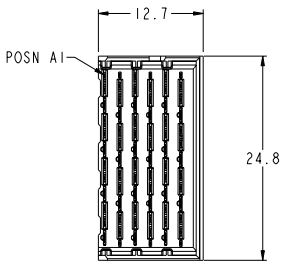
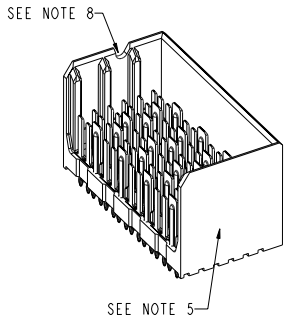

- 6.2 (4MM WIPE WIDE GROUNDS)
  - 5.2 (3MM WIPE WIDE GROUNDS)
  - 5.2 (3MM SMALL END GROUNDS)
  - 5.2 (3MM WIPE SIGNALS)
  - 4.2 (2MM WIPE SIGNALS)
- SEE P/N TREE

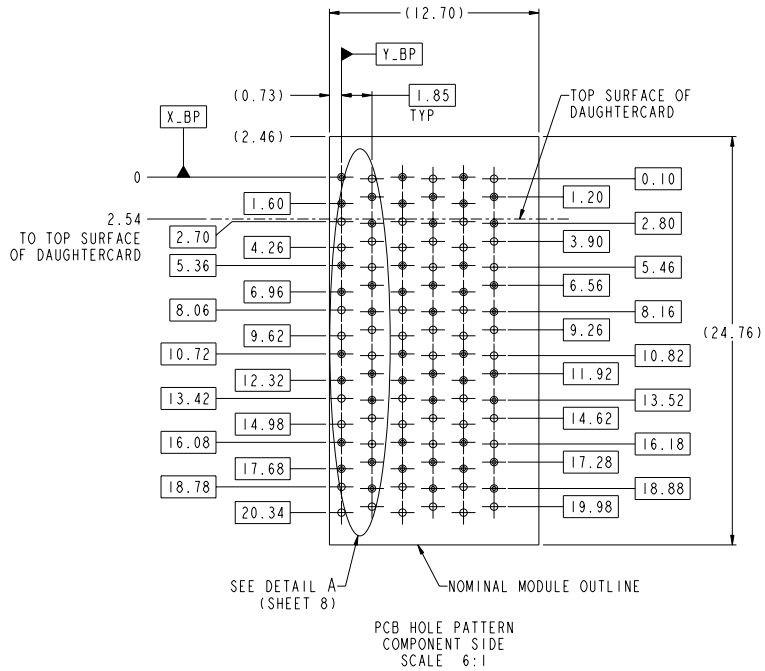
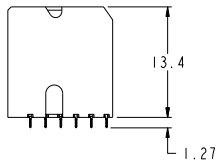
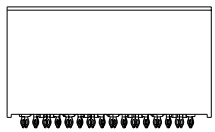
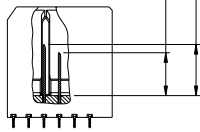

spec ref	SEE NOTES	dr	M. J. SWAIN	2009-02-04	projection	MM	size	A2	scale	4:1
tolerance std	TOLERANCES UNLESS OTHERWISE SPECIFIED	eng	NG. R	2011-05-16	chr	NG. R	2011-05-16	ecn no		Released
ASME Y14.5		appr	C. H. TAN	2011-05-16	product family		XCode	rel level		
surface	linear	0.1	±0.2							
		0.2X	±0.10							
ASME Y14.5	angular	0.2XX	±0.050							
		0°	±°							

**FCJ** MODULE ASSEMBLY  
 VERTICAL HEADER, 6 COLUMN, 4-PAIR  
 SEE P/N TREE  
 Product: Customer Draw  
 10091767  
 rev A  
 sheet 6 of 6  
 PDS: Rev: A STATUS: Released Printed: May 20, 2011

# 4-WALL MODULE

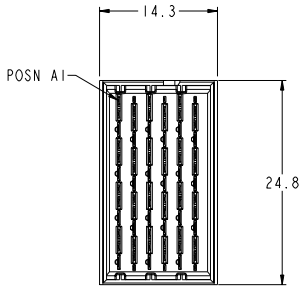
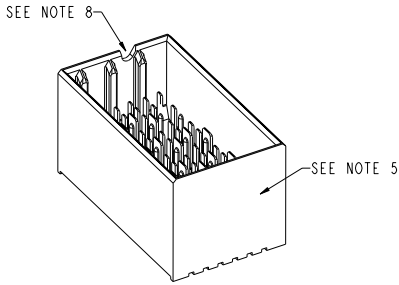

- 6.2 (4MM WIPE WIDE GROUNDS)
- 5.2 (3MM WIPE WIDE GROUNDS)
- 5.2 (3MM SMALL END GROUNDS)
- 5.2 (3MM WIPE SIGNALS)
- 4.2 (2MM WIPE SIGNALS)
- SEE P/N TREE

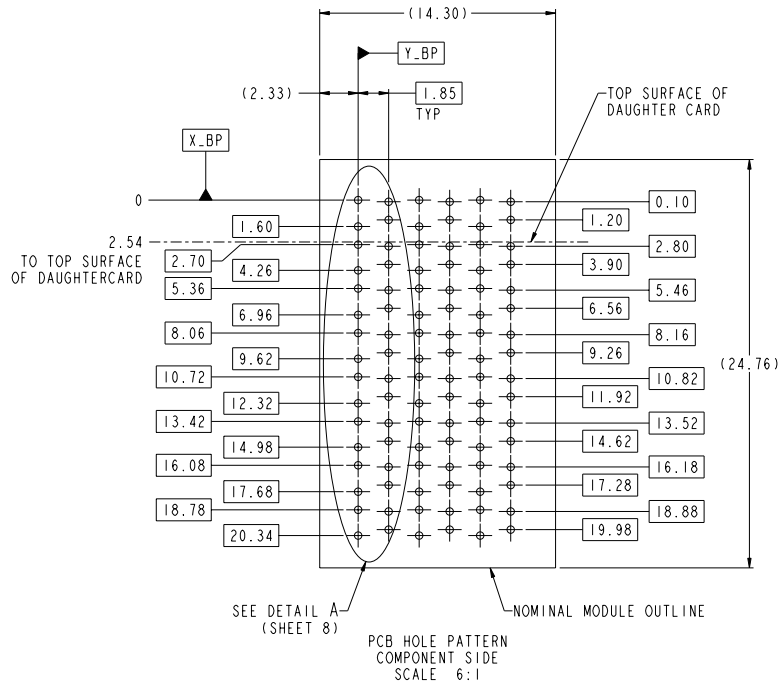
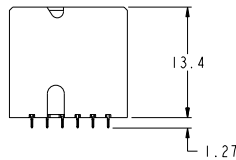
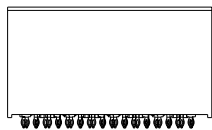
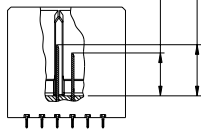

spec ref	SEE NOTES	dr	M. J. SWAIN	2009-02-04	projection	MM	size	A2	scale	3:1
tolerance std	TOLERANCES UNLESS OTHERWISE SPECIFIED	eng	NG. R	2011-05-16	chr	NG. R	2011-05-16	ecn no		Released
ASME Y14.5		appr	C. H. TAN	2011-05-16	product family		XCode	rel level		
surface	linear	0.1	±0.2							
		0.2X	±0.10							
ASME Y14.5	angular	0.2XX	±0.050							
		0°	±°							

**FCJ** MODULE ASSEMBLY  
 VERTICAL HEADER, 6-COLUMN, 4-PAIR  
 SEE P/N TREE  
 Product: Customer Draw  
 PDS: Rev: A STATUS: Released Printed: May 20, 2011  
 10091767  
 sheet 7 of 6

NOTES:

1. CONNECTOR MATERIALS  
SHROUD: HIGH-TEMP THERMOPLASTIC, UL94V-0  
CONTACTS: HIGH PERFORMANCE COPPER ALLOY

2. CONTACT PLATING:

SEPARABLE INTERFACE: PERFORMANCE-BASED PLATING, QUALIFIED TO MEET THE REQUIREMENTS OF FC1 PRODUCT SPECIFICATION GS-12-588, INCLUDING THE TELCORDIA GR-1217-CORE (NOVEMBER 1995) CENTRAL OFFICE (CO) OR UNCONTROLLED ENVIRONMENT (UE) TEST SEQUENCE AS NOTED IN P/N TREE.

PRESS-FIT TAILS: TIN OVER NICKEL (LF), OR TIN-LEAD ALLOY OVER NICKEL (NON-LF). SEE P/N TREE.

3. PRODUCT SPECIFICATION: GS-12-588 (PRELIMINARY)

4. APPLICATION SPECIFICATION: GS-20-121 (PRELIMINARY)

5. PRODUCT MARKING (PART NUMBER AND LOT CODE) ON THESE SURFACES.

6. HOUSING MUST WITHSTAND EXPOSURE TO 260°C PEAK TEMPERATURE FOR 40 SECONDS IN A CONVECTION, INFRA-RED, OR VAPOR-PHASE REFLOW OVEN.

7. PACKAGING MEETS GS-14-920 LEAD-FREE LABELING SPECIFICATION.

8. NOTCH INDICATES "ROW A" SIDE OF CONNECTOR.

9. SEE APPLICATION SPECIFICATION FOR ROUTING GUIDELINES, ADDITIONAL PTH GUIDELINES, MATED DIMENSIONS, GUIDE PN SELECTION, ETC.

10. SCREW IS OPTIONAL AND ENGAGES WITH BOTTOM OF GUIDE-PIN FROM BENEATH THE PCB FOR ADDITIONAL GUIDE-PIN SUPPORT.

11. OPTIONAL HOLE LOCATION FOR GROUNDED PIN OR ADDITIONAL GUIDE-PIN SUPPORT. SEE TABLE 1 ON SHEET 1 FOR ADDITIONAL DETAILS.

TABLE 3: PTH AND PAD SIZES WITH REFERENCE TO COMPLIANT PIN DRILL		
COMPLIANT PIN DRILL	PTH	PAD
Ø 0.55 [0.0217"]	Ø 0.45±0.05	Ø 0.85
Ø 0.45 [0.0177"]	Ø 0.36±0.05	Ø 0.75

REFER TO TABLE 3 FOR PTH, DRILL & PAD SIZES

⊕ Ø 0.10 X\_BP | Y\_BP

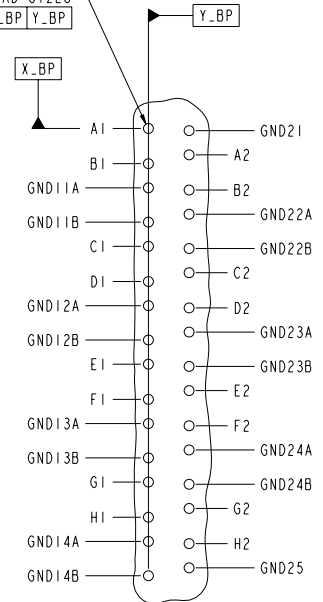

DETAIL A  
SCALE 8:1

spec ref	SEE NOTES	dr	W. J. SWAIN	2009-02-04	projection	MM	size	A2	scale	4:1
tolerance std	TOLERANCES UNLESS OTHERWISE SPECIFIED	eng	NG. R	2011-05-16	chr	NG. R	2011-05-16	ecn no		
ASME Y14.5		appr	C. H. TAN	2011-05-16	product family		XCode	rel level	Released	
surface	linear	0.1	±0.2	0.2X	±0.10	0.2XX	±0.050	ang	10091767	rev
ASME Y14.5	angular	0°	±°							A

PDS: Rev :A STATUS:Released Printed: May 20, 2011