

◆ Home > MDU9SC3570

Part Number: **MDU9SC3570**

General Description

Series	MDU
Configuration	1-9 1-Watt LEDs or 1-4 3-Watt LEDs
Description	MICRODRIVER9 INPUT 85-230VAC
Keywords	Short and open circuit protected
Weight	70 g
Compliance	CE & ENEC
Input Voltage	110-240 Vac 50/60 Hz
Forward Current mA	350 mA or 700 mA
Max V Out	32 VDC
Max Case Temperature	< +85
Operating Temperature	-20 +45
Storage Temperature	-20 +80





110-240 V MICRODRIVERS



FEATURES / BENEFITS

- ▲ Energy efficient switch mode power electronics
- ▲ Short and open circuit protected
- ▲ Small compact size
- ▲ Rugged design with terminal cover & cable grip
- ▲ Over-voltage protection
- ▲ Resetting thermal shutdown safety feature
- ▲ UL recognized component
- ▲ Meets lighting approbation requirements (CE & ENEC)

OPERATING CONDITIONS

- ▲ Operating Ambient Temperature: -20°C to +45°C
(-4°F to +113°F)
- ▲ Ambient Storage Temperature: -20°C to +80°C
(-4°F to +176°F)
- ▲ Maximum Case Temperature: <+85°C (185°F)
- ▲ Input Voltage 110-240Vac 50 / 60 Hz
- ▲ V_{out} : MDU4 = 4-15VDC, MDU9 = 4-32VDC

APPLICATIONS

- ▲ Architectural lighting
- ▲ Cove & cornice lighting
- ▲ Display case lighting
- ▲ Signage
- ▲ Reading lamps
- ▲ Marker & orientation lights
- ▲ Landscape lighting
- ▲ Refridgeration lighting

PART NUMBERS

Part Number	Description	LED Configuration
MDU4-SC-35	MicroDriver 4 SC	1-4 1 Watt LEDs
MDU9-SC-3570	MicroDriver 9 SC	1-9 1 Watt LEDs <u>or</u> 1-4 3 Watt LEDs

MECHANICAL DRAWING

PHYSICAL ASSEMBLY

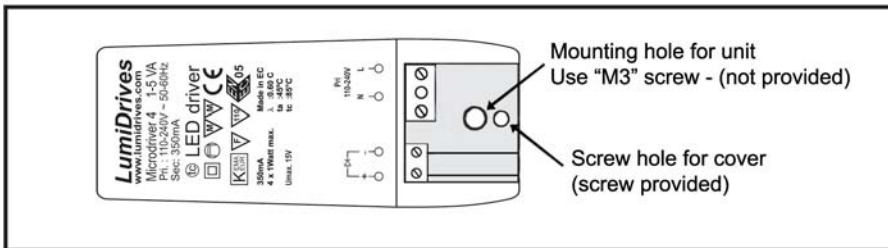

Easily removable cover

MDU4-SC-35 - 1 x 4 LEDs (350mA)

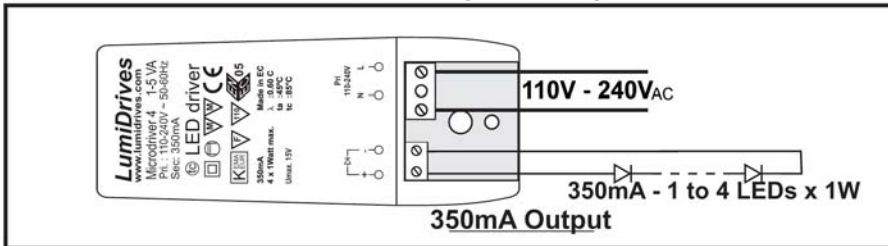

Input and output screw terminations

MDU9-SC-35/70 - 1 x 9 LEDs (350mA)

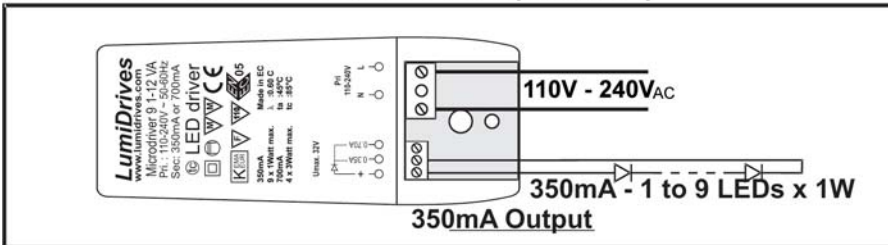

MDU9-SC-35/70 1 x 4 LEDs (700mA)

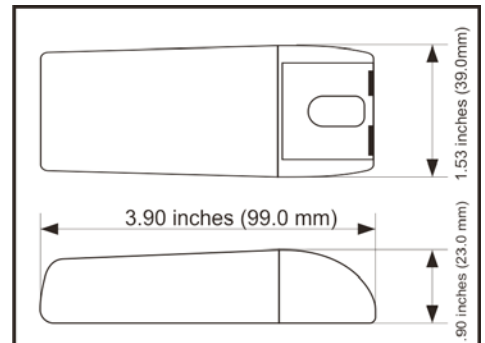
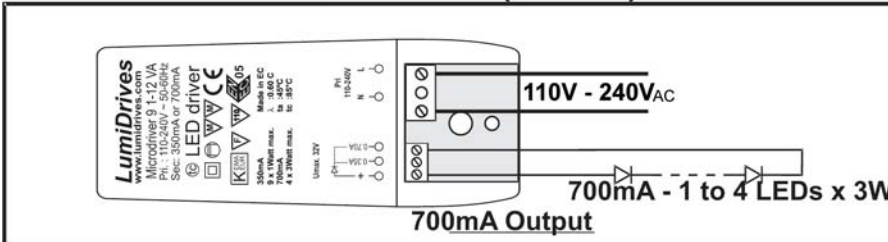

MDU9-SC-35/70



Microdriver 9

The MDU9-SC-35/70 is designed for driving 9 x 1W LEDs at 350mA or 4 x 3W LEDs at 700mA from a 110 - 240V AC supply.

Order codes: MDU9-SC-3570

Dimensions: L99mm x W39mm x H23mm

Weight: 70g

