

| PRODUCT NO NOTE 8 | PLATING CONTACT AREA | PLATING SOLDER TAIL | |
|----------------------|--|--|-------------|
| 68683-2XX | 15u"/.38u Au MIN OVER 50u"/1.27u Ni MIN | 100u"/160u" ^{SN} 2.54u"/4.06u" | SEE NOTE 11 |
| 68683-3XX | 30u"/.76u Au MIN OVER 50u"/1.27u Ni MIN | 100u"/160u" ^{SN} 2.54u"/4.06u" | SEE NOTE 11 |
| 68683-4XX | 100u"/160u" ^{SN} 2.54u"/4.06u" | 100u"/160u" ^{SN} 2.54u"/4.06u" | |
| 68683-6XX | 30u"/.76u Au MIN OVER 50u"/1.27u Ni MIN | 100u"/160u" ^{SN} 2.54u"/4.06u" | SEE NOTE 11 |
| 68683-8XX | 30u"/.76u Au MIN OVER 50u"/1.27u Ni MIN | 100u"/160u" ^{SN} 2.54u"/4.06u" | OBSOLETE |

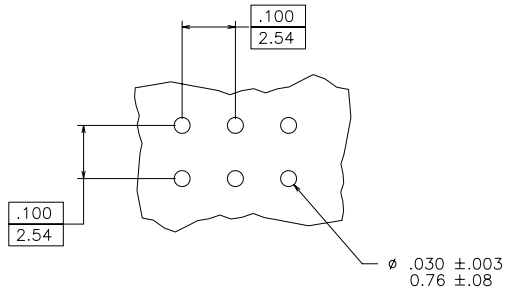

FIGURE A

NOTES:

1. MATERIAL TERMINAL: PHOSPHOR BRONZE,
2. RECOMMENDED APPLICATION DATA:
 - A. RECOMMENDED HOLE PATTERN IS SHOWN IN FIGURE A.
 - B. ALL MATING PINS TO BE .025/.64 SQUARE ON TRUE CENTER OF GIVEN TERMINAL SPACINGS WITHIN .015/.38 DIA.
 - C. SUGGESTED MATING PIN LENGTH .210±.020/5.33±.51
 - D. RECOMMENDED PC BOARD THICKNESS: .062/1.58
- ③ MATERIAL HOUSING P.P.S. FILLED, COLOR BLACK, FLAME RETARDANT PER UL 94V-0
THIS PART WILL WITHSTAND EXPOSURES TO 260°C PEAK TEMPERATURE FOR 20 SECONDS IN WAVE SOLDER, INFRA-RED OR VAPOR PHASE SOLDER PROCESS.
- 4 FCI, FCI FINAL PART NUMBER AND DATE CODE TO BE MARKED ON TUBE LABEL.
5. PREPLATED, STAMPED TERMINALS.
6. PART NUMBER WITH SUFFIX "U" IS FOR SAWING PURPOSES ONLY.
- ⑦ STANDARD TUBE PACKAGE PER BUS-14-097/3.
- ⑧ ADD LF SUFFIX AT THE END OF PART NUMBER FOR LEAD FREE OPTION.
9. THESE PRODUCTS MEETS EUROPEAN UNION DIRECTIVES AND OTHER COUNTRY REGULATION AS DESCRIBED IN GS-22-008.
- ⑩ "THIS PRODUCT HAS 100% TIN PLATING IN THE INTERFACE AND HAS NOT BEEN TESTED FOR WHISKER GROWTH IN ALL INTERCONNECT ENVIRONMENT".
- ⑪ PLATING OPTIONS:
MAY BE EITHER GOLD OR GXT PLATED AT MANUFACTURER'S OPTION.

| | | | | |
|---------------------------------------|-------------|-------------------|------------|--|
| mat'l. code | surface | tolerance | projection | product family |
| - | ISO 1302 | ISO 406 | ⊕ | DUBOX |
| itr | ecn | no | dr | date |
| S | | | | |
| tolerances unless otherwise specified | | xx ±.01/3 | INCH/MM | title |
| angles | linear | .xxx ±.005/13 | scale 4:1 | DUBOX DBL. ROW VERT. CARD CONNECTOR ASS'Y. |
| 0°±2° | | .xxxx ±.0020/.051 | FCJ | dwg no |
| dr | J. SHREINER | 02/05/91 | | 68683 |
| enrg | M. HAHN | 02/05/91 | | sheet 2 of 4 size |
| chr | M. HAHN | 02/05/91 | | A3 |
| appd | M. HAHN | 02/05/91 | | type |
| sheet | revision | | | Product Customer Drawing |
| index | sheet | | | |

| PRODUCT NUMBER | NO. OF POSITION | C DIM | D DIM | LF OPTION |
|----------------|-----------------|-------------|-------------|-----------|
| 68683-Y02 | 2 X 2 | .100/2.54 | .217/5.51 | NOTE 8 |
| -Y03 | 2 X 3 | .200/5.08 | .317/8.05 | |
| -Y04 | 2 X 4 | .300/7.62 | .417/10.59 | |
| -Y05 | 2 X 5 | .400/10.16 | .517/13.13 | |
| -Y06 | 2 X 6 | .500/12.70 | .617/15.67 | |
| -Y07 | 2 X 7 | .600/15.24 | .717/18.21 | |
| -Y08 | 2 X 8 | .700/17.78 | .817/20.75 | |
| -Y09 | 2 X 9 | .800/20.32 | .917/23.29 | |
| -Y10 | 2 X 10 | .900/22.86 | 1.017/25.83 | |
| -Y11 | 2 X 11 | 1.000/25.40 | 1.117/28.37 | |
| -Y12 | 2 X 12 | 1.100/27.94 | 1.217/30.91 | |
| -Y13 | 2 X 13 | 1.200/30.48 | 1.317/33.45 | |
| -Y14 | 2 X 14 | 1.300/33.02 | 1.417/35.99 | |
| -Y15 | 2 X 15 | 1.400/35.56 | 1.517/38.53 | |
| -Y16 | 2 X 16 | 1.500/38.10 | 1.617/41.07 | |
| -Y17 | 2 X 17 | 1.600/40.64 | 1.717/43.61 | |
| -Y18 | 2 X 18 | 1.700/43.18 | 1.817/46.15 | |
| -Y19 | 2 X 19 | 1.800/45.72 | 1.917/48.69 | |
| -Y20 | 2 X 20 | 1.900/48.26 | 2.017/51.23 | |
| -Y21 | 2 X 21 | 2.000/50.80 | 2.117/53.77 | |
| -Y22 | 2 X 22 | 2.100/53.34 | 2.217/56.31 | |
| -Y23 | 2 X 23 | 2.200/55.88 | 2.317/58.85 | |
| -Y24 | 2 X 24 | 2.300/58.42 | 2.417/61.39 | |
| 68683-Y25 | 2 X 25 | 2.400/60.96 | 2.517/63.93 | |

| | | | | |
|-------------|---------------------------------------|------------------|------------|--|
| mat'l. code | surface | tolerance | projection | product family |
| - | ISO 1302 | ISO 406 | | DUBOX |
| ISO 1101 | tolerances unless otherwise specified | .XX ±01/3 | INCH/MM | title |
| angles | linear | .XXX ±.005/13 | scale 4:1 | DUBOX DBL. ROW VERT. CARD CONNECTOR ASS'Y. |
| 0°±2' | dr | XXXX ±.0020/.051 | | dwg no 68683 sheet 3 of 4 size A3 |
| engr | J. SHREINER | 02/05/91 | | type Product Customer Drawing |
| chr | M. HAHN | 02/05/91 | | |
| appd | M. HAHN | 02/05/91 | | |
| sheet index | revision sheet | | | |

PDM: Rev:S STATUS:Released Printed: Dec 01, 2010

| PRODUCT NUMBER | NO. OF POSITION | C DIM | D DIM | LF OPTION |
|----------------|-----------------|--------------|--------------|-----------|
| 68683-Y26 | 2 X 26 | 2.500/63.50 | 2.617/66.47 | NOTE 8 |
| -Y27 | 2 X 27 | 2.600/66.04 | 2.717/69.01 | |
| -Y28 | 2 X 28 | 2.700/68.58 | 2.817/71.55 | |
| -Y29 | 2 X 29 | 2.800/71.12 | 2.917/74.09 | |
| -Y30 | 2 X 30 | 2.900/73.66 | 3.017/76.63 | |
| -Y31 | 2 X 31 | 3.000/76.20 | 3.117/79.17 | |
| -Y32 | 2 X 32 | 3.100/78.74 | 3.217/81.71 | |
| -Y33 | 2 X 33 | 3.200/81.28 | 3.317/84.25 | |
| -Y34 | 2 X 34 | 3.300/83.82 | 3.417/86.79 | |
| -Y35 | 2 X 35 | 3.400/86.36 | 3.517/89.33 | |
| -Y36 | 2 X 36 | 3.500/88.90 | 3.617/91.87 | |
| -Y37 | 2 X 37 | 3.600/91.44 | 3.717/94.41 | |
| -Y38 | 2 X 38 | 3.700/93.98 | 3.817/96.95 | |
| -Y39 | 2 X 39 | 3.800/96.52 | 3.917/99.49 | |
| -Y40 | 2 X 40 | 3.900/99.06 | 4.017/102.03 | |
| -Y41 | 2 X 41 | 4.000/101.60 | 4.117/104.57 | |
| -Y42 | 2 X 42 | 4.100/104.14 | 4.217/107.11 | |
| -Y43 | 2 X 43 | 4.200/106.68 | 4.317/109.65 | |
| -Y44 | 2 X 44 | 4.300/109.22 | 4.417/112.19 | |
| -Y45 | 2 X 45 | 4.400/111.76 | 4.517/114.73 | |
| -Y46 | 2 X 46 | 4.500/114.30 | 4.617/117.27 | |
| -Y47 | 2 X 47 | 4.600/116.84 | 4.717/119.81 | |
| -Y48 | 2 X 48 | 4.700/119.38 | 4.817/122.35 | |
| -Y49 | 2 X 49 | 4.800/121.92 | 4.917/124.89 | |
| 68683-Y50 | 2 X 50 | 4.900/124.46 | 5.017/127.43 | |
| 68683-Y50U | 2 X 50 | 4.900/124.46 | 5.017/127.43 | |

SEE NOTE 6

| | | | | |
|---------------------------------------|----------------|------------------|------------|--|
| mat'l. code | surface | tolerance | projection | product family |
| - | ISO 1302 | ISO 406 | | DUBOX |
| itr | ecn | no | dr | date |
| S | | | | |
| tolerances unless otherwise specified | | XX ±0.1/3 | INCH/MM | title |
| angles | linear | .XXX ±.005/13 | scale 4:1 | DUBOX DBL. ROW VERT. CARD CONNECTOR ASS'Y. |
| 0°±2' | | XXXX ±.0020/.051 | | dwg no 68683 sheet 4 of 4 size A3 |
| dr | J. SHREINER | 02/05/91 | | type Product Customer Drawing |
| enrg | M. HAHN | 02/05/91 | | |
| chr | M. HAHN | 02/05/91 | | |
| appd | M. HAHN | 02/05/91 | | |
| sheet index | revision sheet | | | |

PDM: Rev:S STATUS:Released Printed: Dec 01, 2010