

SCHAFFNER type FN261 & FN9260 (fused)

A range of general purpose IEC mains filters with built-in 20mm fuseholder, providing the option of a single or twin fuse arrangement (for suitable fuses, refer to the Fuse section in this guide). IEC950 compliant. All types are fitted with a bleed resistor to discharge residual energy when pins are exposed. Available in screw fixing or snap-fit form with rear terminations by 6.35mm (0.25in) fast-on tabs. Each series offers a choice of current rating from 1A to 10A.

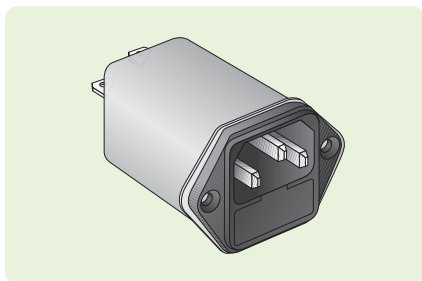

- ◆ IEC power inlet with built-in 20mm fuseholder
- ◆ Single or twin fuse arrangement
- ◆ Integral mains filter unit
- ◆ IEC950 compliant
- ◆ Choice of current rating
- ◆ Panel mounting, rear fast-on tabs
- ◆ Option of screw fixing or snap-in



Specification

Voltage rating	250Vac
Line frequency	50/60Hz
Max. leakage	0.19mA/phase
Hipot test (1 min.)	
LN to E	2000Vac
L to N	1700Vdc
Capacitance	
Cx	0.1µF(X)
Cy	2200pF(Y) x 2
Inductance	
L	as listed
Resistance	
R	1MΩ
Weight	50g
Operating temperature range	-25°C to +85°C

Dimensions (mm)

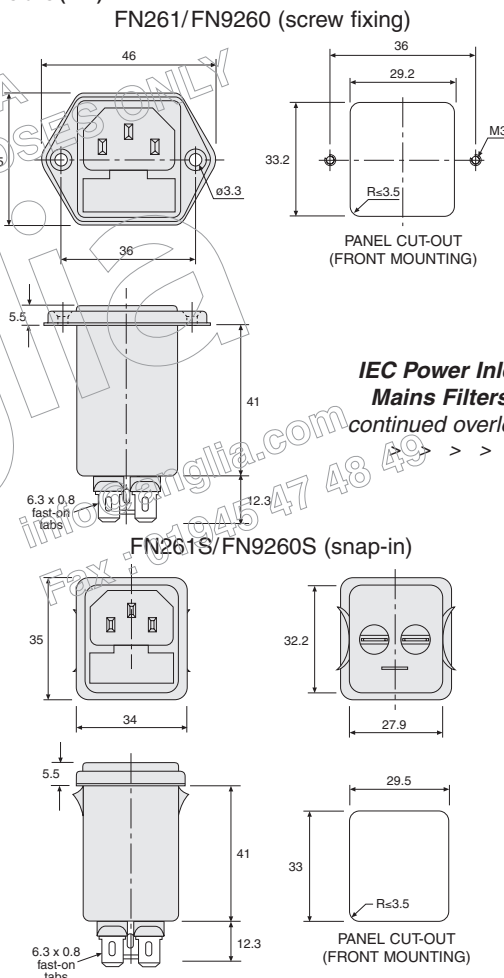

IEC Power Inlet
Mains Filters
continued overleaf

Current Rating (Aac) at 40°C	Inductance (mH) L	Manf. Part No. & Anglia Order Code	
		Single Fuse	Twin Fuse
FN261/FN9260 - screw fixing			
1	5.3	FN261-1/06	FN9260-1/06
2	2.7	FN261-2/06	FN9260-2/06
4	1	FN261-4/06	FN9260-4/06
6	0.3	FN261-6/06	FN9260-6/06
10	0.2	FN261-10/06	FN9260-10/06
FN261S/FN9260S - snap-in			
1	5.3	FN261S-1/06	FN9260S-1/06
2	2.7	FN261S-2/06	FN9260S-2/06
4	1	FN261S-4/06	FN9260S-4/06
6	0.3	FN261S-6/06	FN9260S-6/06
10	0.2	FN261S-10/06	FN9260S-10/06

SCHAFFNER FACTORY OPTIONS

- The FN9260 series without Y capacitors, for medical applications
- Rear insulating boots

Please contact our Sales Desk for details.

Schematic

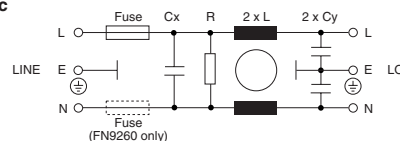

A RANGE OF IEC LEADS AND PUSH-ON CRIMP TERMINALS ARE SHOWN IN THE CONNECTORS SECTION