

Actual information about approvals can be found on
<http://www.schurter.com/approvals>



0720-FS

C8



70° C



0721-PS

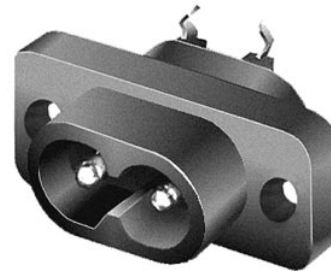

0720-FP

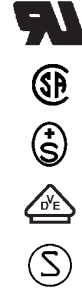

Description

- Panel mount:
- Screw-on version [0720-FP; 0720-FS]; Snap-in version [0721-PP; 0721-PS]; from front or rear-side [0720-FP; 0720-FS]; from front side [0721-PP; 0721-PS] Connector,
- [0720-FS] Pin temperature 70 °C, Protection class II
- PCB [0720-FP; 0721-PP]; Solder terminals [0720-FS; 0721-PS]

Technical data

Ratings IEC	2.5 A / 250 VAC; 50 Hz
Ratings UL/CSA	2.5 A / 250 VAC; 60 Hz
Dielectric strength	> 2 kVAC between L-N (1 min/50 Hz)
Allowable operation temp.	-25 °C to 70 °C
Degree of protection	from front side IP40 acc. to IEC 60529
Protection class	Suitable for appliances with protection class II acc. to IEC 61140

Terminals [0720-FP; 0721-PP]	PCB solder terminals
Terminals [0720-FS; 0721-PS]	Solder terminals
Panel thickness s [0720-FP]	Screw-on: from 4 mm max 4 mm Mounting screw torque max 0.5 Nm
Panel thickness s [0721-PP; 0721-PS]	Snap-in from 0.8-1.2 mm
Panel thickness s [0720-FS]	Screw-on: max 4 mm Mounting screw torque max 0.5 Nm
Materials: Housing	Thermoplastic, black, UL 94V-0
Appliance-inlet /-outlet	C8 acc. to IEC/EN 60320-1, UL 498, CSA C22.2 no. 42 (for cold condition) pin-temperature 70 °C, 2.5 A, Protection class II

Dimensions

0720-FS

0720-FP

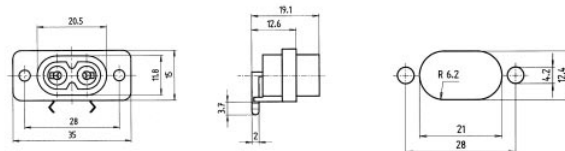
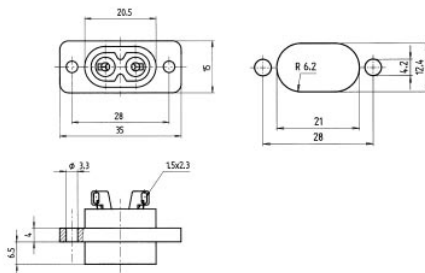

Solder terminals for wires

Solder terminals for PCB

Drilling diagrams

PCB Layout

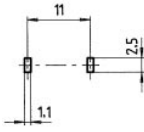

PCB Layout

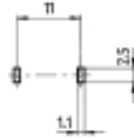

Variants

Order Number	Type	Panel mounting	Panel thickness s [mm]	Terminals
4300.0097	0720-FP	Screw-on		PCB solder terminals
4300.0099	0721-PP	Snap-in	0.8-1.2	PCB solder terminals
4300.0096	0720-FS	Screw-on	4	Solder terminals
4300.0098	0721-PS	Snap-in	0.8-1.2	Solder terminals

Packaging unit 50 Pcs