

IEC appliace inlet C20, screw-on mounting, front side, solder/quick connect terminal



4798

C20



70° C



Description

- Panel Mount:
- Screw-on from front side
- Inlet, Pin temperature 70 °C, Protection class I
- Solder terminals or quick connect terminals

Weblinks

Approvals, RoHS, CHINA-RoHS, e-Store, SCHURTER-Stock-Check, Distributor-Stock-Check

Technical Data

| | |
|---------------------------|---|
| Ratings IEC | 16A / 250VAC; Hz 50 |
| Ratings UL/CSA | 20A / 250VAC; 60Hz |
| Dielectric Strength | > 2.2kVAC between L-N > 4kVAC between L/N-PE (1 min/50Hz) |
| Allowable Operation Temp. | -25 °C to 70 °C |
| Degree of Protection | from front side IP 40 acc. to IEC 60529 |
| Protection Class | Suitable for appliances with protection class I acc. to IEC 61140 |
| Terminal | Solder terminals or quick connect terminals |
| Panel Thickness s | Screw-on: max 8 mm Mounting screw torque max 0.5 Nm |
| Material: Housing | Thermoplastic, black, UL 94V-0 |

| | |
|--------------------------|--|
| Appliance-Inlet /-Outlet | C20 acc. to IEC/EN 60320-1, UL 498, CSA C22.2 no. 42 (for cold condition) pin-temperature 70 °C, 16A, Protection class I |
|--------------------------|--|

Dimensions

4798

Length 53 mm

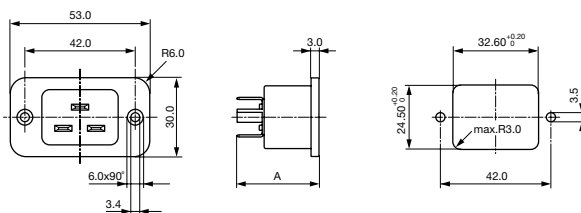

A = 31.5 mm: quick-connect terminals 6.3 x 0.8 mm

A = 30 mm: quick-connect terminals 4.8 x 0.8 mm

A = 28.5 mm: solder terminals

Variants

Distributor-Stock-Check | SCHURTER-Stock-Check | e-Store

| Panel mounting | Panel Thickness s [mm] | Terminal | Order Number |
|----------------|------------------------|--------------------------------------|--------------|
| Screw-on | - | Quick connect terminals 4.8 x 0.8 mm | 4798.9100 |
| Screw-on | - | Quick connect terminals 6.3 x 0.8 mm | 4798.9000 |
| Screw-on | - | Solder terminals | 4798.9200 |

Packaging unit 100 Pcs

Accessory

Description

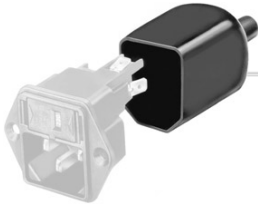

Assorted Covers
Rear Cover



Cord retaining kits
Cord retaining strain relieve
