

FCI CONFIDENTIAL

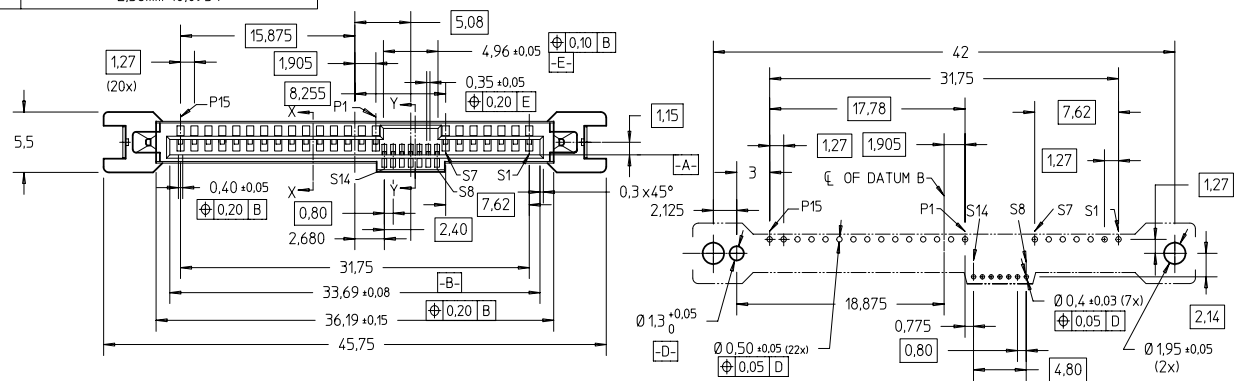

This document is the property of and embodies CONFIDENTIAL and PROPRIETARY information of FCI. No part of the information shown herein may be disclosed, copied, or otherwise used without the written consent of FCI. Copyright FCI.

PRODUCT NO	DIM L	RECOMMENDED P.C. BOARD THICKNESS
10018182-001LF	2.70	1.57mm (0.062") / 2.36mm (0.093")
10018182-011LF	3.70	2.36mm (0.093")



RECOMMENDED P.C.B. LAYOUT

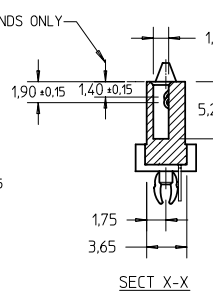
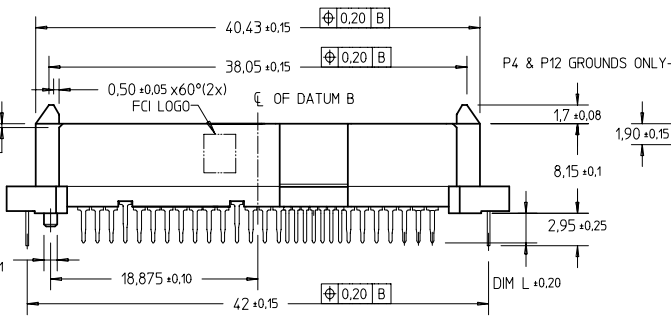
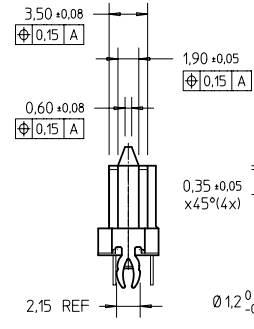

SECT X-X

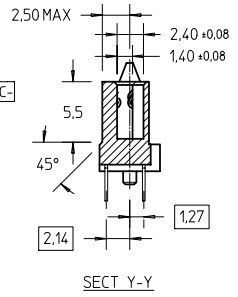

SECT Y-Y

NOTES:

- 1 MATERIAL:
  - 1) HOUSING : HIGH TEMP TERMOPLASTIC, UL 94V-0 COLOR : BLACK
  - 2) TERMINAL : COPPER ALLOY
  - 3) HOLD DOWN : COPPER ALLOY
- 2 FINISH :
  - 1) TERMINAL : 30u" Au PLATING (CONTACT POINT) OVER 50u" NICKEL
  - 2) SOLDER TAIL : 50u" min Sn OVER 50u" NICKEL
  - 3) HOLD DOWN : 50u" min Sn OVER 50u" NICKEL
  - 3) PER SFF REV 11, EXCEPT 0.8mm PITCH BUMP AREA.
  - 4) THE STD PACKAGING IS IN TRAY.
- 5 THE HOUSING WILL WITHSTAND EXPOSURE TO 260°C PEAK TEMPERATURE FOR 10 SECONDS IN A WAVE SOLDER APPLICATION WITH A 157mm MINIMUM THICK CIRCUIT BOARD.
- 6 THIS PRODUCT MEETS EUROPEAN UNION DIRECTIVES AND OTHER COUNTRY REGULATIONS AS DESCRIBED IN GS-22-008.
- 7 PART NUMBERS ENDING IN "LF" MEANS FOR NOTE 6 LEAD FREE IDENTIFICATION. P/N XXXXXXXX-XXLF IS EQUIVALENT TO PREVIOUS P/N XXXXXXXX-XXX.

mat'l. code		surface	tolerance	projection	product family
		ISO 1302	ISO 406 ISO 1101		SAS
itr	ecn no	dr	date	tolerances unless otherwise specified	
A	S04-0026	GLL	2004-02-27	angles	mm
B	S04-0201	GLL	2004-09-27	linear	
C	S05-0026	GLL	2005-02-14	± 2°	scale 2 : 1
D	S06-0281	GLL	2006-08-28	dr	GL L00 2004-02-27
				engr	GL L00 2004-02-27
				chr	GL L00 2006-08-28
				appd	JOEY NS 2006-08-28
sheet	revision	D			
index	sheet	1			

PDM: Rev:D STATUS: Released Printed: 09/16/2009