

LOC	DISP	REV	DESCRIPTION	DATE	BY	APPD
-	-	1	REVISED PER ECO-11-005294	01APR2011	JK	HMR

NOTES: UNLESS OTHERWISE SPECIFIED:
 1. INTERPRET DRAWING PER ASME Y14.5M - 1994.

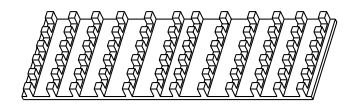
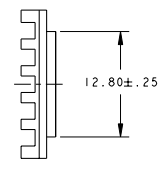

SCALE = 2X

ANODIZED BLACK (MIL-A-8625 TYPE 11)	1542656-3
ELECTROLESS NICKEL	1542656-2
FINISH	PART NUMBER

THIS DRAWING IS A CONTROLLED DOCUMENT.		DATE	3-26-03	
DRAWN BY: TAO		DATE	3-26-03	
CHECKED BY: S. G.		DATE		TE XFP, MSA PCI APPLICATION HEATSINK 4.2mm TALL
APPROVED BY:		DATE		
DIMENSIONS: mm		PRODUCT SPEC		SHEET CASE CODE DRAWING NO A2 - ©-1542656
TOLERANCES UNLESS OTHERWISE SPECIFIED:		APPLICATION SPEC		
0 PLC	±.5	WEIGHT		RESTRICTED TO CUSTOMER DRAWING
1 PLC	±.5	SCALE	4:1	
2 PLC	±.25	SHEET	1	
3 PLC	±.100	OF	1	
4 PLC	±.100	REV	1	
ANGLES	±1°			
FINISH	SEE TABLE			