

Copyright FCI.

rev	ecn no	dr	date
A	S04-0177	JPEH	2004-08-23
B	S04-0193	LWH	2004-09-20
C	S05-0032	YEO	2005-02-03
D	S07-0049	CWL	2007-02-14

www.fciconnect.com		surface ASME Y14.5	tolerance std ASME Y14.5	projection	MM
Dr JPEH 2004-08-28		ANGULAR	0.x ±---	size A4	Scale 2:1
Eng WL CHOONG 2007-02-14		LINEAR	0.xx ±0.2	ECN S07-0049	
Chr WL CHOONG 2007-02-14		2° ±*	0.xxx ±---	Spec ref	
Appr JOEY NG 2007-02-14		Product family SATA			
FCI S-ATA COMB RECEPTACLE				part no	10034814
R/A SMT TYPE ASSY				Rev.	D
catalog no				CUSTOMER	sheet 1 of 2

PDM: Rev:D STATUS:Released 4 Printed: Nov 30, 2010



Copyright FCJ.

A

B

C

D

1 2 3 4

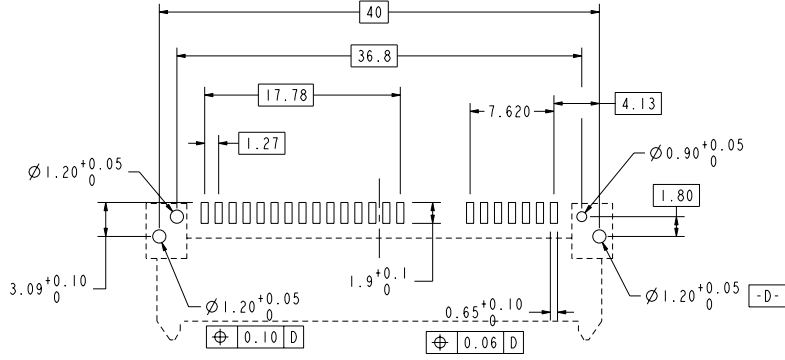

RECOMMENDED P.C.B. LAYOUT  
TOLERANCE UNLESS OTHERWISE : ±0.1

NOTES :-

1. MATERIAL:
  - 1) HOUSING : HIGH TEMP. THERMOPLASTIC, UL 94V-0
  - COLOR : BLACK
  - 2) TERMINAL : COPPER ALLOY
  - 3) HOLD DOWN : COPPER ALLOY
2. FINISH:
  - 1) TERMINAL : 30u" Au PLATING (CONTACT POINT) OVER 50u" MIN NICKEL
  - 2) SOLDER TAIL : 100u" MIN TIN OVER 50u" NICKEL
  - 3) HOLD DOWN : 100u" MIN TIN OVER 50u" NICKEL
3. TRUE POSITION APPLY AT TERMINAL TIP
4. THE STANDARD PACKAGING IS IN TRAY.
5. THE HOUSING WILL WITHSTAND EXPOSURE TO 260°C PEAK TEMPERATURE FOR 10 SECONDS IN A CONVECTION, INFRA-RED OR VAPOR PHASE REFLOW OVEN
6. THIS PRODUCT MEETS EUROPEAN UNION DIRECTIVES AND OTHER COUNTRY REGULATIONS AS DESCRIBED IN GS-22-008
7. PART NUMBERS ENDING IN "LF" ARE MEANT FOR LEAD-FREE IDENTIFICATION. P/N XXXXXXXX-XXXLF IS EQUIVALENT TO PREVIOUS P/N XXXXXXXX-XXX

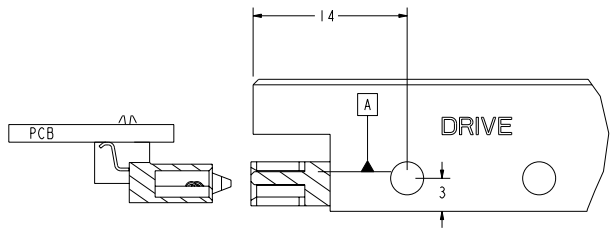

S-ATA Connector mounting view

REV F - 2004-04-17

	title	S-ATA COMB RECEPTACLE	dwg no	10034814	Rev.	D
		R/A SMT TYPE ASSY				
	catalog no		CUSTOMER	sheet 2 of 2		

PDM: Rev:D STATUS:Released 4 Printed: Nov 30, 2010