

PRODUCT NO.
10034524-001LF
10034524-002LF

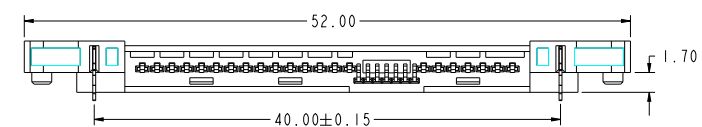
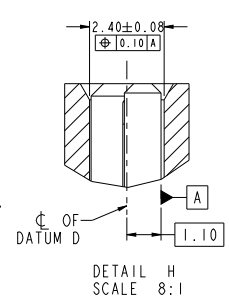
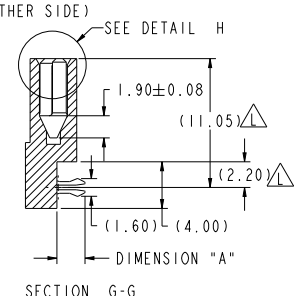
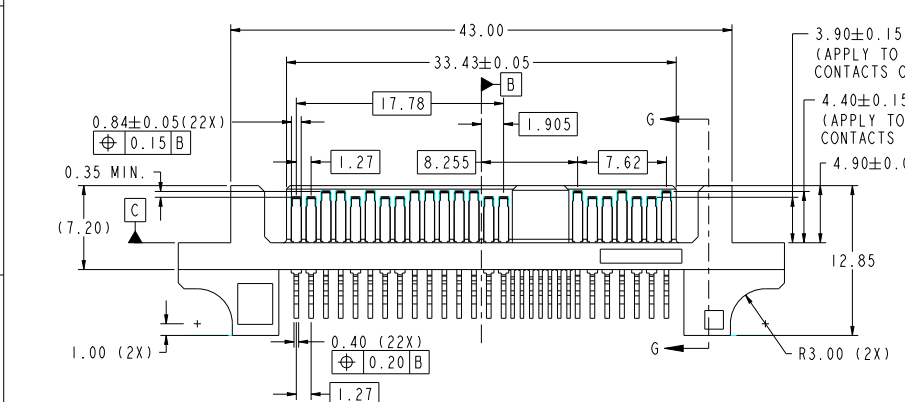
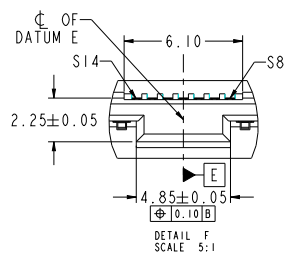
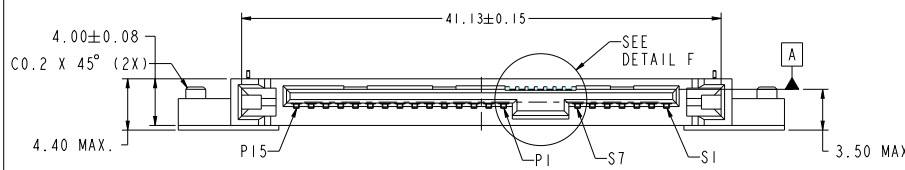

spec ref		dr	wadmin	20100715	projection	MM	size	A3	scale	3:1
tolerance std	ASME Y14.5	eng	Jiffy Lin	20110221			ecn no	ELK-002469-1		
	TOLERANCES UNLESS OTHERWISE SPECIFIED	chr					rel level	Released		
surface	linear	0.X	±0.20		product family		rel level	Released		
	0.XX	±0.20	www.fci.com		title	SAS PLUG R/A	dwg no	10034524	rev	L
	0.XXX	±0.20	cat. no.		Product - Customer Drw	sheet 1 of 3				
ASME Y14.5	angular	A	±2°							

Prod File - Rev C - 2009-08-09

PDS: Rev -L STATUS:Released Printed: Feb 21, 2011

Copyright FCI

PRODUCT NO.
10034524-003CLF

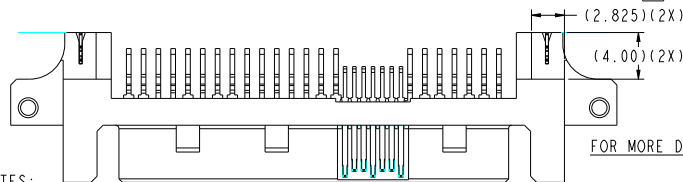
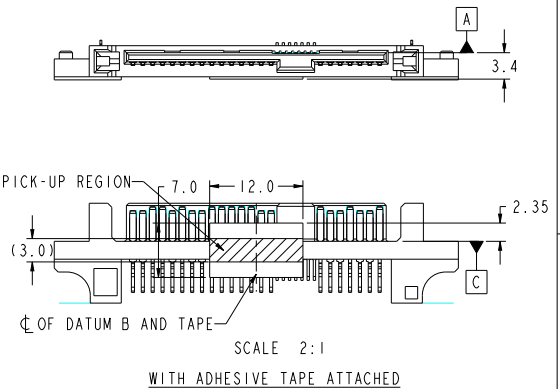
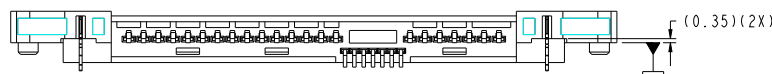
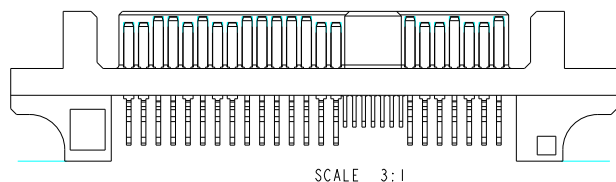

FOR MORE DIMENSIONS, REFER TO 10034524-001/2

NOTES:

- MATERIAL:
HOUSING: HIGH TEMPERATURE PLASTIC, BLACK, UL94V-0
CONTACT & HOLD DOWN: COPPER ALLOY
- FINISH:
CONTACT: 1.27um Min. NICKEL UNDERPLATE OVERALL,
1.91um Min. 100% MATTE TIN(LEAD-FREE) ON SOLDER TAIL,
0.76um Min. GOLD ON CONTACT AREA
HOLD DOWN: 1.91um Min. 100% MATTE TIN(LEAD-FREE) OVER
1.27um Min. NICKEL UNDERPLATE OVERALL
- RECOMMENDED PCB THICKNESS: 1.20 & 1.60mm
- PRODUCT SPECIFICATION: GS-12-282
- PACKAGING SPECIFICATION: GS-14-952(TRAY); GS-14-1038(TAPE & REEL)
- THIS PRODUCT MEETS EUROPEAN UNION DIRECTIVES AND OTHER COUNTRY REGULATIONS AS DESCRIBED IN GS-22-008
- THE HOUSING WILL WITHSTAND EXPOSURE TO 260°C PEAK TEMPERATURE FOR 10 SECONDS IN A CONVECTION, INFRA-RED OR VAPOR PHASE REFLOW OVEN
- A SYMBOL WILL BE NEXT TO ANY DIMENSION, VIEW OR NOTE WHICH HAS BEEN MODIFIED WITH THE CURRENT DRAWING REVISION

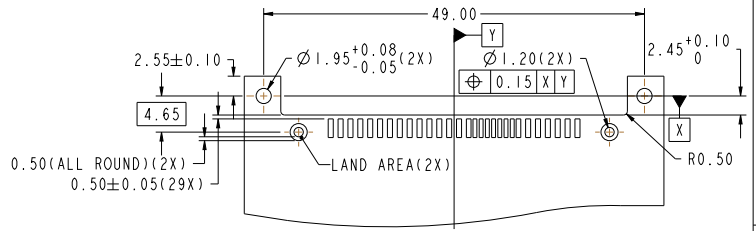

RECOMMENDED PAD LAYOUT FOR 10034524-003(GENERAL TOLERANCE: ±0.08)
(FOR MORE DIMENSIONS, REFER TO PAD LAYOUT FOR 10034524-001/-002)

spec ref	dr	wadmin	20100715	projection	MM	size	A3	scale	3:1
tolerance std	eng	Jiffy Lin	20110221	product family		ecn no	ELK-00240-1	rel level	Released
ASME Y14.5	chr			www.fci.com	SAS PLUG R/A	cat. no.	10034524	rev	L
	appr				TYPE ASSY	Product - Customer Drw	sheet 3 of 3		
surface	linear	0.X	±0.20						
		0.XX	±0.20						
		0.XXX	±0.20						
ASME Y14.5	angular	A	±2°						

Prod File - Rev C - 2009-06-09

PDS: Rev .L

STATUS:Released

Printed: Feb 21, 2011