

Tous droits strictement réservés. Reproduction ou communication à des tiers  
interdite sous quelque forme que ce soit sans autorisation écrite du propriétaire.  
Propriété de c FCI. Droits de reproduction FCI.

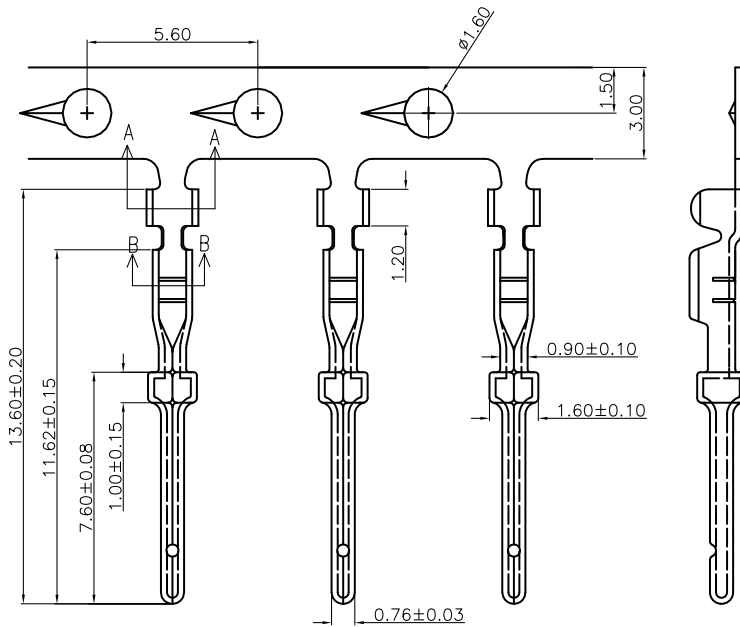

All rights strictly reserved. Reproduction or issue to third parties in any  
form whatever is not permitted without written authority from the proprietor.  
Property of FCI. Copyright FCI.



REMARK:  
1. MATERIALS:  
CONTACTS: COPPER ALLOY, GOLD (GVF or 30u") TOP OVER CONTACT AREA,  
50u" Min. NICKEL UNDER PLATE.

2. PART NUMBER DESCRIPTION:  
**10090932-P XX X X LF**

SERIES NO.	10090932-P	XX	X	X	LF
TYPE	P: FN (MALE)				
GAUGE SIZE	24, 24-28(AWG)				
PACKAGING					LF: ROHS COMPLIANT
					8: BOX, 500 PCS
					9: REEL, 10K PCS
					CONTACT FINISH
					4: GOLD FLASH
					6: 30V SLD

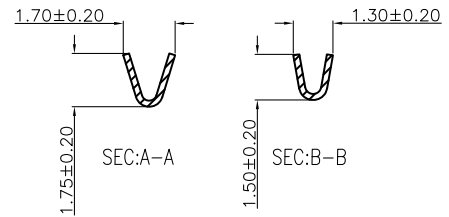

SIZE	PART NO.	PACKAGING
24-28AWG	10090932-P24*8LF	BOX, 500PCS
24-28AWG	10090932-P24*9LF	REEL, 10KPCS

mat'l. code				tolerances unless otherwise specified		CUSTOMER COPY		FCI		www.fciconnect.com	
ltr	ecn no	dr	date	linear	.X ± 0.38	projection	title				
A	109-1157	J.H	12/10/09		.XX ± 0.25		H/D D-SUB CRIMPING MALE CONTACT				
				angles	.XXX ± 0.10		MM	product family	D-SUB		code
				dr	0° ± 2°	scale	size	dwg no	10090932		TWN
				enrg	JASON HSU 12/10/09	1:1					sheet
				chr	GARY HSIEH 12/10/09						1 of 1
				appd	JOSEPH HSIA 12/10/09						
sheet index	revision sheet	A	01								

ACAD PDM: Rev:A STATUS:Released Printed: Feb 24, 2010