

6

5

4

3

2

1

MATERIAL NUMBER	OLD PART NUMBER	COUPLING NUT MATERIAL	COUPLING NUT FINISH
130017-0018	1A4002-34	BRASS	NICKEL PLATED
130017-0019	1A4002-348	STAINLESS STEEL	PASSIVATED

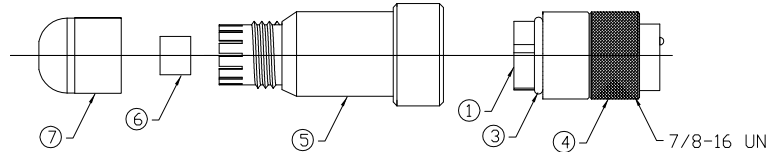
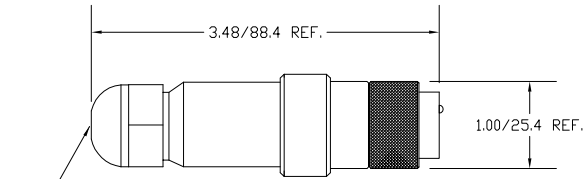
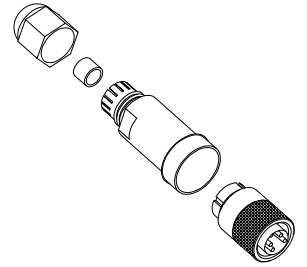

O.D. CABLE RANGE  
.20-.48/5.0-12.0

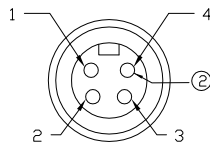

MALE FACE VIEW

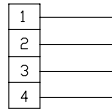

WIRING CHART

VOLTAGE RATING	600VAC/VDC
AMPERAGE RATING	13 AMPS
PROTECTION	IP67
OPERATING TEMPERATURE	-20°C TO 80°C
CSA CERTIFICATIONS	CSA CERTIFIED, FILE NO. LR6837

ITEM	COMPONENT	MATERIAL	FINISH
1	INSERT	NYLON	BLACK
2	PIN CONTACTS	COPPER ALLOY	GOLD PLATED
3	O-RING	NITRILE	BLACK
4	COUPLING NUT	SEE CHART	SEE CHART
5	MOLDED BODY	NYLON	BLACK
6	GROMMET	NITRILE	BLACK
7	CORD GRIP BODY	NYLON	BLACK

EC NO: WNA2010-0087	7/28/09
DRWN: BWOODMAN	
CHKD: JMI	
APPR: JF MURPHY	2008/09/10
REV	DESCRIPTION
A	

QUALITY SYMBOLS
▽=0
∇=0

GENERAL TOLERANCES (UNLESS SPECIFIED)	
	IN/MM
4 PLACES	±.005 / ±.127
3 PLACES	±.003 / ±.076
2 PLACES	±.002 / ±.051
1 PLACE	±.001 / ±.025
ANGULAR ±.005°	
<b>DRAFT WHERE APPLICABLE MUST REMAIN WITHIN DIMENSIONS</b>	

DIMENSION STYLE	
IN/MM	
DRAWN BY	DATE
BW	2009/07/28
CHECKED BY	DATE
TW	2009/07/29
APPROVED BY	DATE
MATERIAL NO.	
SEE CHART	
SIZE	A

SCALE	DESIGN UNITS	THIRD ANGLE PROJECTION
---	---	☉
TITLE		
MINI 4P MALE ATTACH INT. .20-.48 O.D. CABLE RANGE		
MOLEX INCORPORATED		
DOCUMENT NO.	SD-130017-005	SHEET NO.
		1 OF 1
THIS DRAWING CONTAINS INFORMATION THAT IS PROPRIETARY TO MOLEX INCORPORATED AND SHOULD NOT BE USED WITHOUT WRITTEN PERMISSION		

6

5

4

3

2

1