

5

4

3

2

1

1:1

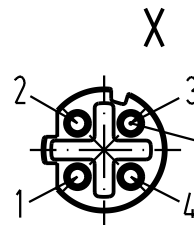
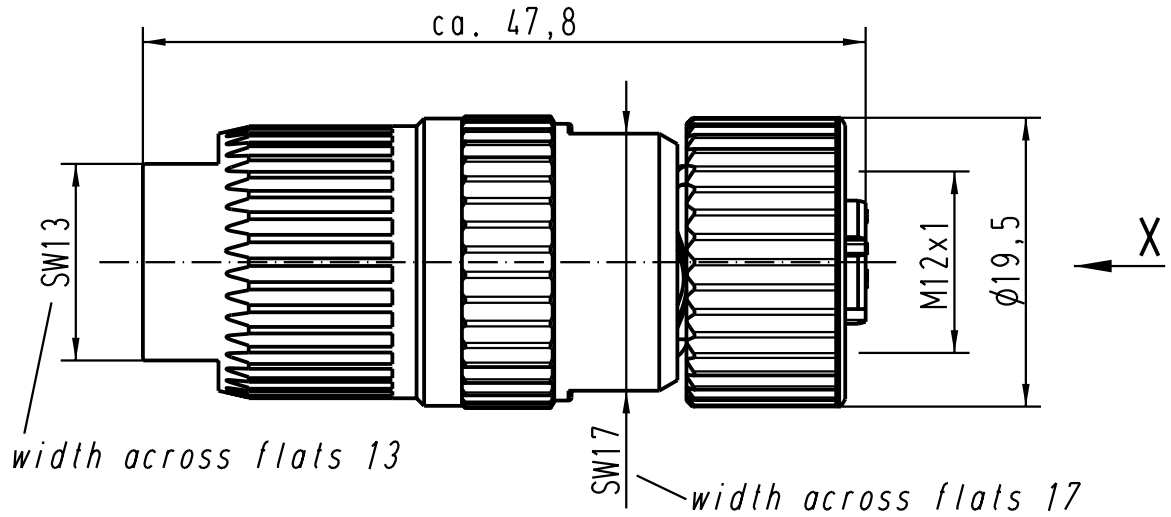
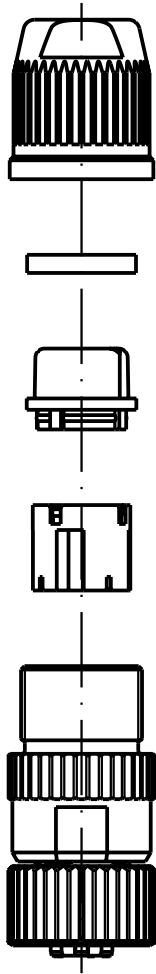

Steckgesicht n.  
Contact face acc.  
IEC 61076-2-101

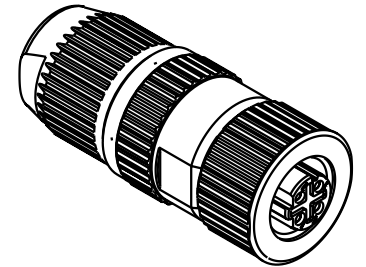

All Dimensions in mm Original Size DIN A 4			Techn. Character.			Nicht tolerierte Masse/ Free size tolerances		
				Dat.	Name	Massstab/Scale 2:1 1:1	Rundsteckverbinder M12-L/ Circular connector M12-L 4polig Buchse, D-kodiert 4poles female, D-coded	
			Detail.	21.05.03	Grie			
			Insp.		SR			
411132	08.07.04	Ste	Stand.				TB 21 03 281 2405	
410925	10.03.04	DY						
410521								
Mod.	Dat.	Name	HARTING Electric GmbH & Co. KG D-32339 Espelkamp					Blatt/ page /
							Sub.	

D

C

B

A