

# 2N5883, 2N5884 (PNP) 2N5885, 2N5886 (NPN)

2N5884 and 2N5886 are Preferred Devices

## Complementary Silicon High-Power Transistors

Complementary silicon high-power transistors are designed for general-purpose power amplifier and switching applications.

### Features

- Low Collector–Emitter Saturation Voltage –  
 $V_{CE(sat)} = 1.0 \text{ Vdc}$ , (max) at  $I_C = 15 \text{ Adc}$
- Low Leakage Current  
 $I_{CEX} = 1.0 \text{ mAdc}$  (max) at Rated Voltage
- Excellent DC Current Gain –  
 $h_{FE} = 20$  (min) at  $I_C = 10 \text{ Adc}$
- High Current Gain Bandwidth Product –  
 $f_T = 4.0 \text{ MHz}$  (min) at  $I_C = 1.0 \text{ Adc}$
- Pb–Free Packages are Available\*

### MAXIMUM RATINGS (Note 1)

Rating	Symbol	Value	Unit
Collector–Emitter Voltage 2N5883, 2N5885 2N5884, 2N5886	$V_{CEO}$	60 80	Vdc
Collector–Base Voltage 2N5883, 2N5885 2N5884, 2N5886	$V_{CB}$	60 80	Vdc
Emitter–Base Voltage	$V_{EB}$	5.0	Vdc
Collector Current – Continuous Peak	$I_C$	25 50	Adc
Base Current	$I_B$	7.5	Adc
Total Device Dissipation @ $T_C = 25^\circ\text{C}$ Derate above $25^\circ\text{C}$	$P_D$	200 1.15	W W/ $^\circ\text{C}$
Operating and Storage Junction Temperature Range	$T_J, T_{stg}$	–65 to +200	$^\circ\text{C}$

### THERMAL CHARACTERISTICS

Characteristic	Symbol	Max	Unit
Thermal Resistance, Junction–to–Case	$\theta_{JC}$	0.875	$^\circ\text{C}/\text{W}$

Stresses exceeding Maximum Ratings may damage the device. Maximum Ratings are stress ratings only. Functional operation above the Recommended Operating Conditions is not implied. Extended exposure to stresses above the Recommended Operating Conditions may affect device reliability.

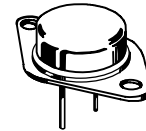
1. Indicates JEDEC registered data. Units and conditions differ on some parameters and re–registration reflecting these changes has been requested. All above values most or exceed present JEDEC registered data.

\*For additional information on our Pb–Free strategy and soldering details, please download the ON Semiconductor Soldering and Mounting Techniques Reference Manual, SOLDERRM/D.



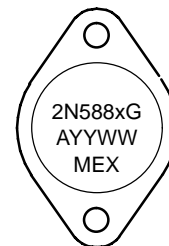
ON Semiconductor®

## 25 AMPERE COMPLEMENTARY SILICON POWER TRANSISTORS 60 – 80 VOLTS, 200 WATTS



TO-204AA (TO-3)  
CASE 1-07  
STYLE 1

### MARKING DIAGRAM



2N588x = Device Code  
x = 3, 4, 5, or 6  
G = Pb–Free Package  
A = Assembly Location  
YY = Year  
WW = Work Week  
MEX = Country of Origin

### ORDERING INFORMATION

See detailed ordering and shipping information in the package dimensions section on page 5 of this data sheet.

Preferred devices are recommended choices for future use and best overall value.

## 2N5883, 2N5884 (PNP) 2N5885, 2N5886 (NPN)

### ELECTRICAL CHARACTERISTICS (Note 2) ( $T_C = 25^\circ\text{C}$ unless otherwise noted)

Characteristic		Symbol	Min	Max	Unit
Collector-Emitter Sustaining Voltage (Note 3) ( $I_C = 200\text{ mA}$ , $I_B = 0$ )	2N5883, 2N5885 2N5884, 2N5886	$V_{CE(sus)}$	60 80	– –	Vdc
Collector Cutoff Current ( $V_{CE} = 30\text{ Vdc}$ , $I_B = 0$ ) ( $V_{CE} = 40\text{ Vdc}$ , $I_B = 0$ )	2N5883, 2N5885 2N5884, 2N5886	$I_{CEO}$	– –	2.0 2.0	mA
Collector Cutoff Current ( $V_{CE} = 60\text{ Vdc}$ , $V_{BE(off)} = 1.5\text{ Vdc}$ ) ( $V_{CE} = 80\text{ Vdc}$ , $V_{BE(off)} = 1.5\text{ Vdc}$ ) ( $V_{CE} = 60\text{ Vdc}$ , $V_{BE(off)} = 1.5\text{ Vdc}$ , $T_C = 150^\circ\text{C}$ ) ( $V_{CE} = 80\text{ Vdc}$ , $V_{BE(off)} = 1.5\text{ Vdc}$ , $T_C = 150^\circ\text{C}$ )	2N5883, 2N5885 2N5884, 2N5886 2N5883, 2N5885 2N5884, 2N5886	$I_{CEX}$	– – – –	1.0 1.0 10 10	mA
Collector Cutoff Current ( $V_{CB} = 60\text{ Vdc}$ , $I_E = 0$ ) ( $V_{CB} = 80\text{ Vdc}$ , $I_E = 0$ )	2N5883, 2N5885 2N5884, 2N5886	$I_{CBO}$	– –	1.0 1.0	mA
Emitter Cutoff Current ( $V_{EB} = 5.0\text{ Vdc}$ , $I_C = 0$ )		$I_{EBO}$	–	1.0	mA

### ON CHARACTERISTICS

DC Current Gain (Note 3) ( $I_C = 3.0\text{ A}$ , $V_{CE} = 4.0\text{ Vdc}$ ) ( $I_C = 10\text{ A}$ , $V_{CE} = 4.0\text{ Vdc}$ ) ( $I_C = 25\text{ A}$ , $V_{CE} = 4.0\text{ Vdc}$ )	$h_{FE}$	35 20 4.0	– 100	–
Collector-Emitter Saturation Voltage (Note 3) ( $I_C = 15\text{ A}$ , $I_B = 1.5\text{ A}$ ) ( $I_C = 25\text{ A}$ , $I_B = 6.25\text{ A}$ )	$V_{CE(sat)}$	– –	1.0 4.0	Vdc
Base-Emitter Saturation Voltage (Note 3) ( $I_C = 25\text{ A}$ , $I_B = 6.25\text{ A}$ )	$V_{BE(sat)}$	–	2.5	Vdc
Base-Emitter On Voltage (Note 3) ( $I_C = 10\text{ A}$ , $V_{CE} = 4.0\text{ Vdc}$ )	$V_{BE(on)}$	–	1.5	Vdc

### DYNAMIC CHARACTERISTICS

Current-Gain - Bandwidth Product (Note 4) ( $I_C = 1.0\text{ A}$ , $V_{CE} = 10\text{ Vdc}$ , $f_{test} = 1.0\text{ MHz}$ )	$f_T$	4.0	–	MHz
Output Capacitance ( $V_{CB} = 10\text{ Vdc}$ , $I_E = 0$ , $f = 1.0\text{ MHz}$ )	$C_{ob}$	– –	1000 500	pF
Small-Signal Current Gain ( $I_C = 3.0\text{ A}$ , $V_{CE} = 4.0\text{ Vdc}$ , $f_{test} = 1.0\text{ kHz}$ )	$h_{fe}$	20	–	–

### SWITCHING CHARACTERISTICS

Rise Time	$(V_{CC} = 30\text{ Vdc}, I_C = 10\text{ A}, I_{B1} = I_{B2} = 1.0\text{ A})$	$t_r$	–	0.7	$\mu\text{s}$
Storage Time		$t_s$	–	1.0	$\mu\text{s}$
Fall Time		$t_f$	–	0.8	$\mu\text{s}$

2. Indicates JEDEC Registered Data.

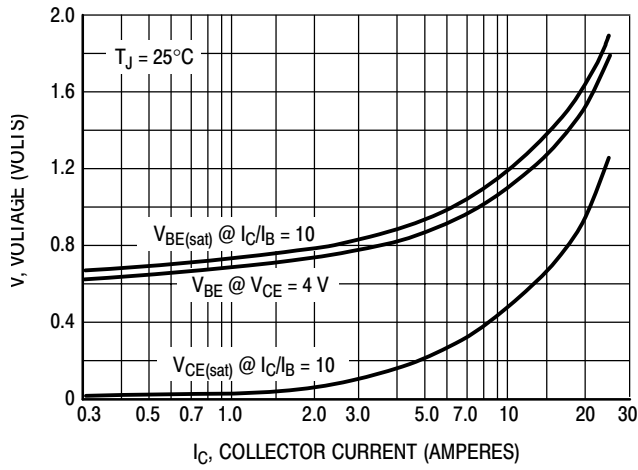
3. Pulse Test: Pulse Width  $\leq 300\ \mu\text{s}$ , Duty Cycle  $\leq 2.0\%$ .

4.  $f_T = |h_{fe}| \cdot f_{test}$ .

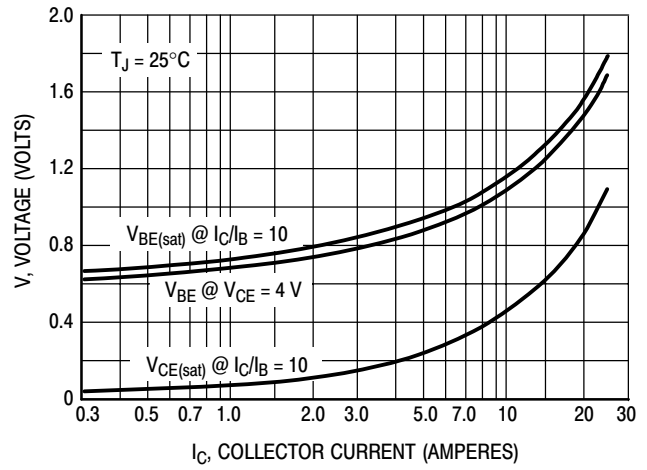


**Figure 1. Power Derating**

## 2N5883, 2N5884 (PNP) 2N5885, 2N5886 (NPN)



**Figure 12. "On" Voltages**



**Figure 13. "On" Voltages**

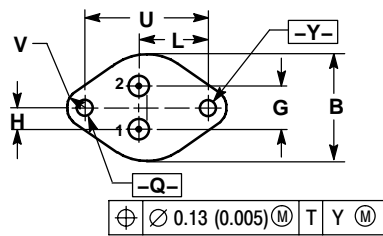
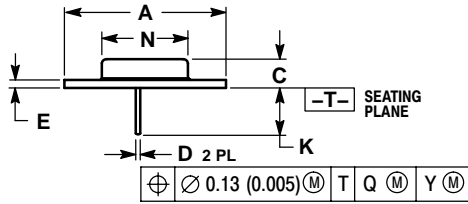
### ORDERING INFORMATION

Device	Package	Shipping
2N5883	TO-204	100 Units / Tray
2N5883G	TO-204 (Pb-Free)	
2N5884	TO-204	
2N5884G	TO-204 (Pb-Free)	
2N5885	TO-204	
2N5885G	TO-204 (Pb-Free)	
2N5886	TO-204	
2N5886G	TO-204 (Pb-Free)	

# 2N5883, 2N5884 (PNP) 2N5885, 2N5886 (NPN)

## PACKAGE DIMENSIONS

TO-204 (TO-3)  
CASE 1-07  
ISSUE Z



- NOTES:
1. DIMENSIONING AND TOLERANCING PER ANSI Y14.5M, 1982.
  2. CONTROLLING DIMENSION: INCH.
  3. ALL RULES AND NOTES ASSOCIATED WITH REFERENCED TO-204AA OUTLINE SHALL APPLY.

DIM	INCHES		MILLIMETERS	
	MIN	MAX	MIN	MAX
A	1.550 REF		39.37 REF	
B	---	1.050	---	26.67
C	0.250	0.335	6.35	8.51
D	0.038	0.043	0.97	1.09
E	0.055	0.070	1.40	1.77
G	0.430 BSC		10.92 BSC	
H	0.215 BSC		5.46 BSC	
K	0.440	0.480	11.18	12.19
L	0.665 BSC		16.89 BSC	
N	---	0.830	---	21.08
Q	0.151	0.165	3.84	4.19
U	1.187 BSC		30.15 BSC	
V	0.131	0.188	3.33	4.77

STYLE 1:  
PIN 1. BASE  
2. EMITTER  
CASE: COLLECTOR