

GENERAL SPECIFICATIONS FOR SB25, SB60s, SB200s

Electrical Capacity (Resistive & Inductive Load)

Power Level: Shown in the following tables

Other Ratings

Contact Resistance:	10 milliohms maximum
Insulation Resistance:	200 megohms minimum @ 500V DC for SB220s, SB265s, SB285; 1,000 megohms minimum @ 500V DC for SB60s; 100 megohms minimum @ 500V DC for SB25s
Dielectric Strength:	1,500V AC minimum for SB265s, SB285, & SB25s 2,000V AC minimum between contacts; 1,500V AC minimum between contacts & case for SB220s & SB60s
Mechanical Life:	50,000 operations minimum for SB220s; 30,000 operations minimum for SB25s, SB60s, SB265s, SB285
Electrical Life:	10,000 operations minimum
Total Travel:	SB220s 2.95mm (.116"); SB60s 2.4mm (.094"); SB265 5.4mm (.213"); SB285 & SB25s 4.95mm (.195")
Operating Temp Range:	-10°C through +70°C (+14°F through +158°F)









Materials & Finishes

Cap:	Polybutylene terephthalate (AT414)
Plunger:	Polyacetal or brass with nickel plating
Bushing:	Brass with nickel plating
Case:	Phenolic resin or melamine phenolic resin
Case Cover:	Steel with zinc plating
Movable & Stationary Contacts:	Copper with silver plating for SB220s; silver alloy with silver plating for SB25s, SB60s, & SB200s
Terminals:	Brass or copper with silver plating

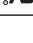

Standards & Certifications

UL Recognized:	Designated with UL recognized symbol beside part numbers on following pages See Supplement Index (page Z1 to find UL rating details. UL File No. E44145) Add "/U" to end of part number to order UL mark on switch.
CSA Certified:	Designated with CSA certified symbol beside part numbers on following pages See Supplement Index (page Z1 to find UL rating details. CSA File No. LR23535)

SINGLE POLE WITH SOLDER LUG OR SCREW LUG

Model	Approvals	Pole & Throw	Pushbutton Position/Connected Terminals () = Momentary		Electrical Capacity (Resistive)	
			Normal 	Down 	AC 125V	AC 250V
SB221NO	— 	SPST	OFF —	(ON) 1-4	3A	1.5A
SB221NC	 	SPST	ON 1-4	(OFF) —	3A	1.5A
SB221TNO*	— 	SPST	OFF —	(ON) 1-4	3A	1.5A
SB221TNC*	 	SPST	ON 1-4	(OFF) —	3A	1.5A

* Suffix T = Screw Lug

Throw & Schematic: SPST  SB221NO SPST  SB221NC

Note: Terminal numbers are on the switch.

- Standard Hardware: AT504 Knurled Nut, AT508 Lockwasher, AT527 Hex Backup Nut. See Accessories & Hardware Index (page Y1) for details.
- Solder lug terminal hole accommodates one 12-gauge solid or stranded wire.



SB221NO
Supplied w/AT414 Black Cap

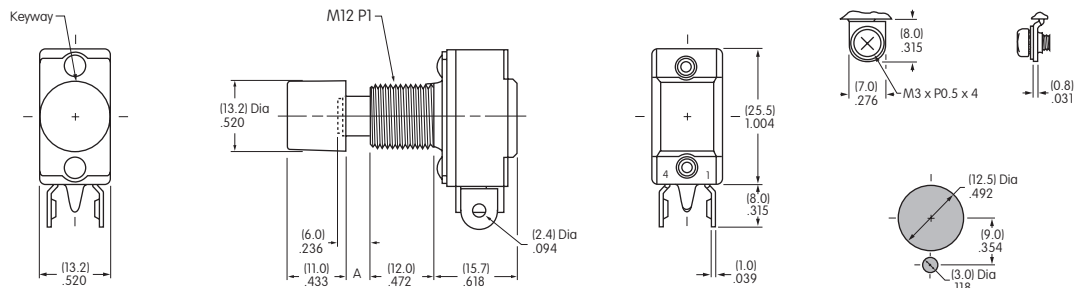

Dimension A: 4.7mm (.185") for NO model & 3.8mm (.150") for NC model.

Panel Thickness:
4.9mm (.193")

DOUBLE POLE WITH SOLDER LUG

			Pushbutton Position/Connected Terminals () = Momentary				Electrical Capacity	
Model	Approvals	Pole & Throw	Normal		Down		Resistive	
			Keyway		Keyway		AC 125V	AC 250V
SB61A	UL —	DPDT	ON	2-3 5-6	(ON)	2-1 5-4	10A	5A
SB61B	— —	DPDT	ON	2-3 5-6	(ON)	2-1 5-4	3A	1.5A
SB63A*	— —	DPDT	ON	2-3 5-6	(ON) or Lockdown ON	2-1 5-4	10A	5A

* Lockdown for SB63A is achieved by actuating & then turning the button clockwise.

Throw & Schematic: DPDT

Notes: Terminal numbers are on the switch.

- Standard Hardware: AT504 Knurled Nut, AT508 Lockwasher, AT527 Hex Backup Nut. See Accessories & Hardware Index (page Y1) for details.
- Solder lug terminal hole accommodates one 12-gauge solid or stranded wire.

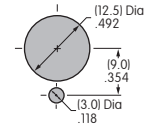
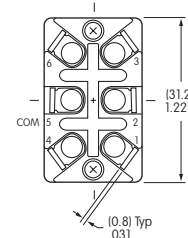
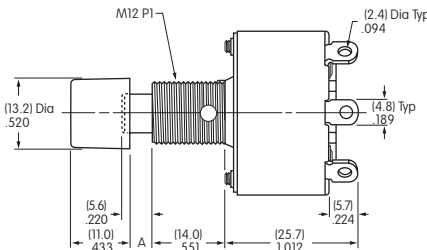
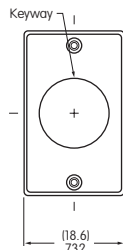
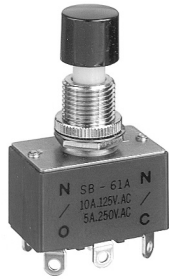

Panel Thickness:
4.9mm (.193")

SB61A

Supplied w/AT414 Black Cap

Dimension A: 4.3mm (.169") for SB61 model & 3.3mm (.130") for SB63 model.

DOUBLE POLE WITH SOLDER LUG

			Pushbutton Position/Connected Terminals () = Momentary				Electrical Capacity	
Model	Approvals	Pole & Throw	Normal		Down		Resistive	
			Keyway		Keyway		AC 125V	AC 250V
SB25	UL Ⓢ	DPDT	ON	2-3 5-6	ON	2-1 5-4	15A	9A
SB25B	— —	DPDT	ON	2-3 5-6	ON	2-1 5-4	5A	3A

Throw & Schematic: DPDT

Note: Terminal numbers are on the switch.

- Standard Hardware: AT504 Knurled Nut, AT508 Lockwasher, AT527 Hex Backup Nut. See Accessories & Hardware Index (page Y1) for details.
- Solder lug terminal hole accommodates one 12-gauge solid or stranded wire.

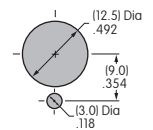
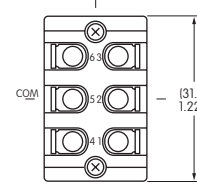
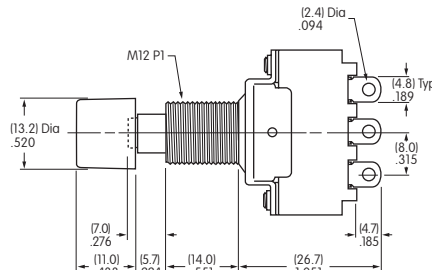
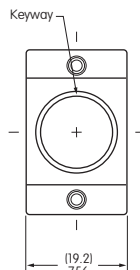

Panel Thickness:
4.9mm (.193")

SB25

Supplied w/AT414 Black Cap

SINGLE POLE WITH SOLDER LUG

			Pushbutton Position/Connected Terminals () = Momentary		Electrical Capacity	
Model	Approvals	Pole & Throw	Normal	Down	Resistive	
					AC 125V	AC 250V
SB265		SPST	ON 1-4	OFF -	6A	3A
Throw & Schematic: SPST					Note: Terminal numbers are on the switch.	

- Standard Hardware: AT504 Knurled Nut, AT508 Lockwasher, AT527 Hex Backup Nut. See Accessories & Hardware Index (page Y1) for details.
- Solder lug terminal hole accommodates one 12-gauge solid or stranded wire.



SB265
Supplied with Chrome Plated Brass Cap

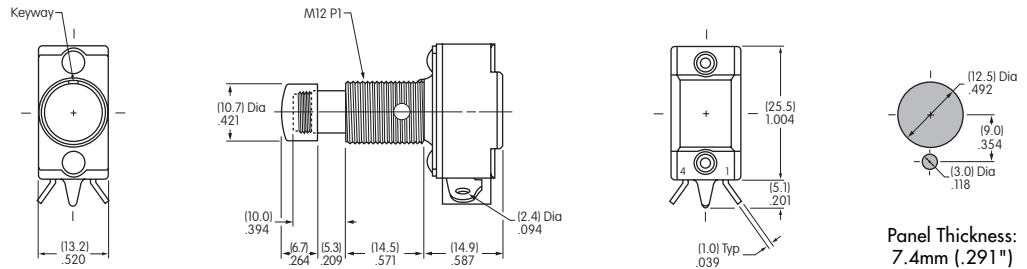

DOUBLE POLE WITH SOLDER LUG

			Pushbutton Position/Connected Terminals () = Momentary		Electrical Capacity	
Model	Approvals	Pole & Throw	Normal	Down	Resistive	
					AC 125V	AC 250V
SB285		DPDT	ON 2-3 5-6	ON 2-1 5-4	6A	3A
Throw & Schematic: DPDT					Note: Terminal numbers are on the switch.	

- Standard Hardware: AT504 Knurled Nut, AT508 Lockwasher, AT527 Hex Backup Nut. See Accessories & Hardware Index (page Y1) for details.
- Solder lug terminal hole accommodates one 12-gauge solid or stranded wire.



SB285
Supplied with Chrome Plated Brass Cap

