

**SERIES 47B**  
**Sealed Miniature Rocker and Paddle Switches**

**FEATURES**

- Save Space and Weight
- SPDT, DPDT and 3PDT Circuitry
- Choice of Actuators and Terminations
- Sealed per IP-67



**MODELS** In inches (and millimeters)

MODEL NO.	SWITCH POSITION		
WSP1	ON	NONE	ON
WSP2	ON	NONE	(ON)
WSP3	ON	OFF	ON
WSP4	(ON)	OFF	(ON)
WSP5	ON	OFF	(ON)
TERM. COMM.	2-3	OPEN	2-1

( )=MOMENTARY

02COMM.

SCHEMATIC



**SPDT**

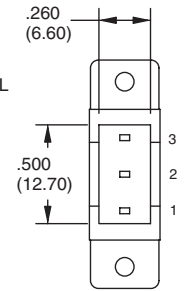
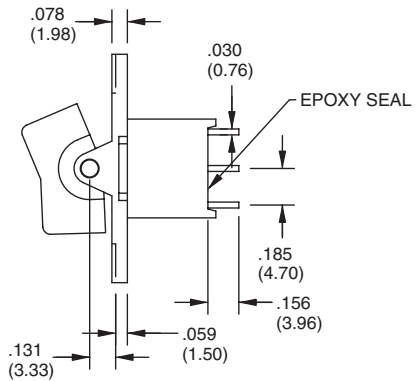
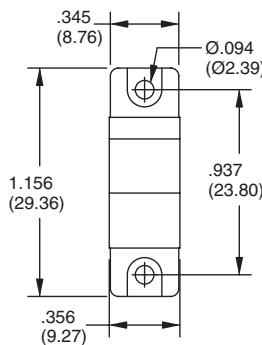

MODEL NO.	SWITCH POSITION		
WDP1	ON	NONE	ON
WDP2	ON	NONE	(ON)
WDP3	ON	OFF	ON
WDP4	(ON)	OFF	(ON)
WDP5	ON	OFF	(ON)
TERM. COMM.	2-3,5-6	OPEN	2-1,5-4

( )=MOMENTARY

02COMM. 05COMM.

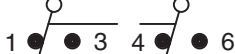

SCHEMATIC

**DPDT**

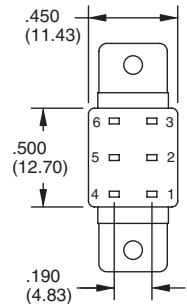
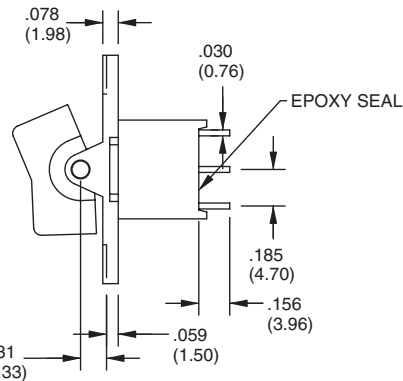
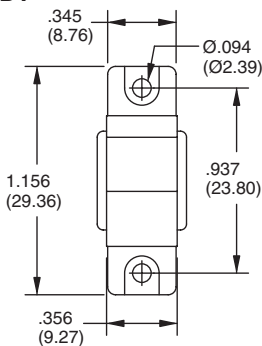

MODEL NO.	SWITCH POSITION		
W3P1	ON	NONE	ON
W3P2	ON	NONE	(ON)
W3P3	ON	OFF	ON
W3P4	(ON)	OFF	(ON)
W3P5	ON	OFF	(ON)
TERM. COMM.	2-3,5-6	OPEN	2-1,5-4

( )=MOMENTARY

02COMM. 05COMM. 08COMM.



SCHEMATIC

**3PDT**

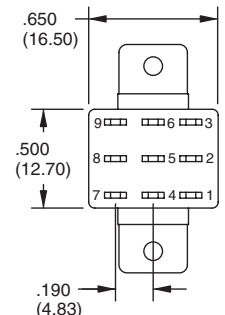
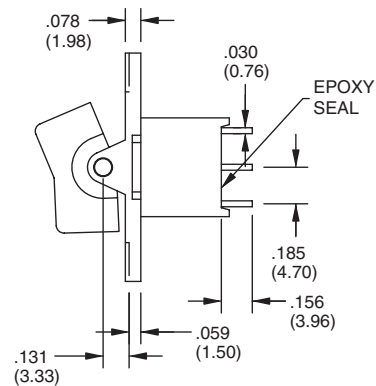
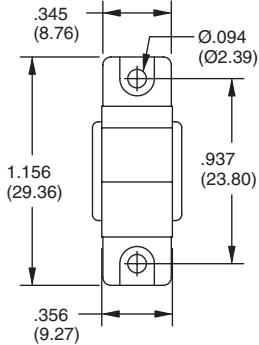

Rocker and Paddle Switches

**ACTUATOR OPTIONS** In inches (and millimeters)

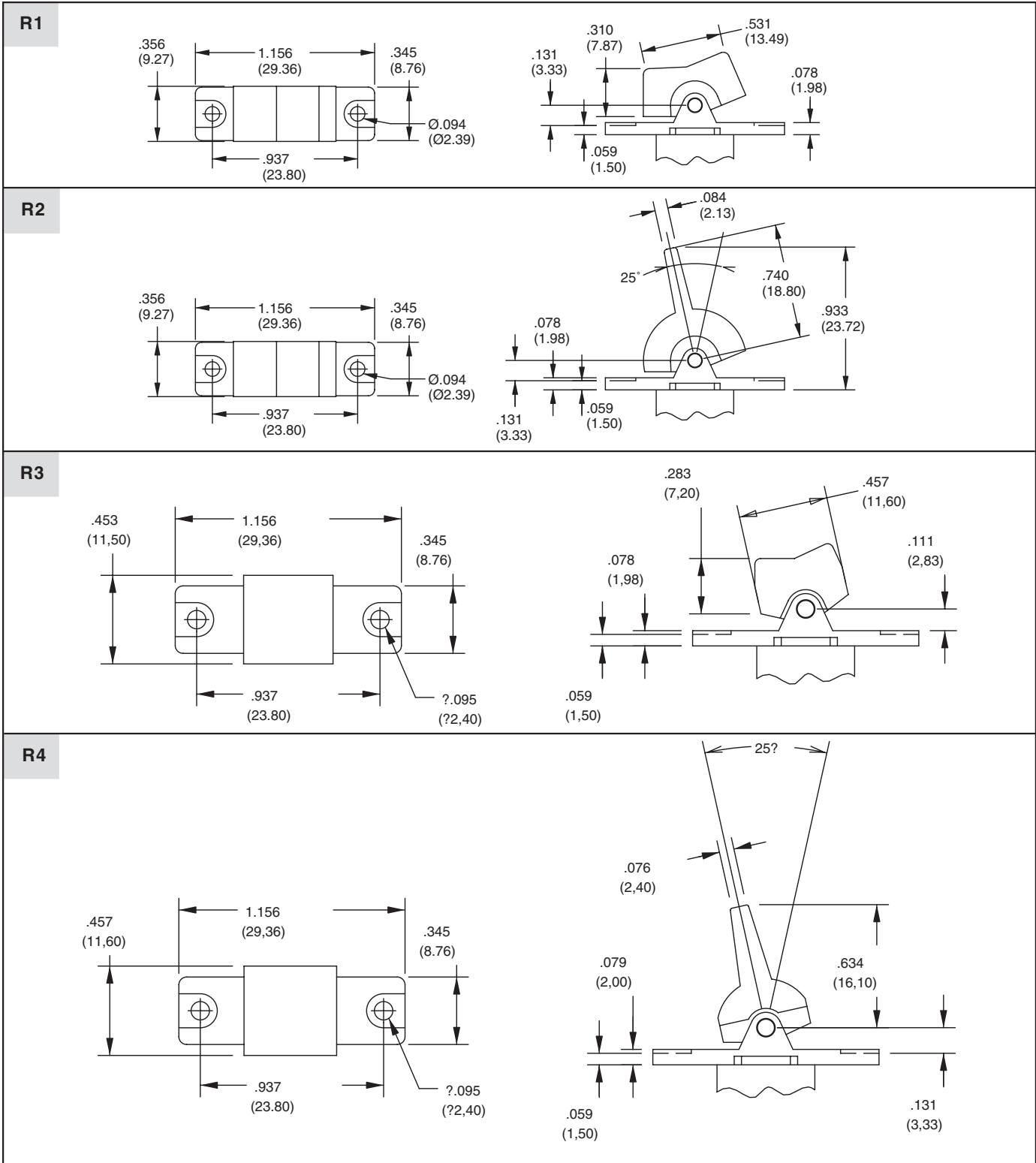

Rocker and Paddle Switches

**ACTUATOR OPTIONS** In inches (and millimeters)

<p><b>J1</b></p>		
<p><b>J2</b></p>		
<p><b>J3</b></p>		
<p><b>J4</b></p>		
<p><b>J5</b></p>		

Rocker and Paddle Switches

TERMINATION OPTIONS In inches (and millimeters)

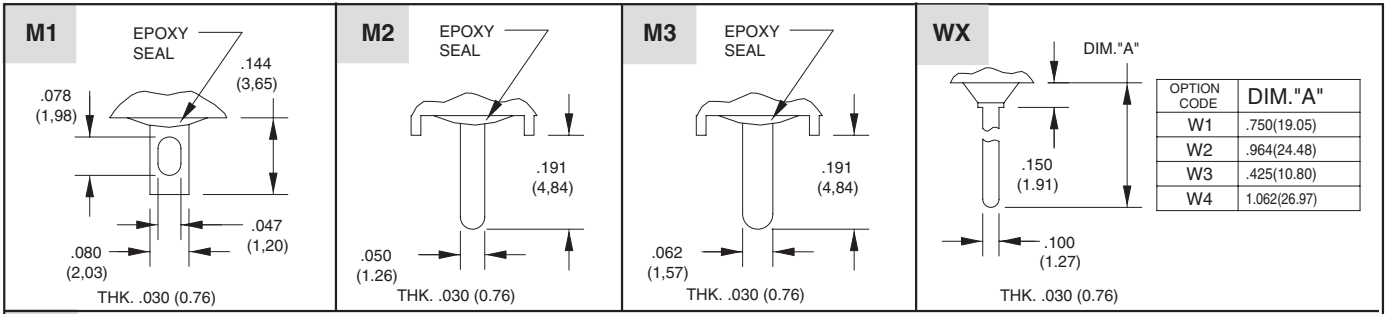

M6 Right Angle P.C. Mount, Horizontal Actuation

SPDT

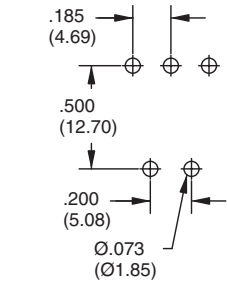
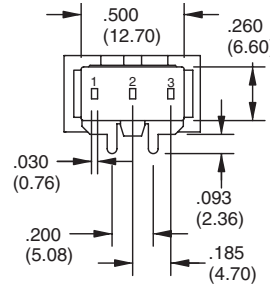
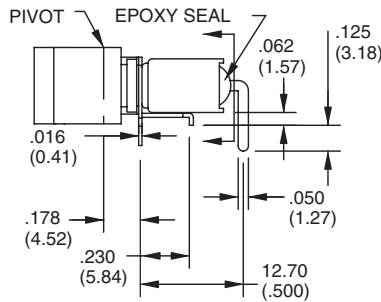
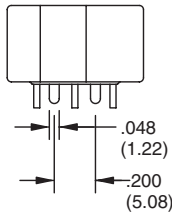

DPDT

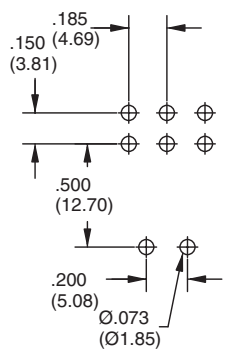
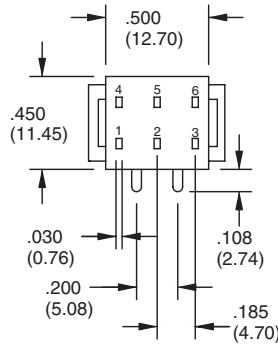
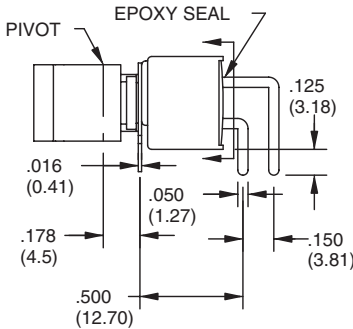
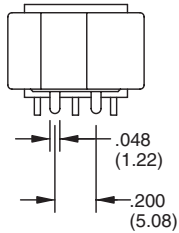

3PDT

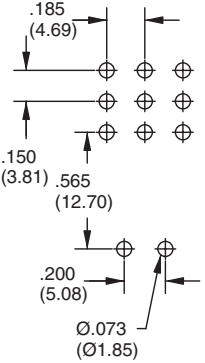
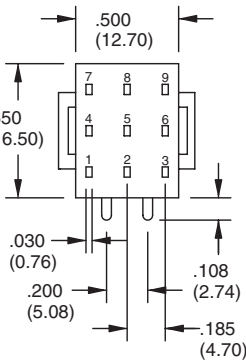
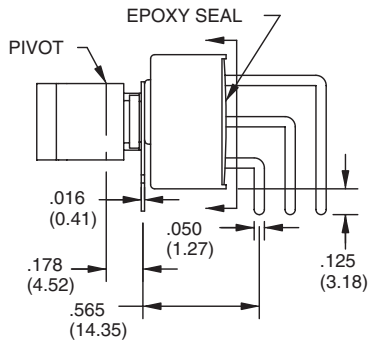
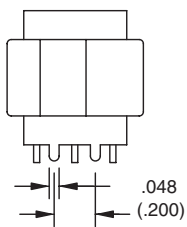

M7 Right Angle P.C. Mount, Vertical Actuation

SPDT

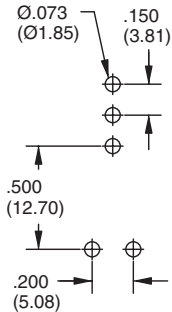
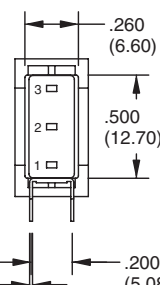
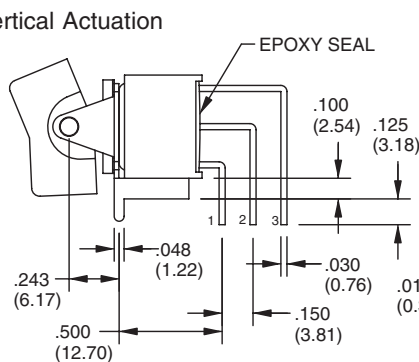
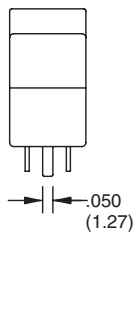

**TERMINATION OPTIONS** In inches (and millimeters)

**DPDT**

**3PDT**

**V2-V3 Vertical Bracket P.C. Mount**

**SPDT**

OPTION CODE	DIM."A"
V2	.460 (11.68)
V3	.630 (16.00)

**DPDT**

OPTION CODE	DIM."A"
V2	.460 (11.68)
V3	.630 (16.00)

**3PDT**

OPTION CODE	DIM."A"
V2	.460 (11.68)
V3	.630 (16.00)

Rocker and Paddle Switches

**SPECIFICATIONS**

**RATINGS**

**Contact Rating:** Q option - 5A with resistive load @ 125 VAC or 28 VDC; 2A with resistive load @ 250 VAC. R option - 0.4 VA max @ 20 Vmax (AC or DC)

**Electrical Life:** 50,000 make-and-break cycles at full load

**Contact Resistance:** Below 10 milliohms max. initial @ 2-4 VDC, 100 mA

**Insulation Resistance:** 1,000 megaohms minimum

**Dielectric Strength:** 1,500 V RMS @ sea level

**Operating Temperature:** -30°C to 85°C

**MATERIALS**

**Case and Bushing:** Glass-filled nylon 6/6 , flame retardant, heat stabilized (UL94V-0)

**Actuator:** Nylon, black standard. Internal O-ring seal standard with all actuators.

**Frame:** Spring steel, black (standard)

**Switch Support:** Brass, tin-plated

**Actuator Pivot & Mounting Bracket:**

Nylon (UL 94V-0)

**Actuator Pivot Retainer:** Stainless Steel

**Terminal Seal:** Epoxy

**Terminal/Contacts:** Copper alloy with gold plate over nickel or silver plate

**ORDERING INFORMATION**

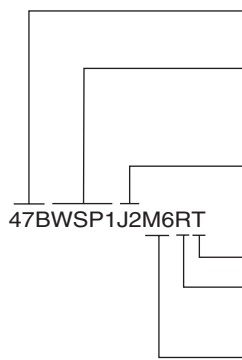

Series Sealed Miniature Rocker and Paddle Switches

Model: SPDT: WSP1, WSP2, WSP3, WSP4, WSP5  
 DPDT: WDP1, WDP2, WDP3, WDP4, WDP5  
 3PDT: W3P1, W3P2, W3P3, W3P4, W3P5  
 (See Model options.)

Actuator: R1, R2, R3, R4, J1, J2, J3, J4, J5  
 (See Actuator options)

RoHS Compliant

Contact: R = Copper alloy, gold plate over nickel plate,  
 Q = Copper alloy, gold plate over silver plate

Termination Options: M1, M2, M6, M7, V2, V3, W1, W2, W3, W4  
 (See Termination options)

Available from your local Grayhill Component Distributor. For prices and discounts, contact a local Sales Office, an authorized local Distributor or Grayhill.