

61116-1 Product Details

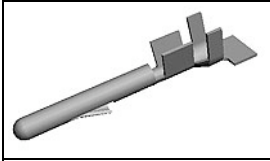

61116-1

TE Internal Number: 61116-1

 [Active](#)

 [View 3D PDF](#)

.200" Centerline, 250 V, 13 A max.

 [Always EU RoHS/ELV Compliant \(Statement of Compliance\)](#)

Product Highlights:

- Commercial MATE-N-LOK Product Line
- Contact
- Contact Type = Pin
- Crimp Termination Method to Wire/Cable
- Pre-Tin Contact Plating, Mating Area, Material

[View all Features](#)

Documentation & Additional Information

Product Drawings:

- [PIN, MATE-N-LOK](#) (PDF, English)

Catalog Pages/Data Sheets:

- [REPRESENTATIVE TERMINALS AND CONNECTORS](#) (PDF, English)
- [SOFT SHELL PIN SOCKET CONNECTORS STANDARD DENSITY](#) (PDF, English)

Product Specifications:

- [Connector, MATE-N-LOK, Commercial](#) (PDF, English)
- [Connector, IDC Commercial MATE-N-LOK*](#) (PDF, English)
- [Connector, MATE-N-LOK, Commercial](#) (PDF, Japanese)

Application Specifications:

- [MATE-N-LOK Commercial Pin And Socket Contacts](#) (PDF, English)
- [MATE-N-LOK Commercial Pin and Socket Contacts](#) (PDF, Japanese)

Instruction Sheets:

- None Available

CAD Files: ([CAD Format & Compression Information](#))

- [2D Drawing](#) (DXF, Version AG)
- [3D Model](#) (IGES, Version AG)
- [3D Model](#) (STEP, Version AG)

[List all Documents](#)

Additional Information:

- [Product Line Information](#)

Related Products:

- [Tooling](#)
- [Housings \(70\)](#)

Product Features (Please use the Product Drawing for all design activity)

Product Type Features:

- Product Line = Commercial MATE-N-LOK
- Product Type = Contact
- Termination Method to Wire/Cable = Crimp
- Wire/Cable Type = Discrete Wire
- Industry Application = Standard, TMWIRE2BOARD, TMPPOWERP, TESTANDMEASURE

Electrical Characteristics:

- Contact Current Rating (A) = 13
- Operating Voltage Reference = AC
- Operating Voltage (VAC) = 250

Body Related Features:

- Wire Range (mm [AWG]) = 0.20-0.80² [24-18]
- Contact Diameter (mm [in]) = 2.13 [0.084]

Contact Related Features:

- Contact Type = Pin
- Contact Plating, Mating Area, Material = Pre-Tin
- Contact Base Material = Brass

Industry Standards:

- [RoHS/ELV Compliance](#) = RoHS compliant, ELV compliant
- [Lead Free Solder Processes](#) = Not relevant for lead free process
- RoHS/ELV Compliance History = Always was RoHS compliant

Conditions for Usage:

- Accepts Wire Insulation Diameter, Range (mm [in]) = 1.52 – 2.54 [0.060 – 0.100]
- Applies To = Wire

Packaging Related Features:

- Packaging Method = Strip

Other:

- Brand = AMP
- Comment = HDM Applicator part number ending in -1 is used on AMPOMATOR CLS Machine with T or G terminators, -2 used on AMP-O-LECTRIC Model K Machine; -3,-4, or -6 is used on AMP-O-LECTRIC Model G Machine.; Extraction Tools: Pins- No. 1-305183-1(IS 408-7158); Sockets- No. 1-305183-2(IS 408-7158); Pins and Sockets- No. 465644-1(IS 408-7211)