

I/O Connectors Datasheet

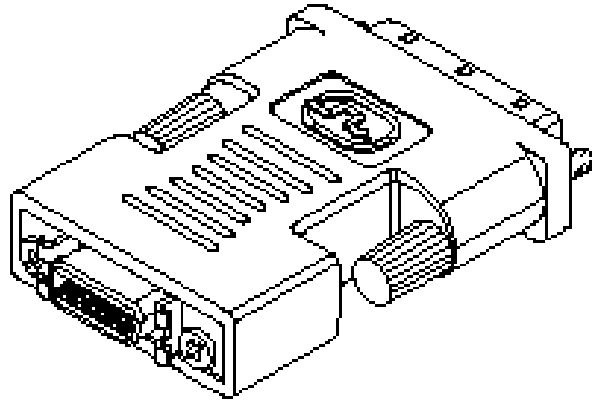

Series image - Reference only

EU RoHS

China RoHS

ELV and RoHS Compliant

Search Parts in this Series

88744 Series

Mates With

74320 receptacles

Part Number: **0887418800**



Status: **Active**

Description: MicroCross™ DVI Digital Visual Interface, Shielded I/O Adapter, DVI-Digital Plug to DFP Receptacle

Documents:

- [Drawing \(PDF\)](#)
- [Related Catalog Page \(PDF\)](#)

Order Products:

-  [Check Distributor Inventory](#)
-  [Request Samples](#)

Part Detail: [\(show all\)](#)

- General**
- Physical**
- Electrical**
- Material Info**
- Reference - Drawing Numbers**

General

Product Family	I/O Connectors
Series	88744
Application	Wire-to-Board
Comments	DVI-Digital Plug to DFP Receptacle
Component Type	Adapter
Product Name	MicroCross™DVI
Type	N/A

Physical

Circuits (Loaded)	24
Circuits (maximum)	24
Color - Resin	Black
Durability (mating cycles) min	100 cycles
Lock to Mating Part	Yes
Material - Metal	Phosphor Bronze
Material - Plating Mating	Gold
Material - Plating Termination	Tin
Material - Resin	Polyester
Number of Rows	3
Orientation	Vertical
PCB Retention	Yes
Packaging Type	Bag
Panel Mount	No
Pitch - Mating Interface (in)	0.075 In
Pitch - Mating Interface (mm)	1.90 mm
Plating min: Mating (uin)	10
Plating min: Mating (um)	0.25
Plating min: Termination (uin)	150
Plating min: Termination (um)	3.80
Polarized to Mating Part	Yes
Surface Mount Compatible (SMC)	N/A
Temperature Range - Operating	-20°C to +85°C
Termination Interface: Style	N/A
Wire Size AWG	N/A

Electrical

Current - Maximum	3.000 Amp
Shielded	Yes
Voltage - Maximum	40V

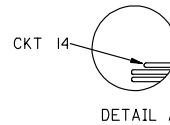
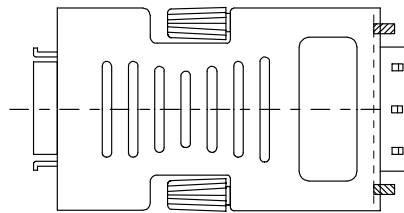
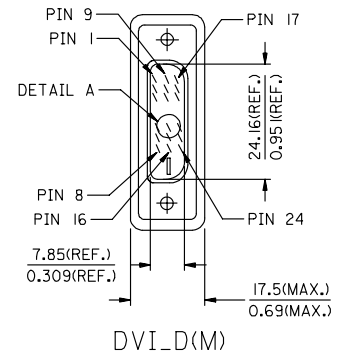
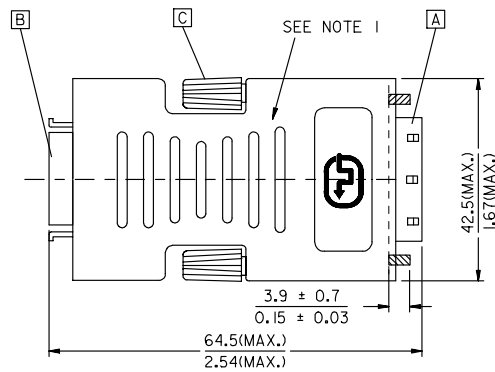
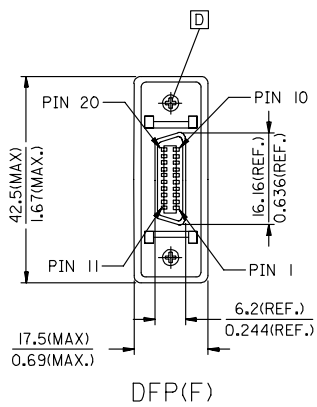

BACK SIDE

ENTER DESCRIPTION EC NO: DG2006-0186 DRW: PDA1 CHKD: CHYD APPR: KAN 2006/03/09 2006/03/09 2006/03/10	QUALITY SYMBOLS ▽=0 ▽=0	GENERAL TOLERANCES (UNLESS SPECIFIED)		DIMENSION STYLE	SCALE	DESIGN UNITS	THIRD ANGLE PROJECTION	
				MM/IN	---	METRIC		
		4 PLACES	±---	±---	DRAWN BY	DATE	TITLE	
		3 PLACES	±---	±---	PDA1	2006/03/07	DVI_D(M)-DFP(F) ADAPTER	
2 PLACES	±---	±---	CHECKED BY	DATE	MOLEX INCORPORATED			
1 PLACE	±---	±---	ZXDENG	2006/03/07				
ANGULAR ±---°		APPROVED BY		DATE	MATERIAL NO. 88741-8800 DOCUMENT NO. SD-88741-009 SHEET NO. 1 OF 2			
DRAFT WHERE APPLICABLE MUST REMAIN WITHIN DIMENSIONS		BORON		2006/03/07				
SIZE A4		THIS DRAWING CONTAINS INFORMATION THAT IS PROPRIETARY TO MOLEX INCORPORATED AND SHOULD NOT BE USED WITHOUT WRITTEN PERMISSION						

ib_frame_A4_P_ME_T
Rev. D 2004/04/02

7 6 5 4 3 2 1

- NOTE: 1. MOLD WITH SNOW WHITE PVC RESIN 887800077 FOR ADAPTOR COVER.
 2. DVI CONNNECTOR SPECIFICATION
 2.1 REFER TO PRODUCT SPEC. PS74320-0001.
 2.2 CONTACT PLATING: AU FLASH.
 3. ELECTRICAL PERFORMANCE
 3.1 INSULATION RESISANCE: 20M Ohms Min
 3.2 DIELECTRIC STRENGTH: 300V DC FOR 10 MILLISECONDS.
 4. ADAPTOR SPECIFICATION
 4.1 REFER TO PRODUCT SPEC. PS88741-8800.
 5. THIS PRODUCT MUST MEET MX RoHS COMPLIANCE.

7. MATERIAL LIST

D	DFP CONNECTOR FEMALE SCREW 887806063
C	SCREW (FOR COVER) 887806003
B	DFP FEMALE CONNECTOR 887899292
A	DVI_D SINGLE CHANNEL G/F CONNECTOR 743230001
ITEM	DESCRIPTION

6. CONNECTION DIAGRAM

SHIELD	SHIELD	GROUND
PIN 6	PIN 24	TMDS CLOCK-
PIN 5	PIN 23	TMDS CLOCK+
PIN 4	PIN 22	TMDS CLOCK SHIELD
PIN 14	PIN 19	TMDS DATA 0 SHIELD
PIN 15	PIN 18	TMDS DATA 0+
PIN 16	PIN 17	TMDS DATA 0-
PIN 18	PIN 16	HOT PLUG DETECT
PIN 7	PIN 15	GROUND(+5V & HV SYNC.)
PIN 8	PIN 14	POWER +5V
PIN 3	PIN 11	TMDS DATA 1 SHIELD
PIN 1	PIN 10	TMDS DATA 1+
PIN 2	PIN 9	TMDS DATA 1-
PIN 19	PIN 7	DDC DATA
PIN 20	PIN 6	DDC CLOCK
PIN 13	PIN 3	TMDS DATA 2 SHIELD
PIN 11	PIN 2	TMDS DATA 2+
PIN 12	PIN 1	TMDS DATA 2-
DFP(F)	DVI_D	CABLE FUNCTION

ENTER DESCRIPTION EC NO: DG2006-0186 DRW: PDAI CHKD: CHYD APPR: KAN 2006/03/09 2006/03/09 2006/03/10	DESCRIPTION D	REV	QUALITY SYMBOLS ▽=0 ▽=0	GENERAL TOLERANCES (UNLESS SPECIFIED)		DIMENSION STYLE MM/IN		SCALE ---	DESIGN UNITS METRIC	THIRD ANGLE PROJECTION	
						DRAWN BY PDAI	DATE 2006/03/07	TITLE DVI_D(M)-DFP(F) ADAPTER			
						CHECKED BY ZXDENG	DATE 2006/03/07	MATERIAL NO. BORON			
						APPROVED BY BORON	DATE 2006/03/07	DOCUMENT NO. SD-88741-009			
DRAFT WHERE APPLICABLE MUST REMAIN WITHIN DIMENSIONS				MATERIAL NO. 88741-8800		DOCUMENT NO. SD-88741-009		SHEET NO. 2 OF 2			
SIZE A4 THIS DRAWING CONTAINS INFORMATION THAT IS PROPRIETARY TO MOLEX INCORPORATED AND SHOULD NOT BE USED WITHOUT WRITTEN PERMISSION											

ib_frame_A4_P_ME_T
Rev. D 2004/04/02

6 5 4 3 2 1