

4

3

2

1

THIS DRAWING IS UNPUBLISHED. RELEASED FOR PUBLICATION. ALL RIGHTS RESERVED.

LOC		DIST		REVISIONS			
FT	AK2	REVISED PER	ECO-11-004587	DATE	BY	APP'D	
				11MAR11	RK	HMR	

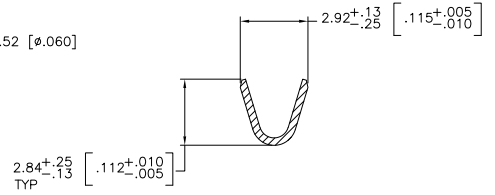
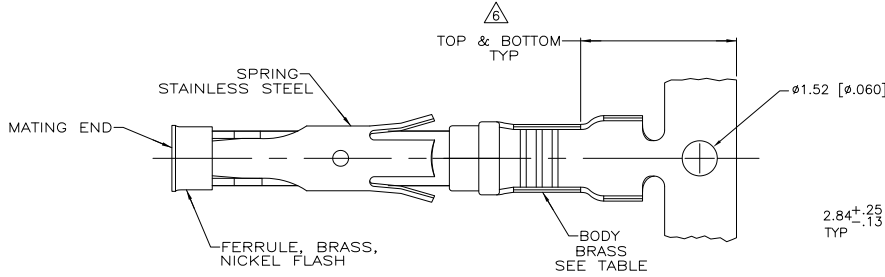

SECTION B-B

1.689±0.051 DIA [0.0665±0.0020]

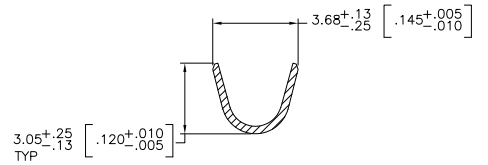
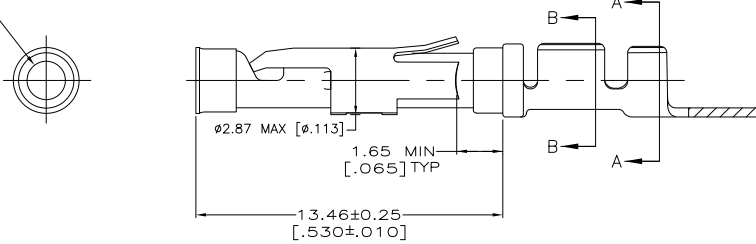

SECTION A-A

- ▲ 0.76µm [0.00030] MIN GOLD PER MIL-G-45204 ON MATING END FOR A LENGTH OF 5.08 [200] MIN WITH GOLD FLASH ON THE REMAINDER OVER 0.76µm [0.00030] MIN NICKEL PER QQ-N-290.
- ▲ 1.27µm [0.00050] MIN TIN-LEAD PER MIL-T-10727 OVER 0.76µm [0.00030] MIN NICKEL PER QQ-N-290.
- ▲ 0.76µm [0.00030] MIN GOLD PER MIL-G-45204 ON MATING END FOR A LENGTH OF 5.08 [200] MIN WITH A UNIFORM GRADIENT TO 0.25µm [0.00010] MIN GOLD PER MIL-G-45204 ON THE REMAINDER OVER 0.76µm [0.00030] MIN NICKEL PER QQ-N-290.
- ▲ 0.38µm [0.00015] MIN GOLD PER MIL-G-45204 ON MATING END FOR A LENGTH OF 5.08 [200] MIN WITH GOLD FLASH ON THE REMAINDER OVER 0.76µm [0.00030] MIN NICKEL PER QQ-N-290.
- ▲ 1.27µm [0.00050] MIN GOLD PER MIL-G-45204 ON MATING END FOR A LENGTH OF 5.08 [200] MIN WITH GOLD FLASH ON REMAINDER OVER 1.90µm [0.00075] MIN NICKEL PER QQ-N-290.
- ▲ GOLD PLATING NEED NOT APPEAR IN THIS AREA EXCEPT 1-66100-3 HAS GOLD PLATING ON INSULATION BARREL.
- ▲ REVERSE RELEED FOR MINI-APPLICATOR.
- ▲ WIRE RANGE 18-16 AWG.
- ▲ INSULATION RANGE 2.03[.080]-2.54[.100].
- ▲ 0.38µm [0.00015] MIN GOLD PER MIL-G-45204 ON MATING END FOR A LENGTH OF 5.08 [200] MIN, 1.27µm [0.00050] MIN TIN-LEAD PER MIL-T-10727 FOR A LENGTH OF 5.69 [224] MIN ON OPPOSITE END, BOTH OVER 1.27µm [0.00050] MIN NICKEL PER QQ-N-290 ON ENTIRE CONTACT.
- ▲ 1.27µm [0.00050] MIN TIN PER MIL-T-10727 OVER 0.76µm [0.00030] MIN NICKEL PER QQ-N-290.

STANDARD	REELING	SOCKET ASSEMBLY, .062, TYPE III+	LOOSE PIECE REF	PART NO.
▲	▲	1-66101-9	66100-9	1-66100-9
▲	▲	1-66101-4	66100-7	1-66100-7
OBSELETE	▲	-	66100-3	1-66100-3
OBSELETE	▲	66101-4	66100-9	66100-9
▲	▲	66101-3	66100-8	66100-8
▲	▲	66101-2	66100-7	66100-7
▲	▲	66101-1	66100-6	66100-6
STANDARD	▲	66101-4	66100-4	66100-4
STANDARD	▲	66101-3	66100-3	66100-3
STANDARD	▲	66101-2	66100-2	66100-2
STANDARD	▲	66101-1	66100-1	66100-1

THIS DRAWING IS A CONTROLLED DOCUMENT. DW V. FURLER 11JUL03

DR G. STEINHAUER 11JUL03

DR G. STEINHAUER 11JUL03

NAME: SOCKET ASSEMBLY, .062, TYPE III+

APPLICATION SPEC: -

SIZE: A2

DATE: 00779

SCALE: 8:1

SHEET: 1 of 1

REV: AK2