

ALL RIGHTS RESERVED. NO PORTION OF THIS PUBLICATION, WHETHER IN WHOLE OR IN PART CAN BE REPRODUCED WITHOUT THE EXPRESS WRITTEN CONSENT OF SPC TECHNOLOGY.

REVISIONS			DOC. NO.	SPC-F005	* Effective:	12/21/98	* DCP No:	880
DCP #	REV	DESCRIPTION	DRAWN	DATE	CHECKD	DATE	APPRVD	DATE
	A	Redrawn In Autocad	JAP	12/2/91				
963	B	Added Bulk items: was CBS-ZO-****	JWM	3/20/01	JC	3/21/01	JC	3/21/01

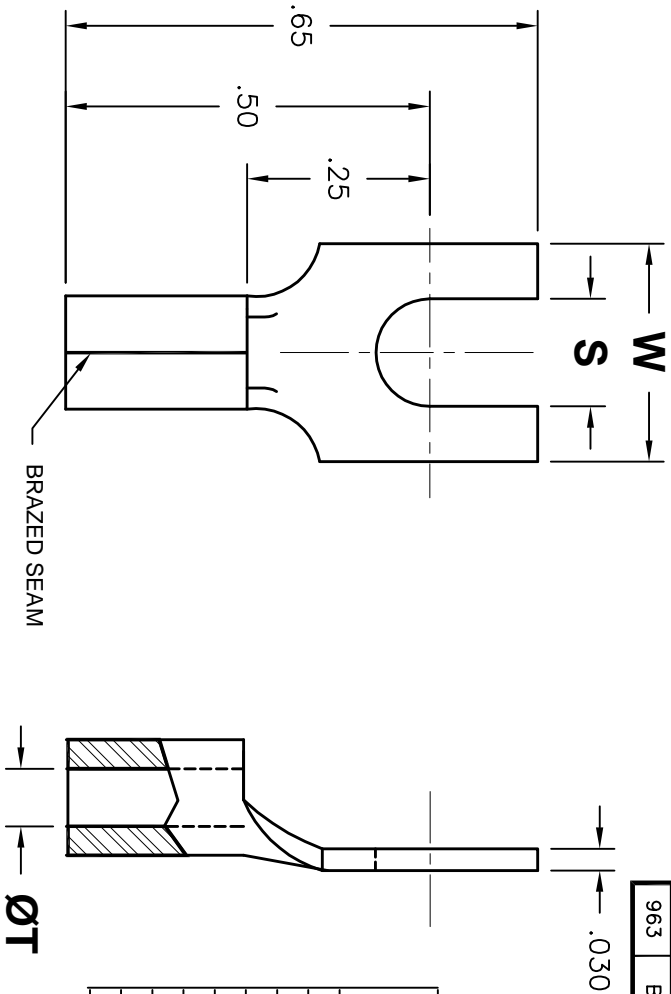

SPC Type No.	Wire Size (AWG)	Stud Size	W	S	T	Pkg. QTY
CBS-ZO-1406	16 ~ 14	#6 (.138)		.148		100
SPC3665	16 ~ 14	#6 (.138)		.148		1000
CBS-ZO-1408	16 ~ 14	#8 (.164)	.30	.174	.090	100
SPC3666	16 ~ 14	#8 (.164)		.174		1000
CBS-ZO-1806	22 ~ 18	#6 (.138)	.25	.148		100
SPC3663	22 ~ 18	#6 (.138)	.25	.148		1000
CBS-ZO-1808	22 ~ 18	#8 (.164)	.30	.174	.070	100
SPC3664	22 ~ 18	#8 (.164)	.30	.174		1000

- NOTES:**
1. MAXIMUM CURRENT: SAME AS WIRE
  2. TEMPERATURE RANGE: 175 °C/347 °F MAX.
  3. STRIP AWAY THE END 3/4 INCHES OF WIRE INSULATION
  4. TERMINAL MATERIAL: ETP COPPER
  5. TERMINAL PLATING: TIN
  6. UL LISTED AND CSA CERTIFIED FOR USE ON STRANDED COPPER (AWG) WIRE ONLY

**DISCLAIMER:**  
 ALL STATEMENTS AND TECHNICAL INFORMATION CONTAINED HEREIN ARE BASED UPON INFORMATION AND/OR TESTS WE BELIEVE TO BE ACCURATE AND RELIABLE SINCE CONDITIONS OF USE ARE BEYOND OUR CONTROL. THE USER SHALL DETERMINE THE NUMBER OF THE PRODUCTION FOR THE INTENDED USE AND ASSUME ALL RISK AND LIABILITY WHATSOEVER IN CONNECTION THEREWITH.



ES8918  
 LR82190M6  
 OSHA  
 Acceptable  
 SPC-F005.DWG

Tolerances Unless Otherwise Specified	DRAWN BY:	DATE:
Decimals	JC	3/7/91
.X ± 0.015	CHECKED BY:	DATE:
.XX ± 0.010	JC	11/27/91
.XXX ± 0.005	APPROVED BY:	DATE:
	JL	12/2/91

DRAWING TITLE:			NON-INSULATED BLOCK SPADE TERMINAL		
SIZE	DWG. NO.	ELECTRONIC FILE		REV	
A	TA-315	TA-315.DWG		B	
SCALE:	NTS	U.O.M.:	Inches	SHEET:	1 OF 1

