

75018

NOTES:

- 1) MATERIALS:
HOUSING - LIQUID CRYSTAL POLYMER, UL94 V-0
WAFFER DIELECTRIC - LIQUID CRYSTAL POLYMER, UL94 V-0
CONTACT - TIN-BRASS
- 2) FINISHES:
CONTACT INTERFACE
0.76 MICRON MIN. SELECT GOLD
1.27 MICRON MIN. NICKEL OVERALL
COMPLIANT INTERFACE
0.76 MICRON MIN. SELECT TIN/LEAD OVER
1.27 MICRON MIN. NICKEL OVERALL
HOUSING
0.10 MICRON MAX. IMMERSION GOLD OVER
3.81 MICRON MIN. NICKEL OVER
3.81 MICRON MIN. COPPER OVERALL
- 3) PRODUCT SPECIFICATION
THIS PART CONFORMS TO MOLEX SPECIFICATION PS-75018-001.
- 4) PACKAGING SPECIFICATION
THIS PART TO BE PACKAGED PER SPECIFICATION PK-75020-010.
- 5) APPLICATION SPECIFICATION
THIS PART TO BE APPLIED PER SPECIFICATION AS-75018-001.
APPLICATION TOOL AND INSTRUCTIONS PER AS-75018-001.
- 6) MATING INFORMATION
THIS PART MATES WITH 75019-XXXX.
WILL MATE WITH MAXIMUM 1.27mm MIS-ALIGNMENT.
WILL MATE WITH MAXIMUM 0.5° MIS-ALIGNMENT.
- 7) FOR CIRCUIT DESIGNATION SEE SHEET 3
- 8) FOR PCB INFORMATION SEE SHEET 3
- 9) CIRCUITS IN THIS ZONE HAVE BEEN OMITTED TO SIMPLIFY THE MODEL. ACTUAL PRODUCT IS FULLY LOADED WITH TERMINALS.
- 10) APPLICATION TOOLING KEEP OUT AREA.
NO COMPONENTS ALLOWED IN THIS AREA.
- 11) CONFORMS TO MOLEX COSMETIC SPECIFICATION PS-75005-001.
- 12) MARKING: PART NUMBER, MOLEX LOGO, DATE CODE
- 13) RECOMMENDED DRILL SIZE 0.66±0.03 TO
YIELD FINISHED PLATED THROUGH HOLE OF 0.55±0.05

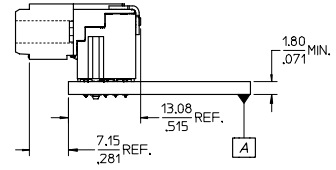
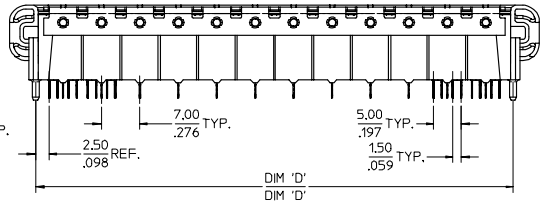
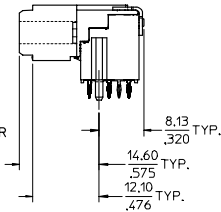
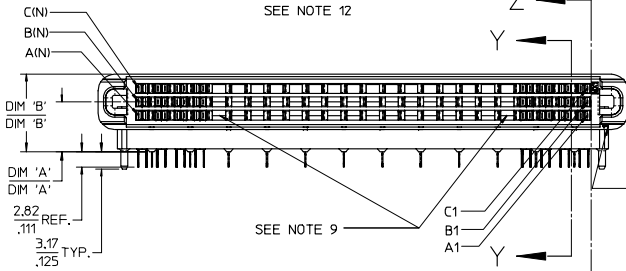
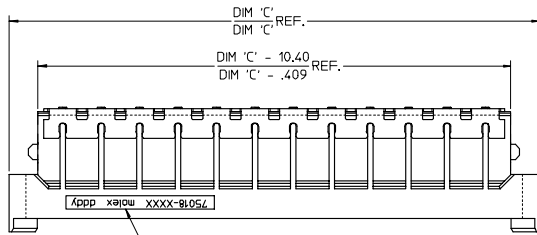
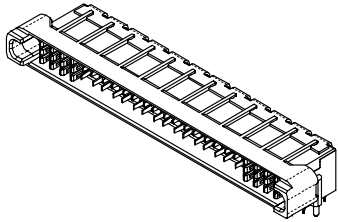

EC NO: UCP2004-1217 DRW/KLANG 2004/02/02 CHKD: CHKD 2004/02/03 APPR: MBANAKIS004/02/05	QUALITY SYMBOLS	GENERAL TOLERANCES (UNLESS SPECIFIED)		SCALE 2:1	DESIGN UNITS METRIC	THIRD ANGLE PROJECTION	REVISE ON CAD ONLY
	▽.0	4 PLACES ±.005	3 PLACES ±.01	DIMENSION STYLE MM/IN		TITLE HIGH SPEED DOCKING FIXED CONNECTOR	
	▽.0	2 PLACES ±0.13	1 PLACE ±0.25	DRAWN BY LANG	DATE 02-NOV-25	MATERIAL NO. MOLEX INCORPORATED	
	▽.0	ANGULAR ±1/2°		CHECKED BY LANG	DATE 02-NOV-26	DOCUMENT NO. SD-75018-010	SHEET NO. 1 OF 3
REV A	DRAFT WHERE APPLICABLE		APPROVED BY BANAKIS		DATE 02-NOV-26	THIS DRAWING CONTAINS INFORMATION THAT IS PROPRIETARY TO MOLEX INCORPORATED AND SHOULD NOT BE USED WITHOUT WRITTEN PERMISSION	

12 | 11 | 10 | 9 | 8 | 7 | 6 | 5 | 4 | 3 | 2 | 75018

ITEM NUMBER	CIRCUT SIZE	NO. OF COLUMNS 'N'	CENTERLINE DIMENSION 'A' mm(in)	O/A HEIGHT DIMENSION 'B' mm(in)	O/A LENGTH DIMENSION 'C' mm(in)	PEG TO PEG DIMENSION 'D' mm(in)	FIRST-LAST DIMENSION 'E' mm(in)
NOT TOOLED	144	48	4.74 (.187)	9.78 (.385)	96.50 (3.799)	87.00 (3.425)	82.00 (3.228)
NOT TOOLED	144	48	5.74 (.226)	10.78 (.424)	96.50 (3.799)	87.00 (3.425)	82.00 (3.228)
NOT TOOLED	144	48	8.74 (.344)	13.78 (.543)	96.50 (3.799)	87.00 (3.425)	82.00 (3.228)
NOT TOOLED	132	44	4.74 (.187)	9.78 (.385)	89.50 (3.524)	80.00 (3.150)	75.00 (2.953)
NOT TOOLED	120	40	4.74 (.187)	9.78 (.385)	82.50 (3.248)	73.00 (2.874)	68.00 (2.677)
NOT TOOLED	108	36	4.74 (.187)	9.78 (.385)	75.50 (2.972)	66.00 (2.598)	61.00 (2.402)
75018-0014	108	36	5.74 (.226)	10.78 (.424)	75.50 (2.972)	66.00 (2.598)	61.00 (2.402)
NOT TOOLED	108	36	8.74 (.344)	13.78 (.543)	75.50 (2.972)	66.00 (2.598)	61.00 (2.402)
NOT TOOLED	96	32	4.74 (.187)	9.78 (.385)	68.50 (2.697)	59.00 (2.323)	54.00 (2.126)
NOT TOOLED	84	28	4.74 (.187)	9.78 (.385)	61.50 (2.421)	52.00 (2.047)	47.00 (1.850)
NOT TOOLED	72	24	4.74 (.187)	9.78 (.385)	54.50 (2.146)	45.00 (1.772)	40.00 (1.575)
NOT TOOLED	60	20	4.74 (.187)	9.78 (.385)	47.50 (1.870)	38.00 (1.496)	33.00 (1.299)
NOT TOOLED	48	16	4.74 (.187)	9.78 (.385)	40.50 (1.594)	31.00 (1.220)	26.00 (1.024)
NOT TOOLED	36	12	4.74 (.187)	9.78 (.385)	33.50 (1.319)	24.00 (0.945)	19.00 (0.748)

EC NO: UCP2004-1217 DRW/KLANG 2004/02/02 CHKD: 2004/02/03 APPR: MBANAKIS/04/02/05	QUALITY SYMBOLS ▽ 0 ▽ 0	GENERAL TOLERANCES (UNLESS SPECIFIED)		SCALE 1:1	DESIGN UNITS METRIC	THIRD ANGLE PROJECTION	REVISE ON CAD ONLY	
		mm	INCH	DIMENSION STYLE				TITLE
A REV	DESCRIPTION	4 PLACES ± --- ± ---	3 PLACES ± --- ± .005	DRAWN BY LANG	DATE 02-NOV-25	HIGH SPEED DOCKING FIXED CONNECTOR		
		2 PLACES ± 0.13 ± .01	1 PLACE ± 0.25 ± ---	CHECKED BY LANG	DATE 02-NOV-26	MOLEX INCORPORATED		
		ANGULAR ± 1/2°		APPROVED BY BANAKIS		DATE 02-NOV-26	MATERIAL NO. SEE CHART	DOCUMENT NO. SD-75018-010
		DRAFT WHERE APPLICABLE MUST REMAIN WITHIN DIMENSIONS		THIS DRAWING CONTAINS INFORMATION THAT IS PROPRIETARY TO MOLEX INCORPORATED AND SHOULD NOT BE USED WITHOUT WRITTEN PERMISSION		SHEET NO. 2 OF 3		

fp_frame_C-81 rev. B1 2000/08/01

11 | 10 | 9 | 8 | 7 | 6 | 5 | 4 | 3 | 2 | 1

12 11 10 9 8 7 6 5 4 3 2

J
I
H
G
F
E
D
C
B
A

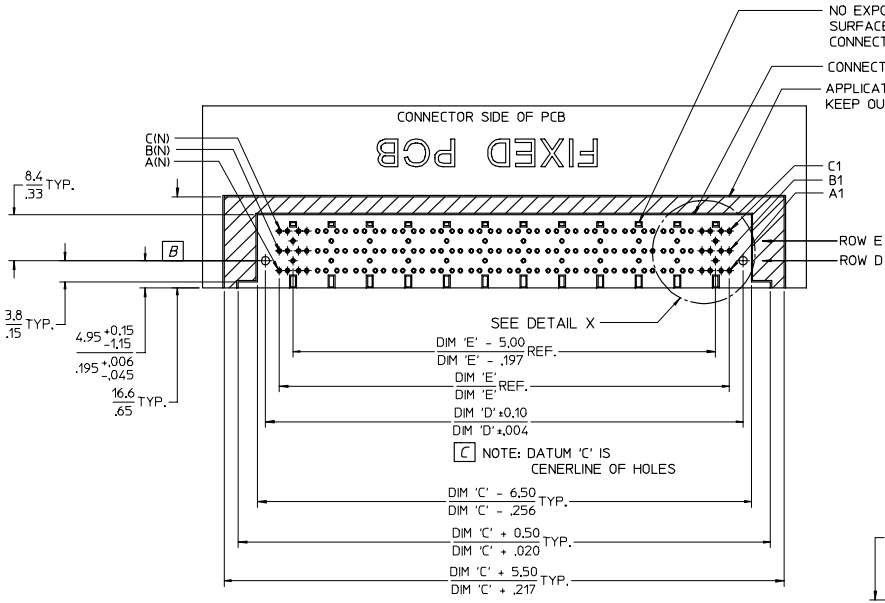

NO EXPOSED TRACES ON SURFACE OF PCB IN CONNECTOR STAND OFF LOCATIONS
CONNECTOR KEEP OUT AREA
APPLICATION TOOLING KEEP OUT AREA (NOTES 5 & 10)

CIRCUIT DESIGNATION
FIRST MATE: HOUSING - SIGNAL GROUND
SECOND MATE: A1, C1, A(N), C(N) (FOR POWER RETURN)
THIRD MATE: A2, B2, C2, AIN-1, BIN-1, CIN-1 & ALL OTHERS (A2, C2, AIN-1 & CIN-1 FOR POWER) (ALL OTHERS SIGNAL)
LAST MATE: B1, B(N) (FOR CARD DETECT)
ALL COLUMNS FROM 3 THROUGH (N-2) ARE SUITABLE FOR DIFFERENTIAL PAIRS
EG: A3-A4, B3-B4, C3-C4, AIN-2-AIN-3, BIN-2-BIN-3
SIGNAL GROUND: ROWS D & E

NOMINAL WIPE - FULL SEATED

FIRST MATE: 5.2mm
SECOND MATE: 2.7mm
THIRD MATE: 2.2mm
LAST MATE: 1.7mm

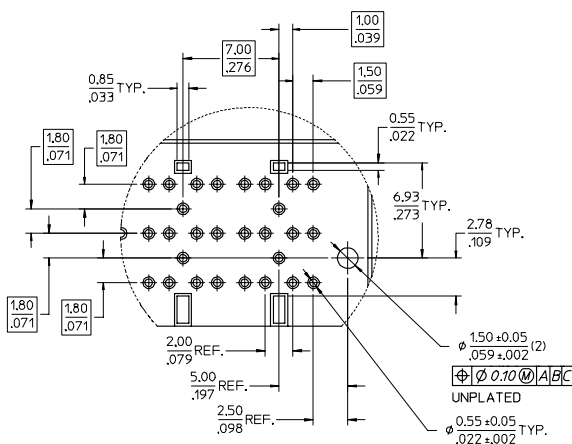
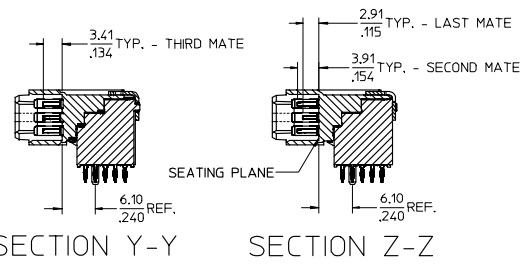

DETAIL X
SCALE 5:1

EC NO: UCP2004-1217 DRAWN BY: DRINKLANG 2004/02/03 CHKD: CHFKD 2004/02/03 APPR: MBANAKIS2004/02/05	QUALITY SYMBOLS ▽-0 ▽-0	GENERAL TOLERANCES (UNLESS SPECIFIED)		SCALE 2:1	DESIGN UNITS METRIC	THIRD ANGLE PROJECTION	REVISE ON CAD ONLY
		4 PLACES ± --- ± ---	3 PLACES ± --- ± .005	2 PLACES ± 0.13 ± .01	1 PLACE ± 0.25 ± ---	MM/IN	DATE 02-NOV-25
A	DESCRIPTION	ANGULAR ±1/2°		DRAWN BY LANG	DATE 02-NOV-25	MATERIAL NO. SEE SHEET 2	
		DRAFT WHERE APPLICABLE		APPROVED BY BANAKIS	DATE 02-NOV-26	DOCUMENT NO. SD-75018-010	SHEET NO. 3 OF 3
MUST REMAIN WITHIN DIMENSIONS		THIS DRAWING CONTAINS INFORMATION THAT IS PROPRIETARY TO MOLEX INCORPORATED AND SHOULD NOT BE USED WITHOUT WRITTEN PERMISSION					

11 10 9 8 7 6 5 4 3 2 1

J
I
H
G
F
E
D
C
B
A