



## Plug-in Screw Connector System for Printed Circuit Boards

### TYPE 931-SLS

3.5 mm spacing - 2 to 16 poles



[Distributor Stock Check](#)

<a href="#">Series</a>	<a href="#">Download PDF</a>	<a href="#">3D Model</a>	<a href="#">Can plug with</a>	<a href="#">How to order</a>	<a href="#">Color specifications</a>	<a href="#">Print</a>
------------------------	------------------------------	--------------------------	-------------------------------	------------------------------	--------------------------------------	-----------------------



931-SLS



One possible variation of assembly



RoHS WEEE Pb free compliant

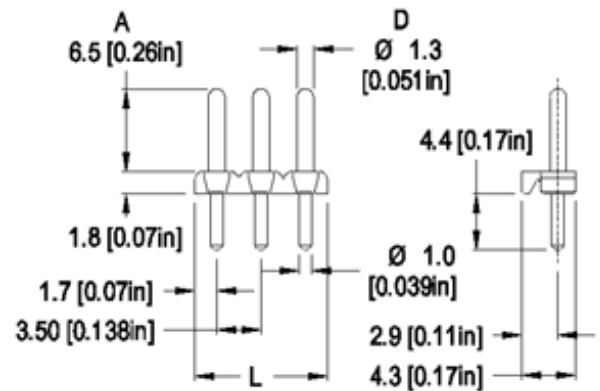

Dimensions: mm (in.)

Length of Pinstrip (L)

L = No. of Poles x Center to Center Spacing

Other options:

In Ø1.10 mm diameter (D), the following protruding lengths (A) are available: 7.8, 10.3, 11.0, 11.7, 11.9, 12.5, 14.2, 14.7 and 15.7 mm.  
In Ø1.30 mm diameter (D), the following protruding lengths (A) are available: 6.5, 7.2, 7.7, 7.8, 8.5, 10.5, 11.0, 16.5, 19.8, 21.5, 22.0 and 29.0 mm.

**When locating connector, allow 0.5 mm clearance around it for process-induced variations.**

### Description

- Pinstrip
- Plug-In Direction Perpendicular to PCB and Wire Entrance Parallel to PCB when plugged with **930-FL (-DS)**, **938-FL (-DS)**

### Technical Data

**Center to Center Spacing:** 3.5 mm (0.138 in.)  
**Recommended Hole Diameter in PC Board:**  
1.3 mm (0.051 in.) for 1.0 mm (0.039 in.) pin (standard)  
1.4 mm (0.055 in.) for 1.1 mm (0.043 in.) pin (limited options)  
1.6 mm (0.063 in.) for 1.3 mm (0.051 in.) pin (limited options)

### Approval Information

UL File No. E69841   
CSA File No. LR24322

Rating	Current(A)	Voltage(V)	Application group	AWG
UL	6	300	B	
CSA	6	300	B	

### Material

## Application

This can be plugged with the 930-FL (-DS) or 938-FL (-DS). Entry of the pin can be on top side or on the bottom of these plugs. You can stack the plug on top of each other when used with extra long pins on the 931-SLS strips. You can choose your pin length depending on the insertion forces or extraction forces required.

**Molding:** PBT GF (glass fiber reinforced), self extinguishing UL 94, V-0, color black

**Temperature limits:**

**Short Time:** 200°C (392°F)

**Continuous:** RTI 105°C (221°F)

**Low Limit:** -40°C (-40°F)

**Comparative Tracking Index:** CTI > 175

**Oxygen Index Rating:** 32%

**Solder Pin:** Solder side: Ø 1 mm (0.039 in.) or Ø1.1 (0.043 in.), plug-in side: Ø1.1 mm (0.043 in.) and Ø 1.3 mm (0.051 in.), Tin plated copper alloy

 [Top of page](#)

## How to order

**Item** 931-SLS

### Options

G05: Gold Plating (5 micro inches)  
G30: Gold Plating (30 micro inches)  
S30: Silver Plating (30 micro inches)  
10.5: Pin length 10.5 mm (0.413 in.)  
16.5: Pin length 16.5 mm (0.649 in.)  
19.8: Pin length 19.8 mm (0.779 in.)

**Note:** Plated component: solder pin

**Ordering Note:** To order alternate pin lengths and diameters please download the PDF file above.

931-SLS/

POLES:  
02 to 16

[Request sample](#)

[Request quote](#)

Quantity

### Accessories

[Add to shopping cart](#)