

- Back**
- o PushPull Power
 - o Flat Cable Connectors SEK
 - o *har-mik®*
 - o D-Sub
 - o InduCom

● **Applications**

Product details

09 02 264 6824 **Backplane connector**

Type	Type B
Standard/Inverse	Standard
Contact gender	Female contacts
Size	Whole size
Number of contacts	64 poles
Contact arrangement	Rows a and b
Termination	Straight solder pins
Termination length	2,9 mm
Performance Class	Performance level 2 as per IEC 60603-2
Contacts	with contacts
Board fixing	Without fixing
Coding facility	without coding facility
Current	2 A max.
Clearance/ Creepage	1.2 / 1.2 mm min.
RoHS compliant	Yes

Inquiry

Alle Rechte vorbehalten. All rights reserved.

X
Kontaktanordnung
Contact arrangement

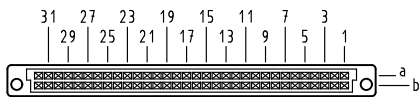

64 Einlöt-Kontakte
64 solder-contacts

- ⊠ = Einlöt-Kontakt
= solder-contact
- = Kontaktposition nicht belegt
= position without contact

X
(Lochbild)
(Board drillings)

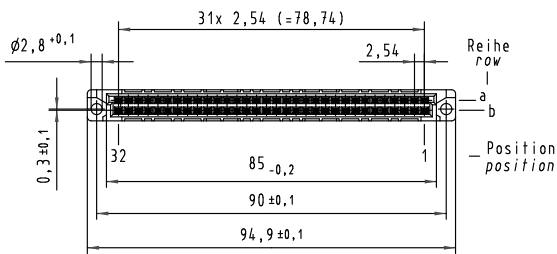
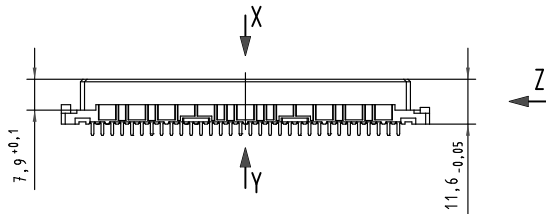
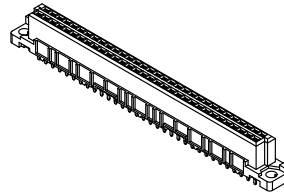
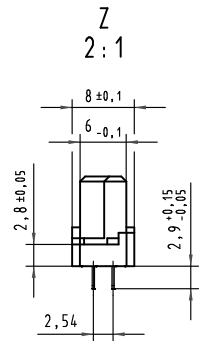
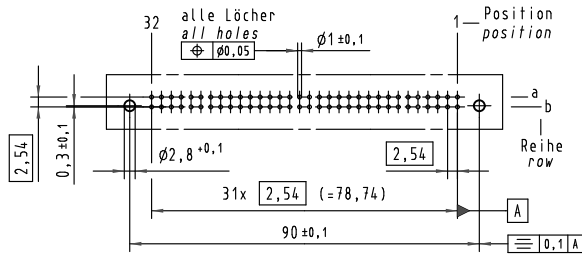

Y
10:1
Querschnitt der Lötanschlüsse:
cross-section of solder terminations:

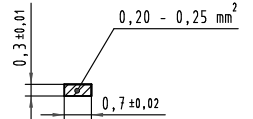

-	-	-
09 02 264 6824	2	Au über/over Ni
09 02 264 2824	1	Au über/over Ni
Bestell-Nr. part-no.	Anforderungsstufe nach IEC performance level acc. to IEC	Kontaktoberfläche contact plating

All Dimensions in mm Original Size DIN A 3				Techn. Character.		Nicht tolerierte Maß/Free size tolerances IEC 60603-2	
Mod.	Dat.	Name	Detail.	Inspr.	Maßstab/Scale	har-bus B Federleiste Einlöt 2,9 , 64 pol. har-bus B female connector solder 2,9 , 64 pol.	
34306	02.07.07	LehT	12.10.99	Rie.	1:1 2:1		
30231	08.02.02	Rie.	12.10.99	Pa.			
26962	24.01.00	Rie.	HARTING Electronics GmbH & Co. KG		TB 09 02 264 x824	Blatt/page	
26091			D-32339 ESPELKAMP				
						Sub.	